

OPTIGAS 5050 C / 5010 C

Mass flowmeter for Compressed Natural Gas (CNG) and Liquefied Petroleum Gas (LPG) Dispensers



- **Two sizes**
S 15 (50 kg/min / 110 lbs/min) or
S 25 (120 kg/min / 265 lbs/min)
- **Signal converter (transmitter)**
or **MODBUS Direct Data**
Communication (DDC) outputs
- **High accuracy and wide**
measuring range
- **Compact and low cost**
- **Easy to install and commission**
- **Developed in conjunction with**
dispenser manufacturers

OPTIGAS 5050 C / 5010 C Massflow meter for CNG and LPG Dispensers

Technical data

Application conditions

Fluid	Compressed Natural Gas (Methane) or Liquefied Petroleum Gas (Propane & Butane)
Flow range capacity	1...50 kg/min / 2.2...120 lbs/min (S 15) or 2.4...120 kg/min / 5...265 lbs/min (S 25)
Accuracy	± 0.5% of total batch; where minimum actual flow rate is 1 kg/min / 2.2 lbs/min (S 15) or 2.4 kg/min / 5 lbs/min (S 25)
Repeatability	±0.3% of actual flow rate + zero stability (for a typical batch size of >10 kg/22 lbs)
Zero stability	±0.015% of flow range capacity
Pressure rating	350 barg / 5080 psig (static), 300 barg / 4350 psig (cyclic)
Process fluid temperature	-40... +93°C / -40...+200°F
Ambient temperature	-40...+55°C / -40 ... +130°F (compact converter / integral transmitter) or -40 ... +60°C / -40 ... +140°F (remote converter / field mount transmitter)

Mechanical data

Process connections	3/4" (S 15) or 1" (S 25) NPT female thread in body block
Tube material	Stainless Steel 1.4404 / 316L
Body casting material	Stainless Steel 1.4401 / 316L
Outer case	Stainless Steel 1.4301 / 304L
Converter housing	Epoxy coated aluminium
Mounting	Integral lugs from bottom of case 4 x 11 mm / 7/16" at 220 x 50 mm / 8.7 x 2" centres

Dimensions and weights 5050 C / 5010 C

Weight	approx. 13 kg / 29 lbs (5050 C S 15) approx. 8.5 kg / 19 lbs (5010 C S 15)
--------	---

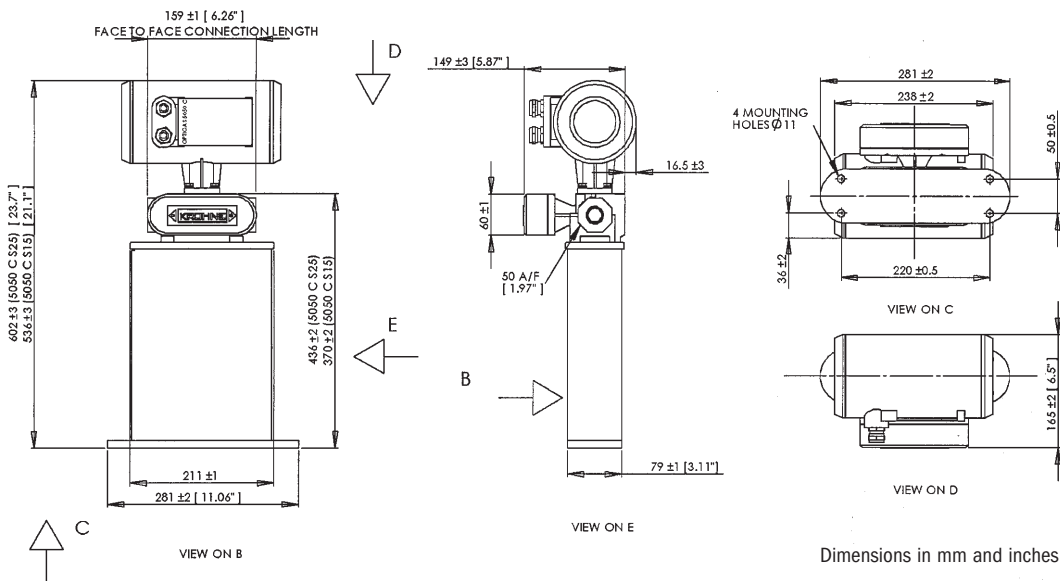

Dimensions in mm and inches

Note: Both meters have the same external dimensions and mounting hole positions.

Model 5050 C, S 15 (50 kg/min / 110 lbs/min flow) has 3/4" connections.
Model 5050 C, S 25 (120 kg/min / 265 lbs/min flow) has 1" connections.

Model 5010 C S XX with DDC Modbus output – use height dimension for sensor body only excluding converter

Electrical (5050 C)

Power supply	100 ... 120 or 200 ... 230 v ac or 24 V DC (specify at time of order)
Display	2 line; 10 character LCD
Functions shown in display	Choice of: mass flow, mass total, referred volume flow, referred volume total, temperature or diagnostics
Programming	3 user keys or via magnetic switches
Outputs (software assigned to any measurement function)	Single or dual phase pulse (1 KHz) and 4...20 mA with HART
Input	Binary control input (e.g. for zero calibration or totaliser reset)
Converter mount	Integral onto sensor or remote via 4 core cable

Electrical (5010 C)

Power supply	12 V DC via Ex approved barrier
Programming	Via Modbus
Outputs (called from register of any measurement function)	MODBUS via Ex approved barrier

Diagnostics (5050 C & 5010 C)

Functions	Operational measurement and service
-----------	-------------------------------------

Approvals

Hazardous area	ATEX Zone 1 T1...T4 FM Class I Div 1 (pending)
Custody transfer	PTB Germany NTEP USA (pending)

United Kingdom

KROHNE Ltd.
Rutherford Drive
Park Farm Industrial Estate
Wellingborough,
Northants NN8 6AE, UK
TEL.: +44(0)19 33-408 500
FAX: +44(0)19 33-408 501
e-mail: info@krohne.co.uk

USA

KROHNE Inc.
7 Dearborn Road
Peabody, MA 01960
TEL.: +1-978 535-6060
FAX: +1-978 535-1720
e-mail: info@krohne.com

Other countries

KROHNE Messtechnik
GmbH & Co. KG
Ludwig-Krohne-Str.
D-47058 Duisburg
TEL.: +49(0)203-301-0
FAX: +49(0)203-301-389
e-mail: info@krohne.de

www.krohne.com

KROHNE