

Solenoid valves VUVB

FESTO

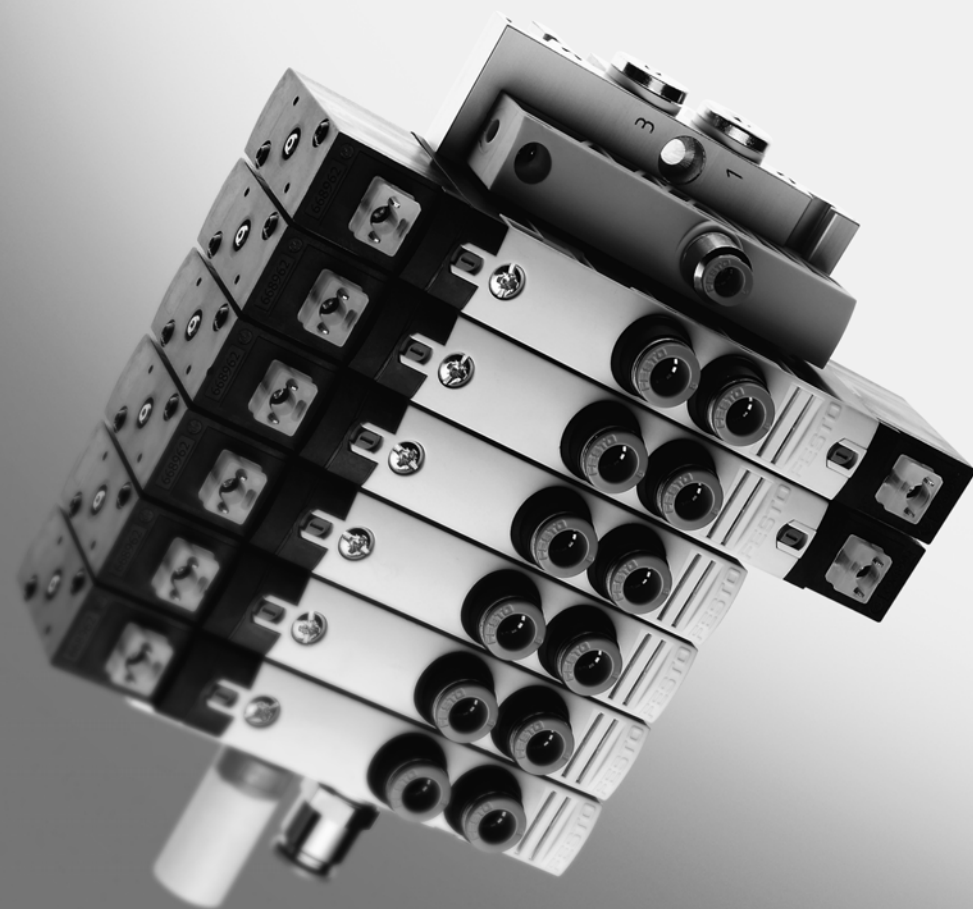

- Electrically actuated valves
- With internal or external pilot air
- Sturdy polymer valves on a stable aluminium manifold rail
- Individual or manifold mounting
- Suitable for vacuum
- Valve manifold with pressure zone separation
- Additional power supply for high performance

Solenoid valves VUVB

Key features

Pilot air supply module

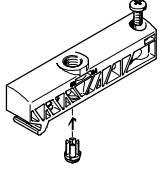

The pilot air supply module is included in the scope of delivery of the manifold rail.
If the selector is inserted as shown, it

means that the valve manifold is set to external pilot air supply.
If the selector is turned 180° before

insertion, it means that the pilot air supply will be branched internally from channel 1.

Manifold rail

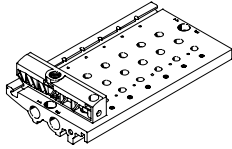

The manifold rail features a groove into which the semi in-line valves are latched and secured with just one screw.
The valve functions 4/2-way single solenoid, 4/2-way double solenoid, 3/2-way normally closed and

3/2-way normally open are available. All semi in-line valves can be supplied with cartridges QSP for tubing diameters 4, 6, 8 and 10.

4/2-way valves are also supplied without cartridges, allowing the user to fit cartridges of their choice or blanking plugs.

Pressure zone supply module

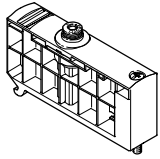

The pressure zone supply module occupies one valve position and can

be used as an additional supply or for supplying a pressure zone.

Individual valve

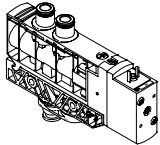

The individual valve can be ordered as an in-line valve (semi in-line valve and sub-base ready assembled) in all functions. Tubing diameters 6 and 8 can be selected here.

The in-line valve, however, can also be individually assembled from a sub-base and a semi in-line valve. All tubing diameters and the variant

without cartridge are available in this case.

Solenoid valves VUVB

Key features

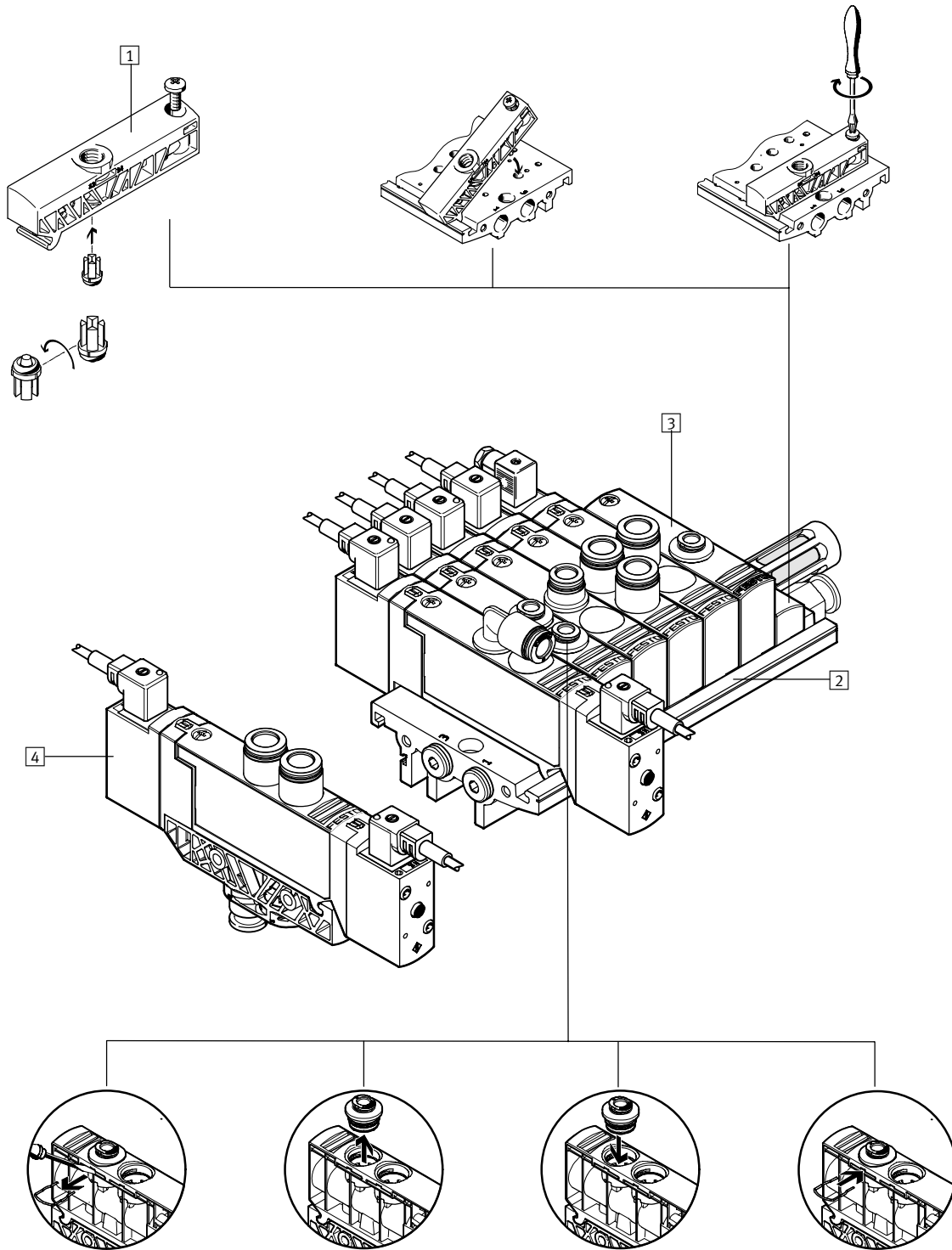

1 Pilot air supply module

2 Manifold rail

3 Pressure zone supply module

4 Individual valve

Solenoid valves VUVB

Product range overview

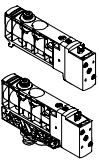
Function	Version	Type	Nominal flow rate [l/min]	Pneumatic connection	Operating voltage [V DC]	Semi in-line valve	In-line valve	Pilot air supply	
								internal	external
3/2-way valves	Single solenoid valve								
		VUVB-...-M32-...	200	QS-4	24	■	-	■	■
			500	QS-6		■	■	■	■
			800	QS-8		■	■	■	■
			1000	QS-10		■	-	■	■

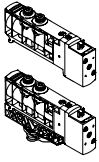
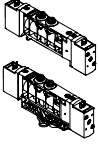
Function	Version	Type	Nominal flow rate [l/min]	Pneumatic connection	Operating voltage [V DC]	Semi in-line valve	In-line valve	Pilot air supply	
								internal	external
4/2-way valves	Single solenoid valve								
		VUVB-...-M42-...	200	QS-4	24	■	-	■	■
			500	QS-6		■	■	■	■
			800	QS-8		■	■	■	■
			1000	QS-10		■	-	■	■
	Double solenoid valve								
		VUVB-...-B42-...	200	QS-4	24	■	-	■	■
			500	QS-6		■	■	■	■
			800	QS-8		■	■	■	■
1000			QS-10	■		-	■	■	

Solenoid valves VUVB

Product range overview

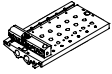
Function	Version	Type	Pneumatic connection	Valve positions						Pilot air supply	
				2	4	6	8	10	12	internal	external
Manifold rail	Valve manifold										
		VABM	G1/4, G1/2	■	■	■	■	■	■	■	■

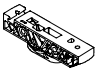
Function	Version	Type	Pilot air supply	
			internal	external
Sub-base	Individual valve			
		VABS	■	■

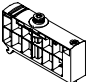
Function	Version	Type	Pneumatic connection	Application
Pressure zone supply module		VABF	QS-10	For additional supply to the manifold rail

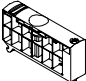
Function	Version	Type	Application
Blanking plate		VABB	For covering vacant locations

Function	Version	Type	Application
Sealing plug		VABD	For pressure zone separation

Function	Version	Type	Application
H-rail mounting		VAME	For mounting on the H-rail NRH-35-2000

Function	Version	Type
Cartridge fitting		QSP...

Solenoid valves VUVB

Type codes

VUVB - L - M32C - A Z D - Q6 - 1 C1

Valve family

VUVB	Single solenoid valve
------	-----------------------

Design

L	In-line valve
S	Semi in-line valve

Valve function

M32C	3/2-way valve, normally closed
M32U	3/2-way valve, normally open
M42	4/2-way valve, single solenoid
B42	4/2-way valve, double solenoid

Type of reset

	None (double solenoid)
A	Pneumatic reset

Pilot air supply

	Internal
Z	External

Manual override

D	Detenting
---	-----------

Pneumatic connection

Q4	For tubing O.D. 4 mm
Q6	For tubing O.D. 6 mm
Q8	For tubing O.D. 8 mm
Q10	For tubing O.D. 10 mm
X	Without push-in connector

Operating voltage

1	24 V DC
---	---------

Electrical connection

C1	Plug socket connection pattern to EN 175301-803, type C
----	---

Solenoid valves VUVB

Peripherals overview

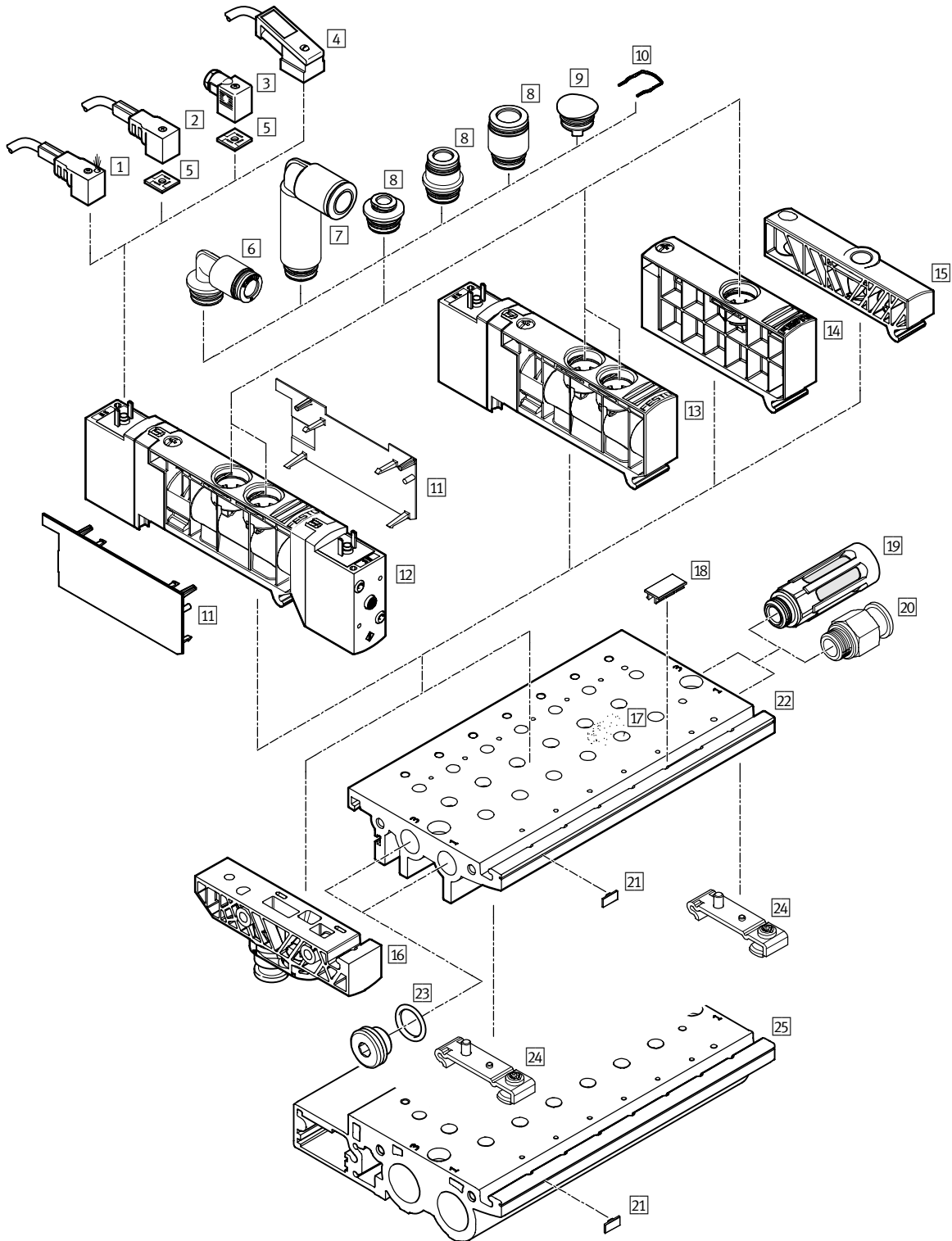



Solenoid valves VUVB

Peripherals overview

Accessories		
	Brief description	→ Page
1	Plug socket with cable with LED KMEB-1-...-LED	For indicating the switching status 2 / 2.7-24 www.festo.com
2	Plug socket with cable KMEB-1-230AC-...	Can be used up to 230 V 2 / 2.7-24
3	Plug socket MSSD-EB	– 2 / 2.7-24 www.festo.com
4	Plug socket with cable with LED KMEB-2-24-...	For indicating the switching status 2 / 2.7-24
5	Illuminating seal MEB-LD	For indicating the switching status 2 / 2.7-24
6	Cartridge, L-fitting QSPL	For connecting compressed air tubing with standard external diameters 2 / 2.7-22
7	Cartridge, long L-fitting QSPLL	For connecting compressed air tubing with standard external diameters 2 / 2.7-22
8	Cartridge, straight fitting QSP	For connecting compressed air tubing with standard external diameters 2 / 2.7-22
9	Blanking plug QSPC18	For sealing the pneumatic connections on the valve 2 / 2.7-22
10	Retaining clip	For fitting cartridges and blanking plugs (included in the scope of delivery of the cartridge QSP... and the blanking plug QSPC18) –
11	Cover for valve housing VAMC	– 2 / 2.7-19
12	Double solenoid valve VUVB-...-B	– 2 / 2.7-9
13	Single solenoid valve VUVB-...-M	– 2 / 2.7-9
14	Blanking plate/ pressure zone supply module VABB/VABF	Blanking plate VABB – with blanking plug Pressure zone supply module VABF – with cartridge 2 / 2.7-20
15	Pilot air supply module	For internal pilot air supply (included in the scope of delivery of the manifold rail VABM) –
16	Sub-base VABS	For connecting an individual valve 2 / 2.7-19
17	Sealing plug VABD	For pressure zone separation 2 / 2.7-21
18	Inscription label IBS-9x17	For identifying the manifold rail 2 / 2.7-23
19	Silencer U, UC	For fitting in exhaust ports 2 / 2.7-22
20	Push-in fitting QS	For connecting compressed air tubing with standard external diameters 2 / 2.7-17
21	Inscription label MH-BZ-80X	For identifying the valves 2 / 2.7-23
22	Manifold rail VABM-B6-E-G14	Pneumatic connection G $\frac{1}{4}$, for connecting max. 12 valves 2 / 2.7-17
23	Blanking plug B	For sealing unused ports 2 / 2.7-23
24	H-rail mounting VAME	For mounting on the H-rail NRH-35-2000 2 / 2.7-23
25	Manifold rail VABM-B6-E-G12	Pneumatic connection G $\frac{1}{2}$, for connecting max. 12 valves 2 / 2.7-18

Solenoid valves VUVB

Technical data

-  Flow rate
200 ... 1000 l/min
-  Voltage
24 V DC

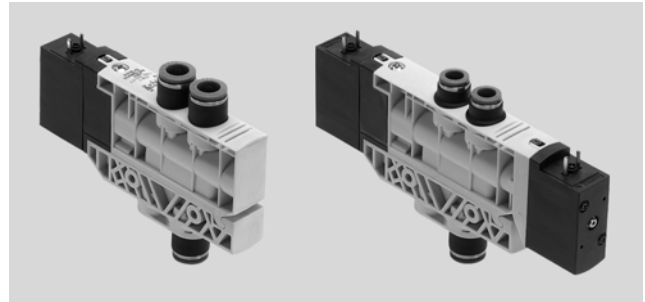

General technical data				
Valve function		3/2-way, single solenoid	4/2-way, single solenoid	4/2-way, double solenoid
Design	Piston spool			
Sealing principle	Soft			
Actuation mode	Electrical			
Type of reset	Pneumatic spring			-
Control mode	Piloted			
Pilot air supply	Internal or external			
Direction of flow	Non-reversible			
Exhaust function	No flow control			
Manual override	Non-detenting, detenting			
Type of mounting	Via through-holes			
Assembly position	Any			
Nominal size	[mm]	7		
Standard nominal flow rate	qnN	[l/min]	200 (QS-4), 500 (QS-6), 800 (QS-8), 1000 (QS-10)	
Grid dimension	[mm]	21		
Product weight	In-line valve	[g]	170	240
	Semi in-line valve	[g]	150	220

Operating and environmental conditions			
Operating medium	Dried and filtered compressed air, lubricated or unlubricated, grade of filtration 40µm, vacuum		
Operating pressure range	Internal pilot air supply	[bar]	2 ... 8
	External pilot air supply	[bar]	-0.9 ... +8
Pilot pressure range	[bar]	2 ... 8	
Ambient temperature	[°C]	-5 ... +50	
Temperature of medium	[°C]	-5 ... +50	
Corrosion resistance class CRC	1 ¹⁾		

- 1) Corrosion resistance class 1 according to Festo standard 940 070
Components requiring low corrosion resistance. Transport and storage protection. Parts that do not have primarily decorative surface requirements, e.g. in internal areas that are not visible or behind covers.

Electrical data	
Electrical connection	Plug, square design to EN 175301-803, type C
Nominal operating voltage	[V DC] 24
Permissible voltage fluctuation	±10%
Electrical power consumption	[W] 1.5
Protection class to EN 60 529	IP65 (in combination with plug socket)

Solenoid valves VUVB

Technical data

Valve response times [ms]			
Valve function	3/2-way, single solenoid	4/2-way, single solenoid	4/2-way, double solenoid
On	20	20	–
Off	20	20	–
Changeover	–	–	15

Materials

Sectional view – Single solenoid valve

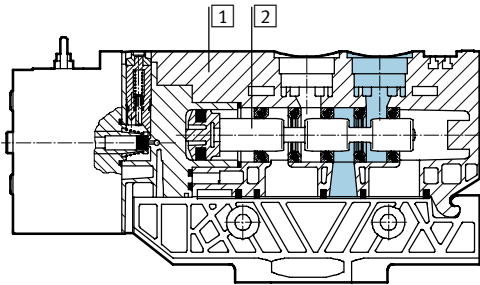

Sectional view – Double solenoid valve

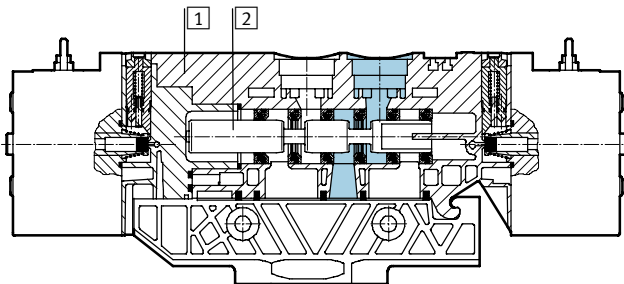

1	Housing	Polyamide, reinforced
2	Piston spool	Wrought aluminium alloy
–	Seals	Nitrile rubber, hydrogenated nitrile rubber, fluorocarbon rubber

Solenoid valves VUVB

Technical data

Dimensions – 3/2-way and 4/2-way valve, single solenoid

Download CAD data → www.festo.com/en/engineering

In-line valve

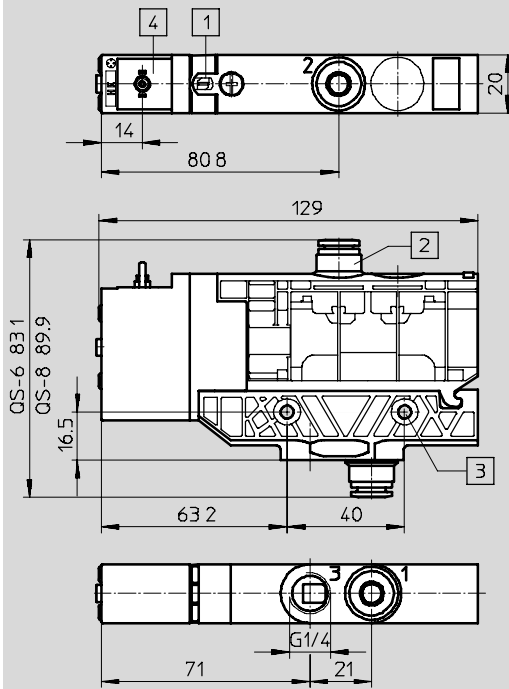

- 1 Manual override
- 2 Fitting QS-6 or QS-8
- 3 Through-hole for screw M4
- 4 Plug socket connection pattern to EN 175301-803, type C

Dimensions – 3/2-way and 4/2-way valve, single solenoid

Download CAD data → www.festo.com/en/engineering

Semi in-line valve

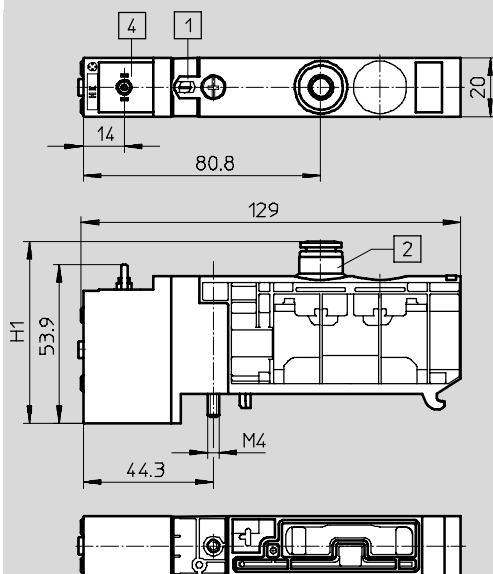

- 1 Manual override
- 2 Fitting QS
- 4 Plug socket connection pattern to EN 175301-803, type C

Pneumatic connection	H1
QS-4	57
QS-6	60
QS-8	63
QS-10	65

Solenoid valves VUVB

Technical data

Dimensions – 4/2-way valve, double solenoid

Download CAD data → www.festo.com/en/engineering

In-line valve

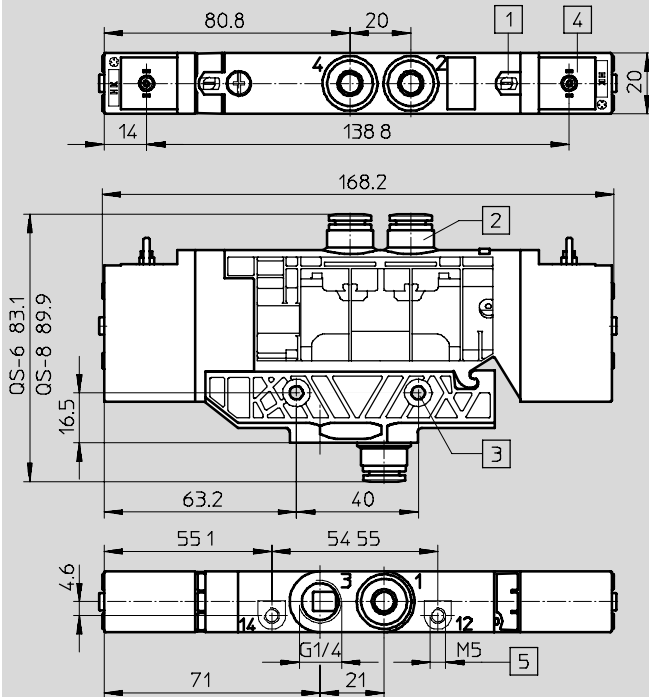

- 1 Manual override
- 2 Fitting QS-6 or QS-8
- 3 Through-hole for screw M4
- 4 Plug socket connection pattern to EN 175301-803, type C
- 5 Connection for external pilot air

Dimensions – 4/2-way valve, double solenoid

Download CAD data → www.festo.com/en/engineering

Semi in-line valve

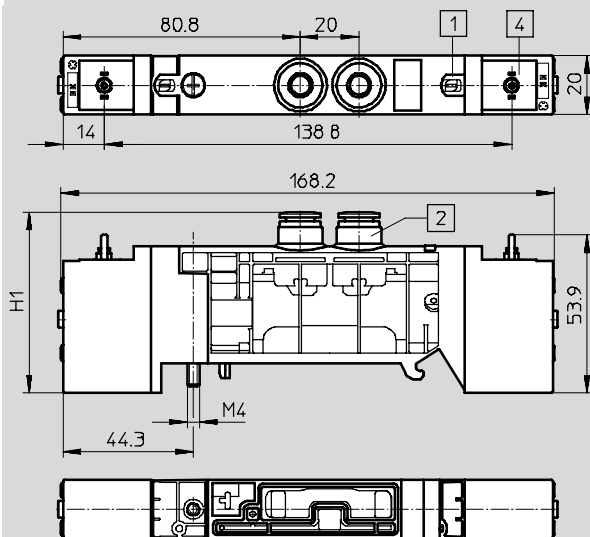

- 1 Manual override
- 2 Fitting QS
- 4 Plug socket connection pattern to EN 175301-803, type C

Pneumatic connection	H1
QS-4	57
QS-6	60
QS-8	63
QS-10	65

Solenoid valves VUVB

Technical data

Dimensions – Manifold assembly

Download CAD data → www.festo.com/en/engineering

Manifold rail G1/4

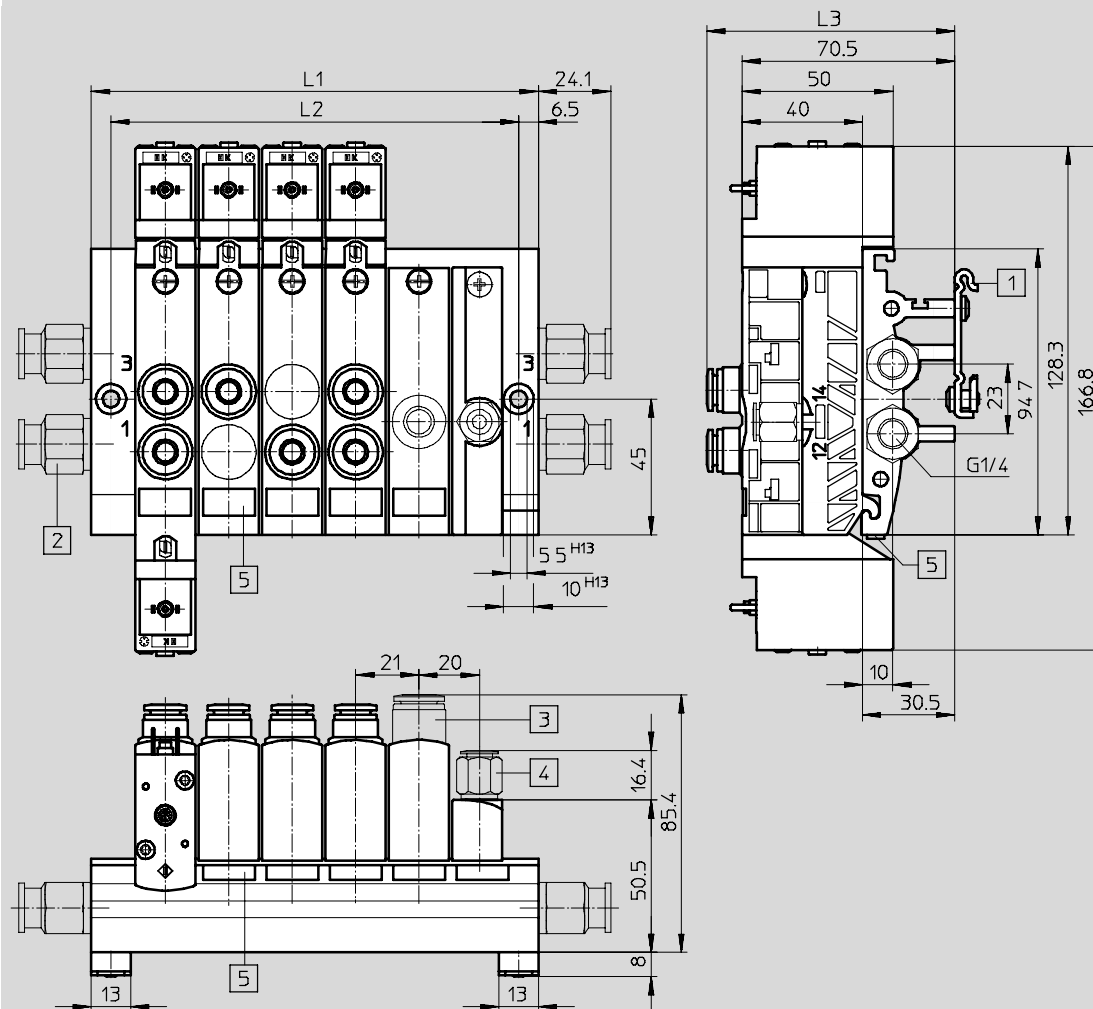

- 1 Attachment for mounting rail NRH-35-2000 (optional)
- 2 Push-in fittings (optional)
- 3 Cartridge fitting (optional, only with supply module)
- 4 Push-in fitting (optional, only with S types)
- 5 Incription label (optional)

Valve positions	L1	L2
2	85	72
4	127	114
6	169	156
8	211	198
10	253	240
12	295	282

Pneumatic connection	L3
QS-4	64.4
QS-6	64.4
QS-8	72
QS-10	75.4

Solenoid valves VUVB

Technical data

Dimensions – Manifold assembly

Download CAD data → www.festo.com/en/engineering

Manifold rail G1/2

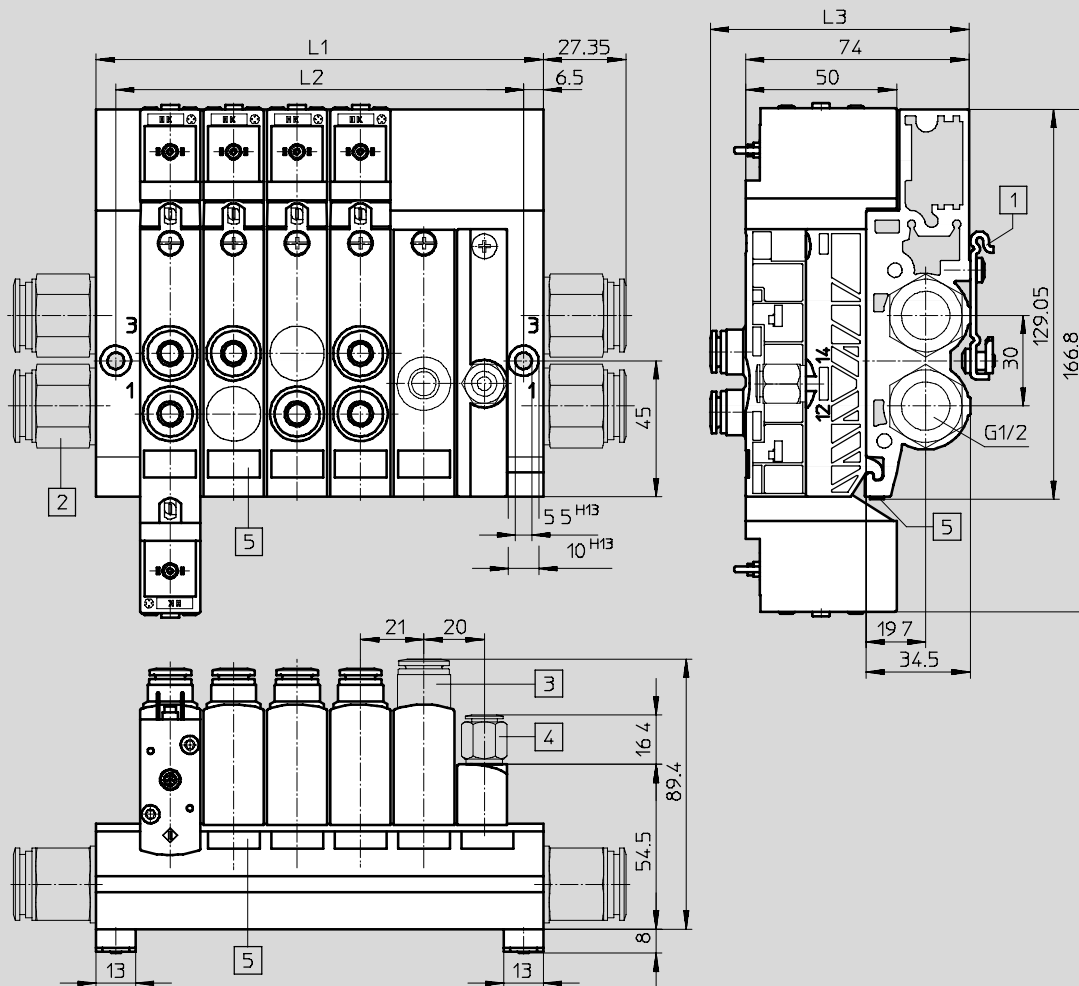

- 1 Attachment for mounting rail NRH-35-2000 (optional)
- 2 Push-in fittings (optional)
- 3 Cartridge fitting (optional, only with supply module)
- 4 Push-in fitting (optional, only with S types)
- 5 Inscription label (optional)

Valve positions	L1	L2
2	85	72
4	127	114
6	169	156
8	211	198
10	253	240
12	295	282

Pneumatic connection	L3
QS-4	78.5
QS-6	78.5
QS-8	86
QS-10	89.4

Directional control valves for standard applications
VUVB

2.7

Solenoid valves VUVB

Technical data

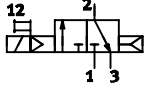
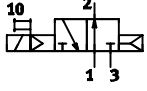
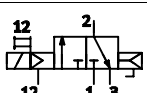
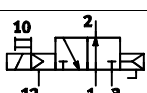
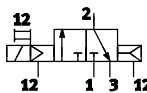
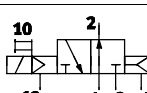
Ordering data – 3/2-way valves, single solenoid					
Circuit symbol	Description	Voltage	Pneumatic connection	Part No.	Type
In-line valves					
	Internal pilot air supply, normally closed, pneumatic reset	24 V DC	QS-6	537 468	VUVB-L-M32C-AD-Q6-1C1
			QS-8	537 469	VUVB-L-M32C-AD-Q8-1C1
	Internal pilot air supply, normally open, pneumatic reset	24 V DC	QS-6	537 470	VUVB-L-M32U-AD-Q6-1C1
			QS-8	537 471	VUVB-L-M32U-AD-Q8-1C1
	External pilot air supply, normally closed, pneumatic reset	24 V DC	QS-6	537 476	VUVB-L-M32C-AZD-Q6-1C1
			QS-8	537 477	VUVB-L-M32C-AZD-Q8-1C1
	External pilot air supply, normally open, pneumatic reset	24 V DC	QS-6	537 478	VUVB-L-M32U-AZD-Q6-1C1
			QS-8	537 479	VUVB-L-M32U-AZD-Q8-1C1
Semi in-line valves					
	External pilot air supply, normally closed, pneumatic reset	24 V DC	QS-4	537 484	VUVB-S-M32C-AZD-Q4-1C1
			QS-6	537 485	VUVB-S-M32C-AZD-Q6-1C1
			QS-8	537 486	VUVB-S-M32C-AZD-Q8-1C1
			QS-10	537 487	VUVB-S-M32C-AZD-Q10-1C1
	External pilot air supply, normally open, pneumatic reset	24 V DC	QS-4	537 488	VUVB-S-M32U-AZD-Q4-1C1
			QS-6	537 489	VUVB-S-M32U-AZD-Q6-1C1
			QS-8	537 490	VUVB-S-M32U-AZD-Q8-1C1
			QS-10	537 491	VUVB-S-M32U-AZD-Q10-1C1

Solenoid valves VUVB

Technical data

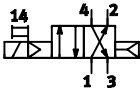
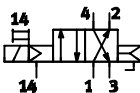
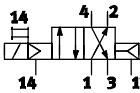
Ordering data – 4/2-way valves, single solenoid					
Circuit symbol	Description	Voltage	Pneumatic connection	Part No.	Type
In-line valves					
	Internal pilot air supply, pneumatic reset	24 V DC	QS-6	537 472	VUVB-L-M42-AD-Q6-1C1
			QS-8	537 473	VUVB-L-M42-AD-Q8-1C1
	External pilot air supply, pneumatic reset	24 V DC	QS-6	537 480	VUVB-L-M42-AZD-Q6-1C1
			QS-8	537 481	VUVB-L-M42-AZD-Q8-1C1
Semi in-line valves					
	External pilot air supply, pneumatic reset	24 V DC	QS-4	537 492	VUVB-S-M42-AZD-Q4-1C1
			QS-6	537 493	VUVB-S-M42-AZD-Q6-1C1
			QS-8	537 494	VUVB-S-M42-AZD-Q8-1C1
			QS-10	537 495	VUVB-S-M42-AZD-Q10-1C1
			–1)	537 534	VUVB-S-M42-AZD-QX-1C1

1) Valve is supplied without cartridge fitting.

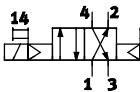
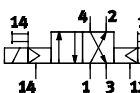
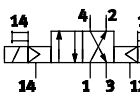
Ordering data – 4/2-way valves, double solenoid					
Circuit symbol	Description	Voltage	Pneumatic connection	Part No.	Type
In-line valves					
	Internal pilot air supply	24 V DC	QS-6	537 474	VUVB-L-B42-D-Q6-1C1
			QS-8	537 475	VUVB-L-B42-D-Q8-1C1
	External pilot air supply	24 V DC	QS-6	537 482	VUVB-L-B42-ZD-Q6-1C1
			QS-8	537 483	VUVB-L-B42-ZD-Q8-1C1
Semi in-line valves					
	External pilot air supply	24 V DC	QS-4	573 496	VUVB-S-B42-ZD-Q4-1C1
			QS-6	573 497	VUVB-S-B42-ZD-Q6-1C1
			QS-8	537 498	VUVB-S-B42-ZD-Q8-1C1
			QS-10	537 499	VUVB-S-B42-ZD-Q10-1C1
			–1)	537 535	VUVB-S-B42-ZD-QX-1C1

1) Valve is supplied without cartridge fitting.

Solenoid valves VUVB

Accessories

Manifold rail G¹/₄ VABM

Material:
Wrought aluminium alloy



Dimensions

Download CAD data → www.festo.com/en/engineering

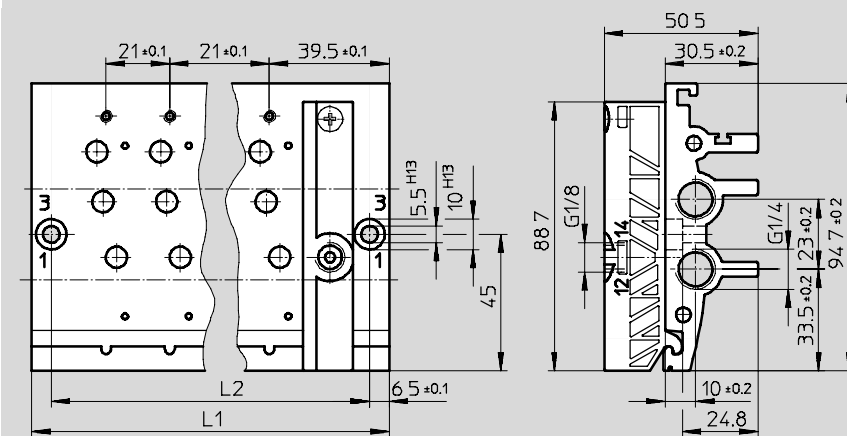

Dimensions and ordering data

Valve positions	L1	L2	Weight [g]	CRC ¹⁾	Part No.	Type
2	85	72	270	2	537 500	VABM-B6-E-G14-2
4	127	114	400	2	537 501	VABM-B6-E-G14-4
6	169	156	530	2	537 502	VABM-B6-E-G14-6
8	211	198	670	2	537 503	VABM-B6-E-G14-8
10	253	240	800	2	537 504	VABM-B6-E-G14-10
12	295	282	940	2	537 505	VABM-B6-E-G14-12

1) Corrosion resistance class 2 according to Festo standard 940 070

Components requiring moderate corrosion resistance. Externally visible parts with primarily decorative surface requirements which are in direct contact with a normal industrial environment or media such as coolants or lubricating agents.

Solenoid valves VUVB

Accessories

**Manifold rail G $\frac{1}{2}$
VABM**

Material:
Wrought aluminium alloy



Dimensions

Download CAD data → www.festo.com/en/engineering

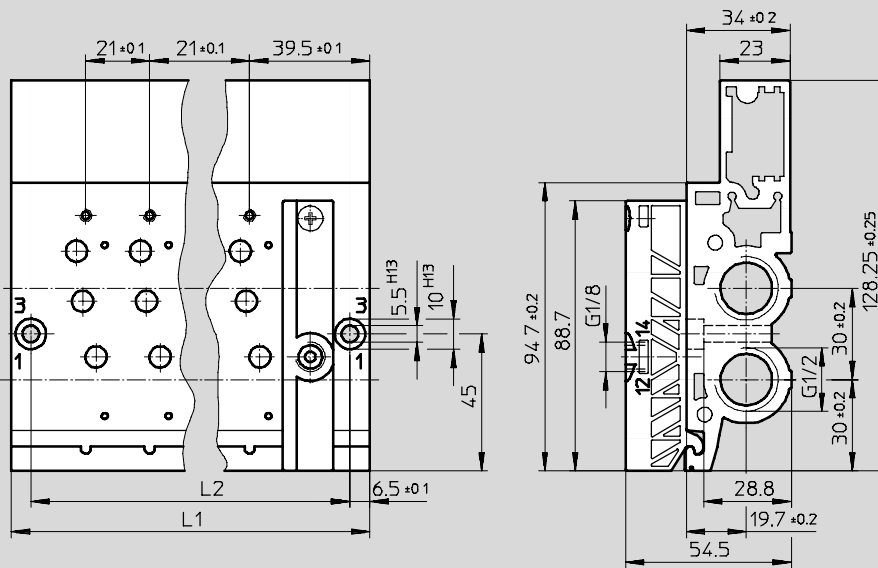

Dimensions and ordering data

Valve positions	L1	L2	Weight [g]	CRC ¹⁾	Part No.	Type
2	85	72	460	2	537 506	VABM-B6-E-G12-2
4	127	114	690	2	537 507	VABM-B6-E-G12-4
6	169	156	915	2	537 508	VABM-B6-E-G12-6
8	211	198	1150	2	537 509	VABM-B6-E-G12-8
10	253	240	1380	2	537 510	VABM-B6-E-G12-10
12	295	282	1620	2	537 511	VABM-B6-E-G12-12

1) Corrosion resistance class 2 according to Festo standard 940 070
Components requiring moderate corrosion resistance. Externally visible parts with primarily decorative surface requirements which are in direct contact with a normal industrial environment or media such as coolants or lubricating agents.

Solenoid valves VUVB

Accessories

Sub-base VABS

Material:
Polyamide, reinforced

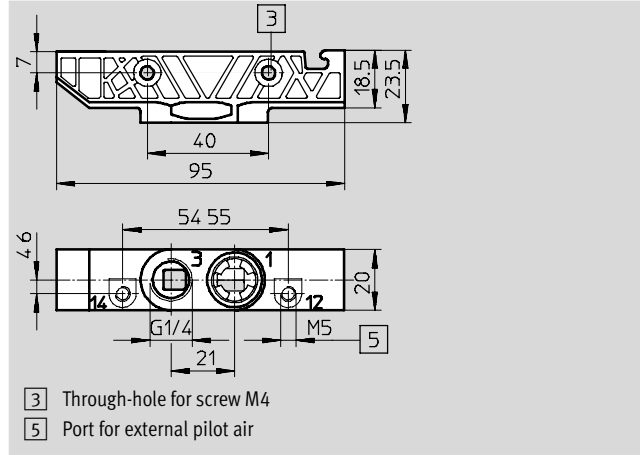

Ordering data				
Pilot air supply	Weight [g]	CRC ¹⁾	Part No.	Type
Internal	22	2	537 518	VABS-B6-PB-Q-B
External	22	2	537 519	VABS-B6-PB-Q

1) Corrosion resistance class 2 according to Festo standard 940 070
Components requiring moderate corrosion resistance. Externally visible parts with primarily decorative surface requirements which are in direct contact with a normal industrial environment or media such as coolants or lubricating agents.

Cover for valve housing VAMC

Material:
Polyamide

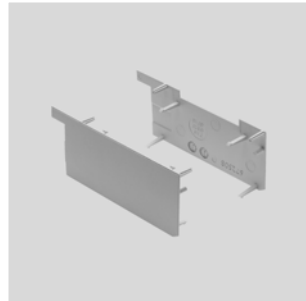

Ordering data		
CRC ¹⁾	Part No.	Type
2	537 512	VAMC-B6-C

1) Corrosion resistance class 2 according to Festo standard 940 070
Components requiring moderate corrosion resistance. Externally visible parts with primarily decorative surface requirements which are in direct contact with a normal industrial environment or media such as coolants or lubricating agents.

Solenoid valves VUVB

Accessories

FESTO

Pressure zone supply module VABF

Material:
Polyamide, reinforced

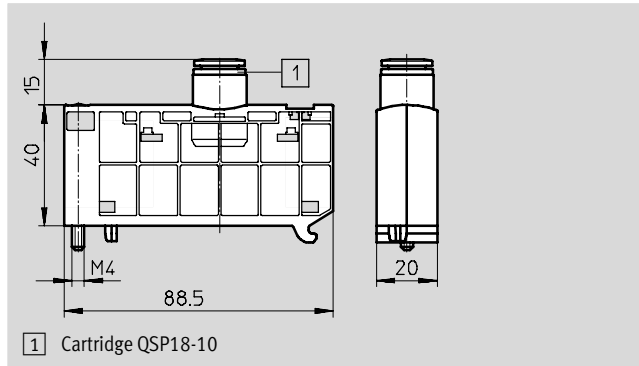

Ordering data			
CRC ¹⁾	Part No.	Type	
2	537 517	VABF-B6-P1A5-Q10	
2	537 532	VABF-B6-P1A5-Q	

- 1) Corrosion resistance class 2 according to Festo standard 940 070
Components requiring moderate corrosion resistance. Externally visible parts with primarily decorative surface requirements which are in direct contact with a normal industrial environment or media such as coolants or lubricating agents.

Blanking plate VABB

Material:
Polyamide, reinforced

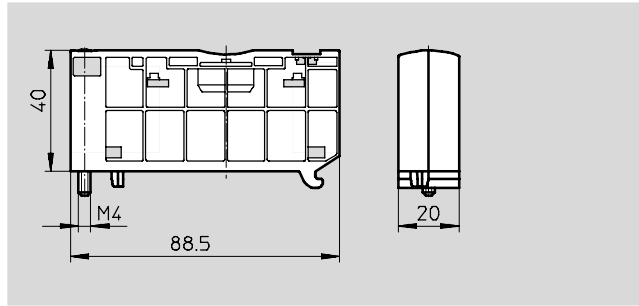

Ordering data		
CRC ¹⁾	Part No.	Type
2	537 513	VABB-B6-E

- 1) Corrosion resistance class 2 according to Festo standard 940 070
Components requiring moderate corrosion resistance. Externally visible parts with primarily decorative surface requirements which are in direct contact with a normal industrial environment or media such as coolants or lubricating agents.

Solenoid valves VUVB

Accessories

Sealing plug for pressure zone separation VABD

Material:
Steel

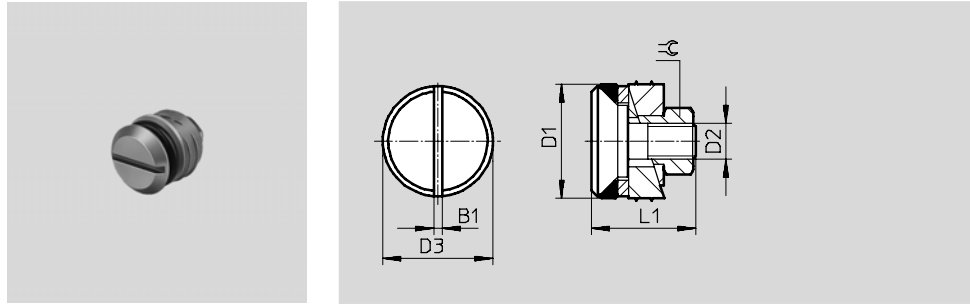

Dimensions and ordering data									
Manifold rail	B1	D1	D2	D3	L1	⌀	CRC ¹⁾	Part No.	Type
G1/4	1.6	11.7	M4	11.3	13.9	7	2	537 515	VABD-B6-14-P-C
G1/2	1.4	19	M6	18.3	17.3	10	2	537 516	VABD-B6-12-P-C

1) Corrosion resistance class 2 according to Festo standard 940 070
Components requiring moderate corrosion resistance. Externally visible parts with primarily decorative surface requirements which are in direct contact with a normal industrial environment or media such as coolants or lubricating agents.

H-rail mounting VAME

Material:
Steel

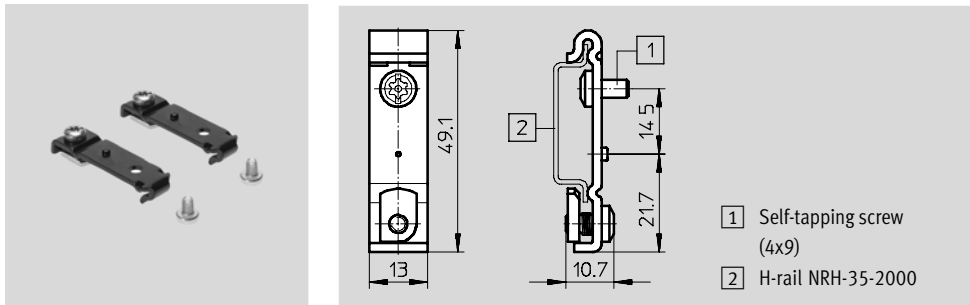



Ordering data		
CRC ¹⁾	Part No.	Type
2	537 514	VAME-B6-T

1) Corrosion resistance class 2 according to Festo standard 940 070
Components requiring moderate corrosion resistance. Externally visible parts with primarily decorative surface requirements which are in direct contact with a normal industrial environment or media such as coolants or lubricating agents.



Solenoid valves VUVB

Accessories

Ordering data – Cartridge fittings for valves		Technical data → Volume 3			
Ordering data – Cartridge fittings		Technical data → www.festo.com			
	Connection Ø	Tubing O.D.	Part No.	Type	PU*
Cartridge fitting					
	18 mm	4	130 839	QSP-18-4	10
		6	130 840	QSP-18-6	10
		8	130 841	QSP-18-8	10
		10	130 842	QSP-18-10	10
L-cartridge					
	18 mm	4	130 843	QSPL-18-4	10
		6	130 844	QSPL-18-6	10
		8	130 845	QSPL-18-8	10
Long L-cartridge					
	18 mm	4	130 846	QSPLL-18-4	10
		6	130 847	QSPLL-18-6	10
		8	130 848	QSPLL-18-8	10

* Packaging unit quantity

Ordering data – Blanking plugs		Technical data → Volume 3	
Ordering data – Cartridges		Technical data → www.festo.com	
	Connection Ø	Part No.	Type
	18 mm	537 533	QSPC18

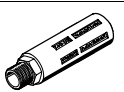



Ordering data – Silencers		Technical data → Volume 3	
Ordering data – Silencers		Technical data → www.festo.com	
		Part No.	Type
	For G ¹ / ₈ thread	161 419	UC- ¹ / ₈
	For G ¹ / ₄ thread	165 004	UC- ¹ / ₄
	For G ¹ / ₈ thread	2 307	U- ¹ / ₈
	For G ¹ / ₄ thread	2 316	U- ¹ / ₄
	For G ¹ / ₄ thread	6 841	U- ¹ / ₈ -B
	For G ¹ / ₄ thread	6 842	U- ¹ / ₄ -B
	For G ¹ / ₂ thread	6 844	U- ¹ / ₂ -B

 Core Range

Solenoid valves VUVB

Accessories

FESTO

Ordering data – Push-in fittings for manifold rails			Technical data → Volume 3			
Ordering data – Push-in fittings			Technical data → www.festo.com			
	Connection	Tubing O.D.	Part No.	Type	PU*	
Push-in fitting – G thread with sealing ring						
	G ¹ / ₈	6	186 096	QS-G ¹ / ₈ -6	10	
		8	186 098	QS-G ¹ / ₈ -8	10	
	G ¹ / ₄	6	186 097	QS-G ¹ / ₄ -6	10	
		8	186 099	QS-G ¹ / ₄ -8	10	
		10	186 101	QS-G ¹ / ₄ -10	10	
		12	186 350	QS-G ¹ / ₄ -12	10	
	G ¹ / ₂	12	186 104	QS-G ¹ / ₂ -12	1	
		16	186 105	QS-G ¹ / ₂ -16	1	
	Push-in fitting – R thread					
		R ¹ / ₄	6	153 003	QS- ¹ / ₄ -6	10
8			153 005	QS- ¹ / ₄ -8	10	
10			153 007	QS- ¹ / ₄ -10	10	
12			164 980	QS- ¹ / ₄ -12	10	
R ¹ / ₂		10	190 646	QS- ¹ / ₂ -10	1	
		12	153 010	QS- ¹ / ₂ -12	1	
		16	153 011	QS- ¹ / ₂ -16	1	
Push-in L-fitting – G thread with sealing ring						
	G ¹ / ₈	6	186 117	QSL-G ¹ / ₈ -6	10	
		8	186 119	QSL-G ¹ / ₈ -8	10	
	G ¹ / ₄	6	186 118	QSL-G ¹ / ₄ -6	10	
		8	186 120	QSL-G ¹ / ₄ -8	10	
		10	186 122	QSL-G ¹ / ₄ -10	10	
		12	186 351	QSL-G ¹ / ₄ -12	10	
	G ¹ / ₂	12	186 125	QSL-G ¹ / ₂ -12	1	
		16	186 126	QSL-G ¹ / ₂ -16	1	
Push-in long L-fitting – G thread with sealing ring						
	G ¹ / ₄	6	186 129	QSLL-G ¹ / ₄ -6	10	
		8	186 131	QSLL-G ¹ / ₄ -8	10	
		10	186 133	QSLL-G ¹ / ₄ -10	10	
	G ¹ / ₂	12	186 136	QSLL-G ¹ / ₂ -12	1	
		16	190 665	QSLL-G ¹ / ₂ -16	1	

* Packaging unit quantity

Ordering data – Blanking plugs			Technical data → Volume 3		
Ordering data – Blanking plugs			Technical data → www.festo.com		
		Part No.	Type	PU*	
	For G ¹ / ₄ thread	3 569	B- ¹ / ₄	10	
	For G ¹ / ₂ thread	3 571	B- ¹ / ₂	10	





* Packaging unit quantity

Ordering data – Inscription labels		
		Part No. Type
	Scope of delivery 24 labels in frame	161 937 IBS-9x17
	Scope of delivery 80 labels in frame	197 259 MH-BZ-80X

 Core Range

Solenoid valves VUVB

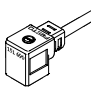
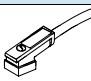
Accessories

Ordering data – Plug sockets, plug sockets with cable				
	Voltage	Cable length [m]	Switching status display with LED	Part No. Type
Plug socket without cable				Technical data → NO TAG
Plug socket without cable				Technical data → www.festo.com
	–	–	–	151 687 MSSD-EB
	–	–	–	539 712 MSSD-EB-M12
Plug socket without cable with insulation displacement technology				Technical data → NO TAG
Plug socket without cable with insulation displacement technology				Technical data → www.festo.com
	–	–	–	192 745 MSSD-EB-S-M14
PVC plug socket with cable				Technical data → NO TAG
Plug socket with cable				Technical data → www.festo.com
	24 V DC	2.5	■	151 688 KMEB-1-24-2,5-LED
	24 V DC	5	■	151 689 KMEB-1-24-5-LED
	Up to 240 V	2.5	–	151 690 KMEB-1-230AC-2,5
	Up to 240 V	5	–	151 691 KMEB-1-230AC-5
PUR plug socket with cable				Technical data → NO TAG
Plug socket with PUR cable				Technical data → www.festo.com
	24 V DC	2.5	■	174 844 KMEB-2-24-2,5-LED
	24 V DC	5	■	174 845 KMEB-2-24-5-LED
Ordering data – Illuminating seal Technical data → NO TAG				
Ordering data – Illuminating seals for EB solenoid coils Technical data → www.festo.com				
	Voltage	Part No. Type		
	12 ... 24 V DC	151 717 MEB-LD-12-24DC		

Directional control valves for standard applications
VUVB

2.7

 Core Range