

SELF-LOCKING PINS

785-392-3017 FAX 785.392.2845

REVISED 06-04
www.huyett.com

PRECISION GROUND

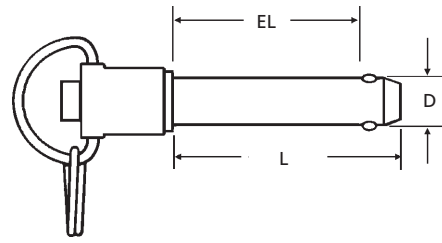

PLR	Nominal Diameter (D)	Effective Length (EL)	Overall Length (L)	WEIGHT Lbs. per 100 Pieces	MATERIAL		
	DIAMETER	LENGTH			Alloy Steel "PLR-"	17-4 Stainless "PLRS-"	300 Stainless "PLRS3-"
	3/16	.1870 / .1885	1/2	.760	8.28		
			3/4	1.010	8.52		
			1	1.260	8.75		
			1-1/4	1.510	8.98		
			1-1/2	1.760	9.22		
			2	2.260	9.69		
			2-1/2	2.760	10.16		
	1/4	.2470 / .2485	1/2	.790	11.72		
			3/4	1.040	12.11		
			1	1.290	12.50		
			1-1/4	1.540	12.89		
			1-1/2	1.790	13.28		
			1-3/4	2.040	13.67		
			2	2.290	14.06		
	5/16	.3095 / .3110	2-1/2	2.790	14.84		
			3	3.290	15.63		
			3-1/2	3.790	16.41		
			4	4.290	17.19		
			1/2	.830	13.75		
			3/4	1.080	14.38		
			1	1.330	15.00		
	3/8	.3720 / .3735	1-1/4	1.580	15.63		
			1-1/2	1.830	16.25		
			2	2.330	17.50		
			2-1/2	2.830	18.75		
			3	3.330	20.00		
			3-1/2	3.830	21.25		
			4	4.330	22.50		
			4-1/2	4.830	23.75		
			5	5.330	25.00		
			6	6.330	27.50		
			1/2	.865	16.56		
			1	1.365	18.13		
			1-1/4	1.615	18.91		
			1-1/2	1.865	19.69		
			1-3/4	2.115	20.47		
			2	2.365	21.25		
			2-1/4	2.615	22.03		

DESCRIPTION	GENERAL USE	HOW TO IDENTIFY	APPLICATION
<p>PLR</p> <p>These pins feature a secure locking mechanism with an easy grip ring handle that is small enough to fit into recesses. Ring handle positive lock pins are the most economical of the group.</p> <p>RING HANDLE</p>	<p>COMMON</p>	<ol style="list-style-type: none"> 1. Verify ring grip. 2. Measure diameter (D). 3. Measure effective length (EL). 4. Find the part in the chart above. <p>TYPICAL PART NUMBER SEQUENCE: PLRS3-0312-1500 is a 5/16" x 1-1/2" 304 stainless ring grip pin.</p>	<p>Ring assists removal in recessed areas.</p>

PERFORMANCE RESULTS VARY. YOUR PIN SELECTION SHOULD BE MADE BASED ON INDIVIDUAL APPLICATION.

MOST SIZES AVAILABLE IMMEDIATELY • \$2 LINE REQUESTED • CALL PLANT FOR QUANTITY DISCOUNTS

AVAILABLE IN THREE GRADES

BOX 232 • MINNEAPOLIS, KS • 67467

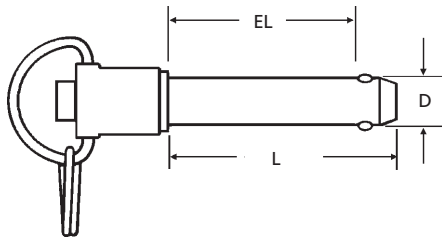

RING HANDLE

MANUFACTURER CROSS-REFERENCE

Carr Lane	BLPR	Reid Tool	BLR
Avibank	BLR	Lockwell	LGR



PLR	Nominal Diameter (D)	Effective Length (EL)	Overall Length (L)	WEIGHT	MATERIAL		
	DIAMETER	LENGTH		Lbs. per 100 Pieces	Alloy Steel "PLR-"	17-4 Stainless "PLRS-"	300 Stainless "PLRS3-"
-0375-2500	3/8	2-1/2	2.865	22.81			
-0375-3000		3	3.365	24.38			
-0375-3500		3-1/2	3.865	25.94			
-0375-4000		4	4.365	27.50			
-0375-4500		4-1/2	4.865	29.06			
-0375-5000		5	5.365	30.63			
-0375-5500	5-1/2	5.865	32.19				
-0375-6000	6	6.365	33.75				
-0437-1000	7/16	1	1.380	22.00			
-0437-1500		1-1/2	1.880	23.94			
-0437-2000		2	2.380	25.88			
-0437-2500	2-1/2	2.880	27.81				
-0500-1000	1/2	1	1.460	26.25			
-0500-1250		1-1/4	1.710	27.50			
-0500-1500		1-1/2	1.960	28.75			
-0500-1750		1-3/4	2.210	30.00			
-0500-2000		2	2.460	31.25			
-0500-2500		2-1/2	2.960	33.75			
-0500-3000		3	3.460	36.25			
-0500-3500		3-1/2	3.960	38.75			
-0500-4000		4	4.460	41.25			
-0500-4500		4-1/2	4.960	43.75			
-0500-5000		5	5.460	46.25			
-0500-5500		5-1/2	5.960	48.75			
-0500-6000	6	6.460	51.25				
-0625-1500	5/8	1-1/2	2.080	37.66			
-0625-2000		2	2.580	41.88			
-0625-2500		2-1/2	3.080	46.09			
-0625-3000		3	3.580	50.31			
-0625-3500		3-1/2	4.080	54.53			
-0625-4000		4	4.580	58.75			
-0625-4500		4-1/2	5.080	62.97			
-0625-5000		5	5.580	67.19			
-0625-5500	5-1/2	6.080	71.41				
-0625-6000	6	6.580	75.63				
-0750-1500	3/4	1-1/2	2.170	48.13			
-0750-2000		2	2.670	55.31			
-0750-2500		2-1/2	3.170	62.50			

DESCRIPTION	GENERAL USE	HOW TO IDENTIFY	APPLICATION
<p>PLR</p> <p>These pins feature a secure locking mechanism with an easy grip ring handle that is small enough to fit into recesses. Ring handle positive lock pins are the most economical of the group.</p> <p>RING HANDLE</p>	<p>COMMON</p>	<ol style="list-style-type: none"> 1. Verify ring grip. 2. Measure diameter (D). 3. Measure effective length (EL). 4. Find the part in the chart above. <p>TYPICAL PART NUMBER SEQUENCE: PLR-0625-1500 is a 5/8" x 1-1/2" alloy ring grip pin.</p>	<p>Quick and easy to remove from applications.</p>

PERFORMANCE RESULTS VARY. YOUR PIN SELECTION SHOULD BE MADE BASED ON INDIVIDUAL APPLICATION.



MOST SIZES AVAILABLE IMMEDIATELY • \$2 LINE REQUESTED • CALL PLANT FOR QUANTITY DISCOUNTS

All manufacturer names and numbers are for identification purposes only. In no way are we implying that our parts were made by the manufacturers listed above. Prices, materials, tolerances, and grades subject to change without notice.