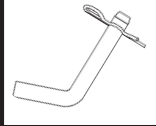

**BENT**
**MANUFACTURER CROSS-REFERENCE**

ITW/Bee-Leitzke	31	Pivot Point	BENT
Miller	B		

**BTP**
**Nominal (D)**
**Effective Length (EL)**
**WEIGHT**  
**Lbs. per 100 Pieces**
**MATERIALS\***

 Zinc Clear  
 "BTP."

	<b>DIAMETER</b>	<b>LENGTH</b>	
-0312-2500	<b>5/16</b>	2-1/2	10.00
-0312-3000		3	12.00
-0375-2500	<b>3/8</b>	2-1/2	15.00
-0375-3000		3	26.00
-0375-3500		3-1/2	20.00
-0375-4000		4	22.86
-0500-2500	<b>1/2</b>	2-1/2	26.00
-0500-3000		3	28.00
-0500-4000		4	34.00
-0500-4500		4-1/2	38.25
-0500-5000		5	42.00
-0625-3000	<b>5/8</b>	3	48.00
-0625-4000		4	57.00
-0625-5000		5	70.00
-0750-3500	<b>3/4</b>	3-1/2	75.00
-0750-4500		4-1/2	88.00
-0750-5000		5	100.00
-1000-4750	<b>1</b>	4-3/4	178.93
-1000-6750		6-3/4	252.27

**BTP**
**DESCRIPTION**

Bent pins are simple pins with one straight end and a 25° angle bent arm at the opposite end. This low cost pin can be drilled and used with a wire form pin, or with a grooved end and secured with a retaining ring.

**BENT**
**GENERAL USE**

**COMMON**
**HOW TO IDENTIFY**

1. Verify bent pin with a hole drilled through the straight end.
2. Measure diameter (D).
3. Measure effective length (EL).
4. Find the part in the chart above.

**TYPICAL PART NUMBER SEQUENCE:**
**BTP-0500-2500**

is a 1/2" x 2-1/2" zinc bent pin.

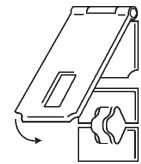
**APPLICATION**

Used to secure a hasp.

PERFORMANCE RESULTS VARY. YOUR PIN SELECTION SHOULD BE MADE BASED ON INDIVIDUAL APPLICATION.

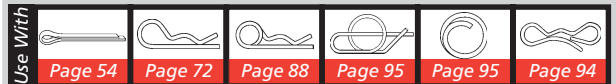
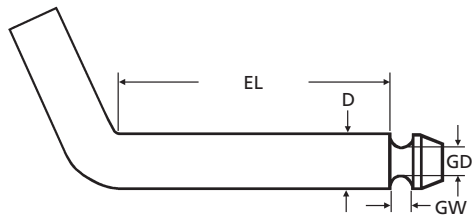
**MADE TO ORDER**

**GROOVED BENT**
**MANUFACTURER CROSS-REFERENCE**

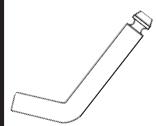
Pivot Point	BENT	Miller
-------------	------	--------



CALL FOR PRICING AND AVAILABILITY.

**MOST SIZES AVAILABLE IMMEDIATELY • \$2 LINE REQUESTED • CALL PLANT FOR QUANTITY DISCOUNTS**

All manufacturer names and numbers are for identification purposes only. In no way are we implying that our parts were made by the manufacturers listed above. Prices, materials, tolerances, and grades subject to change without notice.