

# CLEVIS PINS

785-392-3017 FAX 785.392.2845

REVISED 09-02

**NO MATING PARTS NEEDED!**

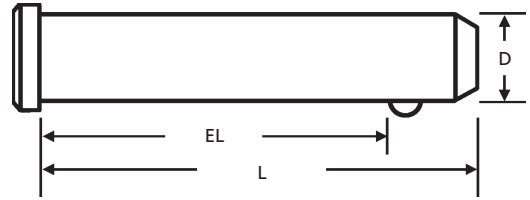

<b>COTTERLESS CLEVIS</b>	
<b>MANUFACTURER CROSS-REFERENCE</b>	
ITW/Bee-Leitzke	12

<b>CLPC</b>	Nominal (D)	Length (L)	Effective Length (EL)	WEIGHT Lbs. per 100 Pieces	<b>MATERIALS</b>		
	DIAMETER	LENGTH			Plain "CLPC-"	Zinc Clear "CLPCZ-"	Stainless "CLPCS-"
-0187-1000	<b>3/16</b>	1	13/16	0.81			
-0187-1500		1-1/2	1-5/16	1.06			
-0187-2000		2	1-13/16	1.38			
-0187-2500		2-1/2	2-5/16	1.50			
-0187-3000		3	2-13/16	2.13			
-0250-1000	<b>1/4</b>	1	3/4	1.25			
-0250-1500		1-1/2	1-1/4	2.00			
-0250-2000		2	1-3/4	2.44			
-0250-2500		2-1/2	2-1/4	3.19			
-0250-3000		3	2-3/4	4.06			
-0250-3500	3-1/2	3-1/4	5.00				
-0250-4000	4	3-3/4	5.31				
-0250-5000	5	4-3/4	6.38				
-0312-1000	<b>5/16</b>	1	5/8	2.13			
-0312-1500		1-1/2	1-1/8	3.19			
-0312-2000		2	1-5/8	4.06			
-0312-2500		2-1/2	2-1/8	5.00			
-0312-3000		3	2-5/8	6.13			
-0312-3500	3-1/2	3-1/8	7.06				
-0312-4000	4	3-5/8	8.19				
-0375-1000	<b>3/8</b>	1	5/8	3.13			
-0375-1500		1-1/2	1-1/8	4.44			
-0375-2000		2	1-5/8	6.13			
-0375-2500		2-1/2	2-1/8	7.38			
-0375-3000		3	2-5/8	9.00			
-0375-3500	3-1/2	3-1/8	10.00				
-0375-4000	4	3-5/8	12.31				
-0500-1000	<b>1/2</b>	1	1/2	6.38			
-0500-1500		1-1/2	1	9.38			
-0500-2000		2	1-1/2	12.00			
-0500-2500		2-1/2	2	15.00			
-0500-3000		3	2-1/2	17.50			
-0500-3500		3-1/2	3	22.50			
-0500-4000		4	3-1/2	23.50			
-0500-4500		4-1/2	4	27.00			
-0500-5000		5	4-1/2	30.00			

DESCRIPTION	GENERAL USE	HOW TO IDENTIFY	APPLICATION
<p><b>CLPC</b></p> <p>Detent clevis pins feature a spring loaded ball bearing for easy one-piece fastening. Typical uses include blind holes or in repetitive use applications.</p> <p><b>COTTERLESS CLEVIS</b></p>	<p>UNCOMMON</p>	<ol style="list-style-type: none"> <li>Verify flat head pin with self-locking ball bearing at opposite end.</li> <li>Measure diameter (D).</li> <li>Measure length (L).</li> <li>Find the part in the chart above.</li> </ol> <p><b>TYPICAL PART NUMBER SEQUENCE:</b>  <b>CLPC-0375-1000</b>  <i>is a 3/8" x 1" plain detent clevis pin.</i></p>	<p>As a positioning pin.</p>

<b>DETENT PIN VARIATIONS</b>				
Page 36.	Page 42.	Page 44.	Page 46.	Page 48.

PERFORMANCE RESULTS VARY. YOUR PIN SELECTION SHOULD BE MADE BASED ON INDIVIDUAL APPLICATION.

**MOST SIZES AVAILABLE IMMEDIATELY • \$2 LINE REQUESTED • CALL PLANT FOR QUANTITY DISCOUNTS**