

CLEVIS PINS

785-392-3017 FAX 785.392.2845

REVISED 09-02

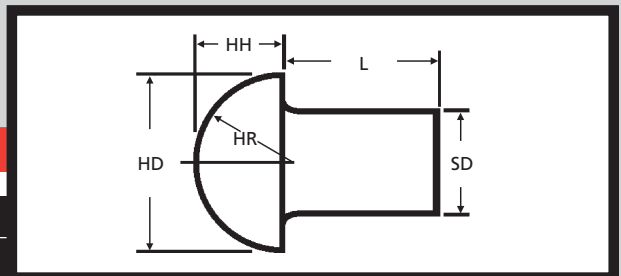

BUTTON HEAD RIVET

MANUFACTURER CROSS-REFERENCE

| | | |
|-----------------|----|--|
| ITW/Bee-Leitzke | 46 | |
|-----------------|----|--|

| RVB | Nominal | Length (L) | Shank Diameter (SD) | Head Diameter (HD) | Head Height (HH) | *Head Radius (HR) | WEIGHT | MATERIALS |
|------------|-------------|------------|---------------------|--------------------|------------------|-------------------|---------------------|-----------|
| | DIAMETER | LENGTH | Max/Min | Max/Min | Max/Min | | Lbs. per 100 Pieces | |
| -0125-0500 | 1/8 | 1/2 | .127/.121 | .235/.215 | .100/.088 | .111 | .24 | |
| -0125-0750 | | 3/4 | | | | | .33 | |
| 0125-1000 | | 1 | | | | | .42 | |
| -0187-0500 | 3/16 | 1/2 | .191/.182 | .348/.322 | .147/.133 | .166 | .61 | |
| -0187-0625 | | 5/8 | | | | | .70 | |
| -0187-0750 | | 3/4 | | | | | .80 | |
| -0187-1000 | | 1 | | | | | .99 | |
| -0187-1250 | | 1-1/4 | | | | | 1.18 | |
| -0187-1500 | | 1-1/2 | | | | | 1.38 | |
| -0250-0500 | 1/4 | 1/2 | .253/.244 | .460/.430 | .196/.180 | .221 | 1.21 | |
| -0250-0625 | | 5/8 | | | | | 1.39 | |
| -0250-0750 | | 3/4 | | | | | 1.56 | |
| -0250-1000 | | 1 | | | | | 1.90 | |
| -0250-1250 | | 1-1/4 | | | | | 2.25 | |
| -0250-1500 | 1-1/2 | 2.59 | | | | | | |
| -0312-0500 | 5/16 | 1/2 | .316/.304 | .572/.538 | .243/.225 | .276 | 2.10 | |
| -0312-0625 | | 5/8 | | | | | 2.37 | |
| -0312-0750 | | 3/4 | | | | | 2.64 | |
| -0312-1000 | | 1 | | | | | 3.18 | |
| -0312-1250 | | 1-1/4 | | | | | 3.72 | |
| -0312-1500 | 1-1/2 | 4.25 | | | | | | |
| -0375-0500 | 3/8 | 1/2 | .380/.365 | .684/.646 | .291/.271 | .332 | 3.33 | |
| -0375-0625 | | 5/8 | | | | | 3.71 | |
| -0375-0750 | | 3/4 | | | | | 4.10 | |
| -0375-1000 | | 1 | | | | | 4.87 | |
| -0375-1250 | | 1-1/4 | | | | | 5.64 | |
| -0375-1500 | | 1-1/2 | | | | | 6.42 | |
| -0500-1000 | 1/2 | 1 | .520/.478 | .938/.844 | .406/.375 | .443 | 9.77 | |
| -0500-1500 | | 1-1/2 | | | | | 12.55 | |
| -0500-2000 | | 2 | | | | | 15.33 | |
| -0500-3000 | | 3 | | | | | 20.88 | |

*Approximate radius.

| RVB | DESCRIPTION | GENERAL USE | HOW TO IDENTIFY | APPLICATION |
|-----|---|---------------|--|---|
| | <p>Non-holed, cold headed parts used in automated assembly. After insertion the part is driven to displace the end material, which provides a permanent secure fit.</p> <p>BUTTON HEAD</p> | <p>COMMON</p> | <ol style="list-style-type: none"> 1. Verify head design. 2. Measure shank diameter (SD). 3. Measure length (L). 4. Find the part in the chart above. <p>TYPICAL PART NUMBER SEQUENCE: RVB-0125-1000 is a 1/8" x 1" button head rivet.</p> | <p>Driven tail formed into a secure anchor.</p> |

PERFORMANCE RESULTS VARY. YOUR PIN SELECTION SHOULD BE MADE BASED ON INDIVIDUAL APPLICATION.

MOST SIZES AVAILABLE IMMEDIATELY • \$2 LINE REQUESTED • CALL PLANT FOR QUANTITY DISCOUNTS

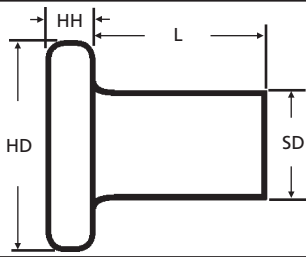

FLAT HEAD RIVET

MANUFACTURER CROSS-REFERENCE

ITW/Bee-Leitzke

47

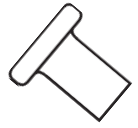

| RVF | Nominal | Length (L) | Shank Diameter (SD) | Head Diameter (HD) | Head Height (HH) | WEIGHT | MATERIALS |
|------------|-------------|------------|---------------------|--------------------|------------------|---------------------|--------------|
| | DIAMETER | LENGTH | Max/Min | Max/Min | Max/Min | Lbs. per 100 Pieces | |
| -0125-0500 | 1/8 | 1/2 | .127/.121 | .260/.240 | .048/.036 | .24 | Plain "RVF-" |
| -0125-0750 | | 3/4 | | | | .33 | |
| -0125-1000 | | 1 | | | | .41 | |
| -0187-0500 | 3/16 | 1/2 | .191/.182 | .387/.361 | .069/.055 | .60 | |
| -0187-0625 | | 5/8 | | | | .69 | |
| -0187-0750 | | 3/4 | | | | .79 | |
| -0187-1000 | | 1 | | | | .98 | |
| -0187-1250 | | 1-1/4 | | | | 1.17 | |
| -0187-1500 | | 1-1/2 | | | | 1.37 | |
| -0250-0500 | 1/4 | 1/2 | .253/.244 | .515/.485 | .091/.075 | 1.19 | |
| -0250-0625 | | 5/8 | | | | 1.36 | |
| -0250-0750 | | 3/4 | | | | 1.53 | |
| -0250-1000 | | 1 | | | | 1.88 | |
| -0250-1250 | | 1-1/4 | | | | 2.22 | |
| -0250-1500 | 1-1/2 | 2.56 | | | | | |
| -0312-0500 | 5/16 | 1/2 | .316/.304 | .641/.607 | .113/.095 | 2.05 | |
| -0312-0625 | | 5/8 | | | | 2.32 | |
| -0312-0750 | | 3/4 | | | | 2.59 | |
| -0312-1000 | | 1 | | | | 3.13 | |
| -0312-1250 | | 1-1/4 | | | | 3.69 | |
| -0312-1500 | 1-1/2 | 4.20 | | | | | |
| -0375-0500 | 3/8 | 1/2 | .380/.365 | .769/.731 | .135/.115 | 3.24 | |
| -0375-0625 | | 5/8 | | | | 3.63 | |
| -0375-0750 | | 3/4 | | | | 4.01 | |
| -0375-1000 | | 1 | | | | 4.79 | |
| -0375-1250 | | 1-1/4 | | | | 5.56 | |
| -0375-1500 | 1-1/2 | 6.33 | | | | | |
| -0500-1000 | 1/2 | 1 | .520/.478 | 1.023/.973 | .178/.155 | 9.51 | |
| -0500-1500 | | 1-1/2 | | | | 12.29 | |
| -0500-2000 | | 2 | | | | 15.07 | |
| -0500-3000 | | 3 | | | | 20.63 | |

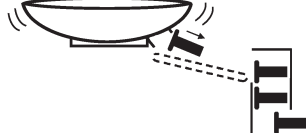
| RVF | DESCRIPTION | GENERAL USE | HOW TO IDENTIFY | APPLICATION |
|-----|--|---|---|--|
| | Non-holed, cold headed parts used in automated assembly. After insertion the part is driven to displace the end material, which provides a permanent secure fit. |  COMMON | <ol style="list-style-type: none"> 1. Verify head design. 2. Measure shank diameter (SD). 3. Measure length (L). 4. Find the part in the chart above. <p>TYPICAL PART NUMBER SEQUENCE: RVF-0125-1000 is a 1/8" x 1" flat head rivet.</p> |  Ideal for automatic assembly. |

PERFORMANCE RESULTS VARY. YOUR PIN SELECTION SHOULD BE MADE BASED ON INDIVIDUAL APPLICATION.

MOST SIZES AVAILABLE IMMEDIATELY • \$2 LINE REQUESTED • CALL PLANT FOR QUANTITY DISCOUNTS

All manufacturer names and numbers are for identification purposes only. In no way are we implying that our parts were made by the manufacturers listed above. Prices, materials, tolerances, and grades subject to change without notice.

CLEVIS PINS

785-392-3017 FAX 785.392.2845

REVISED 09-02



TRUSS HEAD RIVET

MANUFACTURER CROSS-REFERENCE

ITW/Bee-Leitzke

48

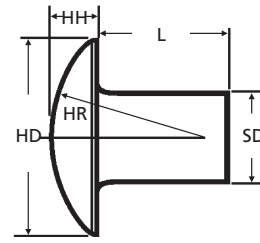

| RVT | Nominal | Length (L) | Shank Diameter (SD) | Head Diameter (HD) | Head Height (HH) | *Head Radius (HR) | WEIGHT | MATERIALS |
|------------|----------|------------|---------------------|--------------------|------------------|-------------------|---------------------|--------------|
| | DIAMETER | LENGTH | Max/Min | Max/Min | Max/Min | | Lbs. per 100 Pieces | |
| -0187-0500 | 3/16 | 1/2 | .191/.182 | .422/.422 | .069/.055 | .470 | 0.58 | Plain "RVT." |
| -0187-0625 | | 5/8 | | | | | 0.68 | |
| -0187-0750 | | 3/4 | | | | | 0.77 | |
| -0187-1000 | | 1 | | | | | 0.96 | |
| -0187-1250 | | 1-1/4 | | | | | 1.16 | |
| -0187-1500 | | 1-1/2 | | | | | 1.35 | |
| -0250-0500 | 1/4 | 1/2 | .253/.244 | .590/.560 | .091/.075 | .628 | 1.14 | |
| -0250-0625 | | 5/8 | | | | | 1.32 | |
| -0250-0750 | | 3/4 | | | | | 1.49 | |
| -0250-1000 | | 1 | | | | | 1.83 | |
| -0250-1250 | | 1-1/4 | | | | | 2.18 | |
| -0250-1500 | | 1-1/2 | | | | | 2.52 | |
| -0312-0500 | 5/16 | 1/2 | .316/.304 | .732/.702 | .113/.095 | .784 | 1.97 | |
| -0312-0625 | | 5/8 | | | | | 2.24 | |
| -0312-0750 | | 3/4 | | | | | 2.51 | |
| -0312-1000 | | 1 | | | | | 3.05 | |
| -0312-1250 | | 1-1/4 | | | | | 3.58 | |
| -0312-1500 | | 1-1/2 | | | | | 4.12 | |
| -0375-0500 | 3/8 | 1/2 | .380/.365 | .878/.848 | .135/.115 | .942 | 3.09 | |
| -0375-0625 | | 5/8 | | | | | 3.48 | |
| -0375-0750 | | 3/4 | | | | | 3.87 | |
| -0375-1000 | | 1 | | | | | 4.64 | |
| -0375-1250 | | 1-1/4 | | | | | 5.41 | |
| -0375-1500 | | 1-1/2 | | | | | 6.19 | |

*Approximate radius.

| DESCRIPTION | GENERAL USE | HOW TO IDENTIFY | APPLICATION |
|--|---------------|---|--|
| <p>RVT</p> <p>Non-holed, cold headed parts used in automated assembly. After insertion the part is driven to displace the end material, which provides a permanent secure fit.</p> <p>TRUSS HEAD</p> | <p>COMMON</p> | <ol style="list-style-type: none"> 1. Verify head design. 2. Measure shank diameter (SD). 3. Measure length (L). 4. Find the part in the chart above. <p>TYPICAL PART NUMBER SEQUENCE: RVT-0125-1000 is a 1/8" x 1" truss head rivet.</p> | <p>Note clean visual appearance of truss head.</p> |

PERFORMANCE RESULTS VARY. YOUR PIN SELECTION SHOULD BE MADE BASED ON INDIVIDUAL APPLICATION.

WELD PINS

MADE TO ORDER

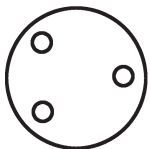

Bottom Projection Weld Pin

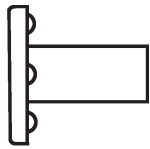

Top Projection Weld Pin

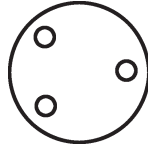

Bottom Projection Weld Screw

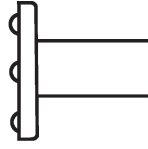

Top Projection Weld Screw

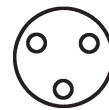

CONTACT PLANT FOR PRICING AND AVAILABILITY.

MOST SIZES AVAILABLE IMMEDIATELY • \$2 LINE REQUESTED • CALL PLANT FOR QUANTITY DISCOUNTS