

LYNCH			
MANUFACTURER CROSS-REFERENCE			
ITW/Bee-Leitzke	63	Pivot Point	HANG
Miller	QP		

LP	Nominal (D)		Effective Length (EL)		Shank Length (SL)	Wire Diameter (T)	WEIGHT Lbs. per 100 Pieces	MATERIAL		
	DIAMETER		LENGTH					Zinc Yellow "LP-"	With Chain & Cotter "LPC-"	
-187-1000	3/16	.1875 .186	1		.020/- .000	1-1/4	.118	3.21		
-187-1250			1-1/4			1-9/16	.138	4.68		
-187-1312			1-5/16			1-9/16	.138	4.75		
-250-1250	1/4	.250 .248	1-1/4		1-9/16	.138	5.60			
-250-1312			1-5/16		1-3/4	.138	5.75			
-312-1250			1-1/4		1-9/16	.138	6.95			
-312-1375	5/16	.3125 .311	1-3/8		1-3/4	.138	7.50			
-312-1750			1-3/4		2	.138	9.00			
-437-1343			1-11/32		1-9/16	.138	11.00			
-437-1343A	7/16	.4375 .436	1-11/32		1-31/32	.138	12.17			
-437-1375			1-3/8		1-3/4	.138	11.50			
-437-1500A-H			1-1/2		1-3/4	.177	12.43			
-437-1500B-H			1-1/2		1-31/32	.177	13.61			
-437-1625			1-5/8		1-15/16	.138	12.25			
-437-1750-H			1-3/4		2-1/4	.177	14.20			

FOR SQUARE SHAFTS

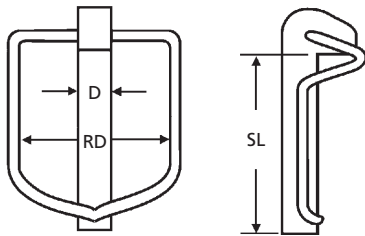

CLICK			
MANUFACTURER CROSS-REFERENCE			

LPK	Diameter (D)		Shank Length (SL)		Ring Diameter (RD)	WEIGHT Lbs per 100 pieces	MATERIAL	
	Diameter (D)		Length (SL)				Zinc Yellow "LPK-"	With Chain & Cotter "LPKC-"
-437-2000	7/16 x 11/32		2		1-3/4	12.00		

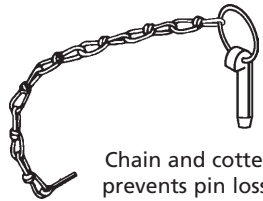
	DESCRIPTION	GENERAL USE	HOW TO IDENTIFY	APPLICATION
LP	<p>A solid pin with an attached self-locking ring that snaps down firmly to hold the part securely in place. The pins are also available with a heavy duty ring for more extreme applications.</p> <p style="text-align: center; background-color: #ff0000; color: white; font-weight: bold; margin-top: 10px;">LYNCH</p>	 COMMON	<ol style="list-style-type: none"> 1. Verify pin with attached self-locking ring. 2. Measure diameter (D). 3. Measure effective length (EL). 4. Find the part in the chart above. <p style="text-align: center; background-color: #ffcc99; font-weight: bold; margin-top: 10px;">TYPICAL PART NUMBER SEQUENCE:</p> <p style="text-align: center; font-size: 10pt;">LP-187-1000 is a 3/16" x 1" zinc yellow lynch pin.</p>	 Chain and cotter prevents pin loss.
PERFORMANCE RESULTS VARY. YOUR PIN SELECTION SHOULD BE MADE BASED ON INDIVIDUAL APPLICATION.				

ADDITIONAL TECHNICAL DATA ON PAGE 26.

ASSORTMENTS BEGIN

Page 286

LPM

METRIC
Page 186

MOST SIZES AVAILABLE IMMEDIATELY • \$2 LINE REQUESTED • CALL PLANT FOR QUANTITY DISCOUNTS

All manufacturer names and numbers are for identification purposes only. In no way are we implying that our parts were made by the manufacturers listed above. Prices, materials, tolerances, and grades subject to change without notice.