

EXTREMELY LOW NOISE
EASY INSTALLATION
HIGH-SPEED OPERATION
ECONOMICAL DESIGN

PHONE: 516.328.3300 • FAX: 516.326.8827 • WWW.SDP-SI.COM



➤ MATERIAL:

- Guide Wheels - Acetal Polymer
- Plate - Aluminum, Clear Anodized
- Bearings - Stainless Steel Ball

Dimensions in () are inch.

Direction of arrow, on carriage plate, indicates how the load should be oriented to achieve radial loading on the two concentric guide wheels.

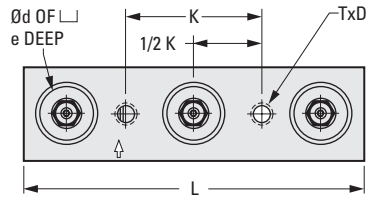
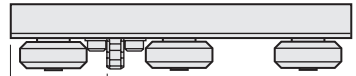
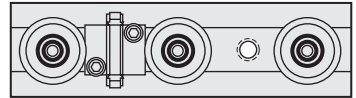
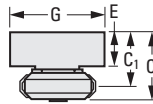
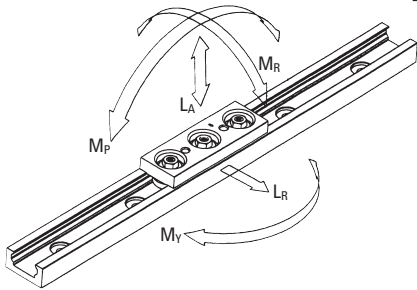

The projections shown are per ISO convention.

METRIC COMPONENT

Catalog Number	Size	L Assy. Length	C Assy. Height	E Plate Height	C ₁ Wheel Height	G Assy. Width	K Hole Spacing	T Fast. Size	D Fast. Depth (max)
A 7P86M1	1	100 (3.94)	19.5 (.77)	9 (.35)	15.2 (.6)	28 (1.1)	40 (1.57)	M6x1	10.1 (.4)
A 7P86M2	2	125 (4.92)	26.5 (1.04)	13 (.51)	20.8 (.82)	42 (1.65)	45 (1.77)	M8x1.25	13.7 (.54)

Catalog Number (Ref.)	d C'Bore Dia.	e C'Bore Depth	A Lubricator Location	L _A Axial Working Load Capacity N (lbf)	L _R Radial Working Load Capacity N (lbf)	M _P Pitch Moment Capacity Nm (lb • in)	M _Y Yaw Moment Capacity Nm (lb • in)	M _R Roll Moment Capacity Nm (lb • in)
A 7P86M1	19 (.75)	5 (.2)	28.4 (1.12)	177 (39.8)	89 (20)	10 (88.5)	3 (26.6)	2 (17.7)
A 7P86M2	25 (.98)	8.5 (.33)	37.3 (1.47)	222 (49.9)	177 (39.8)	18 (159.3)	8 (70.8)	4 (35.4)

NOTE: Load Capacity is based on 100 km service life.