

**PME
MAGNETIC INDUCTIVE FLOWMETER/SWITCH**



Flow
Pressure
Level
Temperature
measurement
monitoring
control



- **Flow Transmitter & Switch**
- **Economical Installation**
- **Installation in Pipe From 1"**
- **Fail-Safe Measuring System**
- **Easy To Service**

S5



USA

KOBOLD Instruments Inc.
1801 Parkway View Drive
USA-Pittsburgh, PA 15205
☎ +1 412-788-2830
Fax +1 412-788-4890
E-mail: info@koboldusa.com



CANADA

KOBOLD Instruments Canada Inc.
9A Aviation
Pointe-Claire, QC H9R 4Z2
☎ +1 514-428-8090
Fax +1 514-428-8899
E-mail: kobold@kobold.ca

Visit KOBOLD Online at
www.kobold.com

Model:
PME



Features

- Flow Transmitter & Switch
- Economical Installation
- Installation in Pipe From 1"
- Fail-Safe Measuring System
- Easy To Service

The KOBOLD PME series insertion magnetic inductive flowmeter is the perfect solution for accurately measuring the flow of conductive liquids in pipes. The insertion design allows installation into large pipes much more economically than installation of an in-line magmeter. The PME can be provided with weld sleeves for carbon steel, stainless steel or PVC pipes from 1 to 12 inch diameters. A 4-20 mA flow transmitter and adjustable relay are standard.

Specifications

Input Power: 24 VDC, 2.5 watts
Current Output: 4-20 mA, active bi-directional measurement, output is always positive
Relay Output: SPDT adjustable setpoint
 60 VAC/0.4 A
 75 VDC/0.5 A

Ambient Temperature: 140°F Max.
Medium Temperature Carbon Steel & Stainless Steel Sleeve: 0-212°F
PVC Sleeve: 0-140°F
Pressure Carbon Steel & Stainless Steel Sleeve: 230 PSIG @ 75°F
PVC Sleeve: 145 PSIG @ 75°F
Transmitter Span: 1-5 meter/sec. (adjustable)
Accuracy: ±2% of velocity at the measuring electrode
Repeatability: ±2% of measured value
Min. Conductivity: >20µS/cm
Noise Immunity: CE per EN 50081-1-2 and EN 50082-1-2
Protection Type: NEMA 4X/ IP 65

Materials

Sensor Tip: PVDF, Viton O-ring
Electrodes: 316 L stainless steel

DIMENSIONS

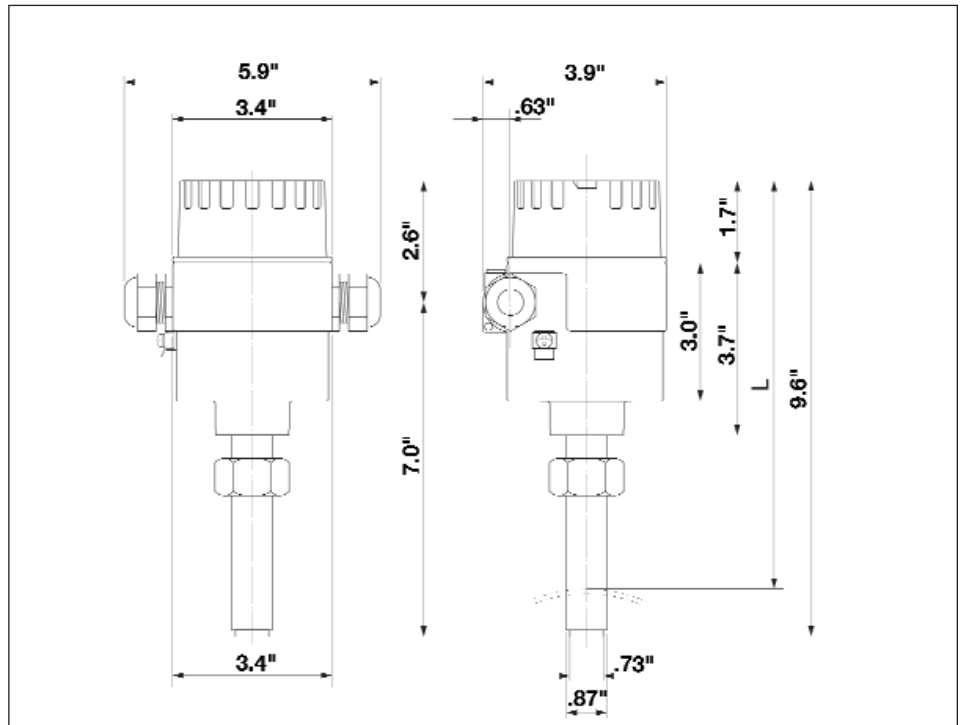

L: from 9.3" for 1" pipe to 7.9" for 12" pipe

Measuring Probe: 316L stainless steel
Case: Aluminum, epoxy powder coated
Weld Sleeve: 316L SS, carbon steel or PVC
Seal: Buna-N
Weight: Approx. 2.6 LB

Installation

The magnetic inductive flow meter is installed with the accompanying weldable connecting sleeves. The device can be delivered with mounting sleeves for pipes of 1" diameter, or for pipes from 1.5" to 12" diameters.

Ordering Information

Order No.	
PME-12R25	Flow transmitter with 316L stainless steel sleeve for 1 inch pipes
PME-13R25	Flow transmitter with carbon steel weld sleeve for 1 inch pipe
PME-12R40	Flow transmitter with 316L stainless steel weld sleeve for pipes 1.5 to 12 inches
PME-13R40	Flow transmitter with carbon steel weld sleeve for pipes 1.5 to 12 inches
PME-14R40	Flow transmitter with PVC weld sleeve for 1.5 to 12 inches