



Series
TDST

Thermodynamic Steam Trap

Compact, Works in Any Position

Size	A	B	C	D	Size	A	B	C
3/8"	3" (76.2 mm)	2-3/8" (60.3 mm)	1-7/8" (47.6 mm)	1-11/16" (42.84 mm)	3/8"	2" (50.8 mm)	1-3/4" (44.5 mm)	1-3/4" (44.5 mm)
1/2"	3" (76.2 mm)	2-3/8" (60.3 mm)	1-7/8" (47.6 mm)	1-11/16" (42.84 mm)	1/2"	2-11/16" (76.2 mm)	1-3/4" (44.5 mm)	2" (50.8 mm)
4/3"	3" (76.2 mm)	2-3/8" (60.3 mm)	1-7/8" (47.6 mm)	1-11/16" (42.84 mm)	4/3"	2-13/16" (71.4 mm)	2-5/19" (58.7 mm)	2-7/16" (61.9 mm)
1"	3-1/4" (82.5 mm)	2-1/2" (63.5 mm)	2-1/8" (53.9 mm)	1-11/16" (42.84 mm)	1"	3-5/16" (84.1 mm)	2-1/2" (63.5 mm)	2-7/8" (73.0 mm)



With Strainer



No Strainer

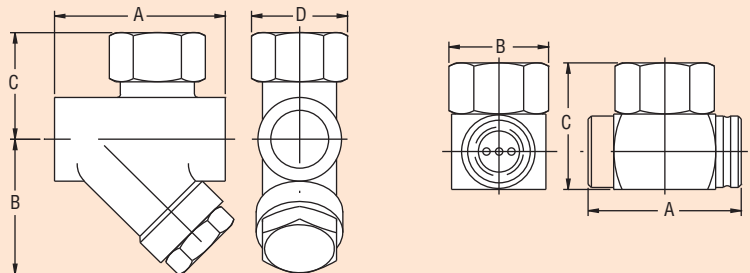

Series TDST Thermodynamic Steam Traps control steam and condensate movement to maximize removal of latent heat from steam for efficient system operation. The thermodynamic trap has cyclic on-off operation with a disk that is pushed open by incoming condensate and closes tightly when steam tries to escape. The compact design allows the steam trap to be mounted in any position and models available with an integral strainer remove the need for additional apparatus. When the trap is mounted vertically, it self-drains, making it freeze-resistant. The trap also handles water hammer, superheat, is resistant to internal and external corrosion, and is easy to install. A hardened 316 SS disc is the only moving part in the trap ensuring long service life. Audible discharge cycling makes it simple to check steam trap operation.

SPECIFICATIONS

Line Size: 3/8", 1/2", 3/4", 1".

End Connection: Female NPT.

Wetted Materials: Body: 420F SS, Cap & Disc: 416 SS, Strainer: SS.

Pressure Limit: 600 psig (41.3 bar).

Temperature Limit: 800°F (426.67°C).

Weight: See model chart.

Capacity: See capacity chart.

Model	Size	Integral Strainer	Weight lb (kg)
TDST-SSSD-N1	3/8"	No	0.8 (0.36)
TDST-SSSD-N2	1/2"	No	1.2 (0.55)
TDST-SSSD-N3	3/4"	No	1.85 (0.86)
TDST-SSSD-N4	1"	No	3.1 (1.8)
TDST-SSST-N1	3/8"	Yes	2.4 (1)
TDST-SSST-N2	1/2"	Yes	2.3 (1)
TDST-SSST-N3	3/4"	Yes	2.7 (1.2)
TDST-SSST-N4	1"	Yes	3.3 (1.5)

Capacity Chart														
TDST-SSSD Maximum Capacity - lb/hr 10°F Below Saturation														
NPT Connection	Differential Pressure psig (bar)													
	3.5 (0.24)	5 (0.34)	10 (0.7)	20 (1.4)	30 (2.1)	50 (3.4)	75 (5.2)	100 (6.9)	150 (10.3)	200 (13.8)	300 (20.7)	400 (27.6)	500 (34.5)	600 (41.3)
3/8"	180	185	190	200	215	245	305	370	500	610	790	960	1100	1250
1/2"	300	310	345	410	465	575	700	810	1000	1140	1410	1630	1830	2000
3/4"	405	420	470	560	640	810	1000	1160	1450	1670	2100	2430	2750	3050
1"	640	670	725	865	980	120	147	175	2200	2600	3250	3780	4250	4700
TDST-SSST Maximum Capacity - lb/hr 10°F Below Saturation														
NPT Connection	Differential Pressure psig (bar)													
	10 (0.7)	20 (1.4)	30 (2.1)	50 (3.4)	75 (5.2)	100 (6.9)	150 (10.3)	200 (13.8)	300 (20.7)	400 (27.6)	500 (34.5)	600 (41.4)		
3/8"	315	370	425	520	575	800	900	1080	1280	1380	1480	1650		
1/2"	315	370	425	520	575	800	900	1080	1280	1380	1480	1650		
3/4"	650	740	800	1000	1100	1400	1540	1630	1760	1930	2070	2200		
1"	650	740	800	1000	1100	1400	1540	1630	1760	1930	2070	2200		