

# Neoprene Timing Belts

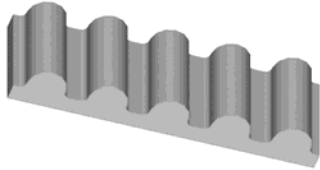

253 Castleberry Industrial Dr  
 Cumming, GA 30040  
 800-235-0947 / 770-887-9725  
 Fax: 770-887-4138  
[www.beltcorp.com](http://www.beltcorp.com)



### Standard widths:

| Width | Code |
|-------|------|
| 40MM  | 40   |
| 55MM  | 50   |
| 70MM  | 70   |
| 85MM  | 85   |
| 100MM | 100  |
| 115MM | 100  |
| 170mm | 170  |

### To order:

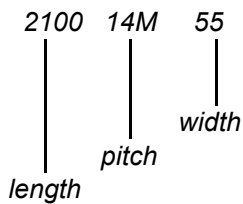

Non-standard widths  
 available on request

## 14M HTD Neoprene with Fiberglass cord

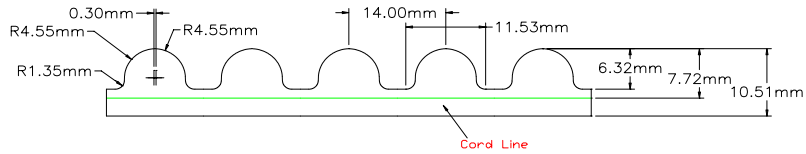

### Dimensions in millimeters

| Size     | # Teeth | Length | Size     | # Teeth | Length |
|----------|---------|--------|----------|---------|--------|
| 784-14M  | 56      | 784    | 1820-14M | 130     | 1820   |
| 798-14M  | 57      | 798    | 1890-14M | 135     | 1890   |
| 826-14M  | 59      | 826    | 1904-14M | 136     | 1904   |
| 924-14M  | 66      | 924    | 1932-14M | 138     | 1932   |
| 966-14M  | 69      | 966    | 1960-14M | 140     | 1960   |
| 1036-14M | 74      | 1036   | 2002-14M | 143     | 2002   |
| 1064-14M | 76      | 1064   | 2100-14M | 150     | 2100   |
| 1092-14M | 78      | 1092   | 2240-14M | 160     | 2240   |
| 1120-14M | 80      | 1120   | 2310-14M | 165     | 2310   |
| 1190-14M | 85      | 1190   | 2450-14M | 175     | 2450   |
| 1246-14M | 89      | 1246   | 2590-14M | 185     | 2590   |
| 1260-14M | 90      | 1260   | 2800-14M | 200     | 2800   |
| 1288-14M | 92      | 1288   | 3094-14M | 221     | 3094   |
| 1316-14M | 94      | 1316   | 3108-14M | 222     | 3108   |
| 1344-14M | 96      | 1344   | 3150-14M | 225     | 3150   |
| 1358-14M | 97      | 1358   | 3304-14M | 236     | 3304   |
| 1400-14M | 100     | 1400   | 3360-14M | 240     | 3360   |
| 1414-14M | 101     | 1414   | 3500-14M | 250     | 3500   |
| 1442-14M | 103     | 1442   | 3850-14M | 275     | 3850   |
| 1456-14M | 104     | 1456   | 4004-14M | 286     | 4004   |
| 1470-14M | 105     | 1470   | 4326-14M | 309     | 4326   |
| 1512-14M | 108     | 1512   | 4578-14M | 327     | 4578   |
| 1540-14M | 110     | 1540   | 4760-14M | 340     | 4760   |
| 1568-14M | 112     | 1568   | 4956-14M | 354     | 4956   |
| 1610-14M | 115     | 1610   | 5040-14M | 360     | 5040   |
| 1638-14M | 117     | 1638   | 5320-14M | 380     | 5320   |
| 1652-14M | 118     | 1652   | 5530-14M | 395     | 5530   |
| 1750-14M | 125     | 1750   | 5740-14M | 410     | 5740   |
| 1764-14M | 126     | 1764   | 6160-14M | 440     | 6160   |
| 1778-14M | 127     | 1778   | 6860-14M | 490     | 6860   |
| 1806-14M | 129     | 1806   |          |         |        |

Consult our sales department  
 for availability