

Neoprene Timing Belts

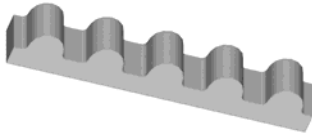

253 Castleberry Industrial Dr
 Cumming, GA 30040
 800-235-0947 / 770-887-9725
 Fax: 770-887-4138
www.beltcorp.com



Standard widths:

Width	Code
5mm	05
6mm	06
9mm	09
12mm	12
15mm	15
22mm	22
25mm	25

To order:

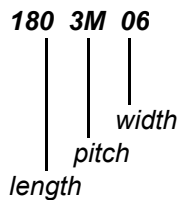

Non-standard widths
 available on request

Consult our sales department
 for availability

3M HTD Neoprene with Fiberglass cord

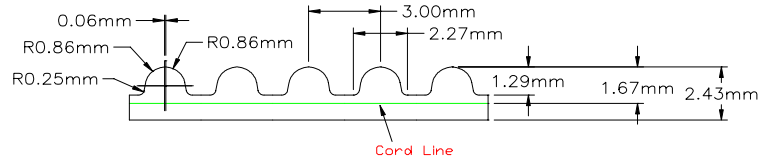

Dimensions in millimeters

Size	# Teeth	Length	Size	# Teeth	Length	Size	# Teeth	Length
60-3M	20	60	237-3M	79	237	375-3M	125	375
81-3M	27	81	240-3M	80	240	381-3M	127	381
87-3M	29	87	246-3M	82	246	384-3M	128	384
102-3M	34	102	249-3M	83	249	390-3M	130	390
105-3M	35	105	252-3M	84	252	393-3M	131	393
111-3M	37	111	255-3M	85	255	396-3M	132	396
117-3M	39	117	258-3M	86	258	399-3M	133	399
120-3M	40	120	261-3M	87	261	405-3M	135	405
123-3M	41	123	264-3M	88	264	411-3M	137	411
126-3M	42	126	267-3M	89	267	417-3M	139	417
129-3M	43	129	270-3M	90	270	420-3M	140	420
132-3M	44	132	276-3M	92	276	423-3M	141	423
141-3M	47	141	279-3M	93	279	426-3M	142	426
144-3M	48	144	282-3M	94	282	432-3M	144	432
147-3M	49	147	285-3M	95	285	435-3M	145	435
150-3M	50	150	288-3M	96	288	438-3M	146	438
153-3M	51	153	291-3M	97	291	444-3M	148	444
156-3M	52	156	294-3M	98	294	447-3M	149	447
159-3M	53	159	297-3M	99	297	459-3M	153	459
165-3M	55	165	300-3M	100	300	462-3M	154	462
168-3M	56	168	303-3M	101	303	465-3M	155	465
171-3M	57	171	306-3M	102	306	468-3M	156	468
174-3M	58	174	309-3M	103	309	471-3M	157	471
177-3M	59	177	312-3M	104	312	474-3M	158	474
180-3M	60	180	315-3M	105	315	477-3M	159	477
183-3M	61	183	318-3M	106	318	480-3M	160	480
186-3M	62	186	324-3M	108	324	483-3M	161	483
189-3M	63	189	327-3M	109	327	486-3M	162	486
192-3M	64	192	330-3M	110	330	489-3M	163	489
195-3M	65	195	333-3M	111	333	492-3M	164	492
198-3M	66	198	336-3M	112	336	495-3M	165	495
201-3M	67	201	339-3M	113	339	501-3M	167	501
204-3M	68	204	342-3M	114	342	504-3M	168	504
207-3M	69	207	345-3M	115	345	510-3M	170	510
210-3M	70	210	348-3M	116	348	513-3M	171	513
213-3M	71	213	351-3M	117	351	516-3M	172	516
216-3M	72	216	357-3M	119	357	519-3M	173	519
219-3M	73	219	360-3M	120	360	522-3M	174	522
222-3M	74	222	363-3M	121	363	525-3M	175	525
225-3M	75	225	366-3M	122	366	528-3M	176	528
228-3M	76	228	369-3M	123	369	531-3M	177	531
234-3M	78	234	372-3M	124	372	537-3M	179	537