

SERIES **955N (T) - 965N (L)** Standard Port

SERIES **956N (T) - 966N (L)** Full Port

DIRECT MOUNT 3 WAY BALL VALVE



Stainless Steel Ball Valve - Three way diverting valve with ISO 5211 pad for actuator, full port from 1/4" to 2".

- Self adjusting stem packing
- Blow-out proof stem design
- 100% air tested under water at 80 psi
- Working pressure is 1000 psi (1/4" to 1"), 800 psi (1 1/4" to 2")
- Temperature range -20° F. to 450° F.
- ISO 5211 mounting pad

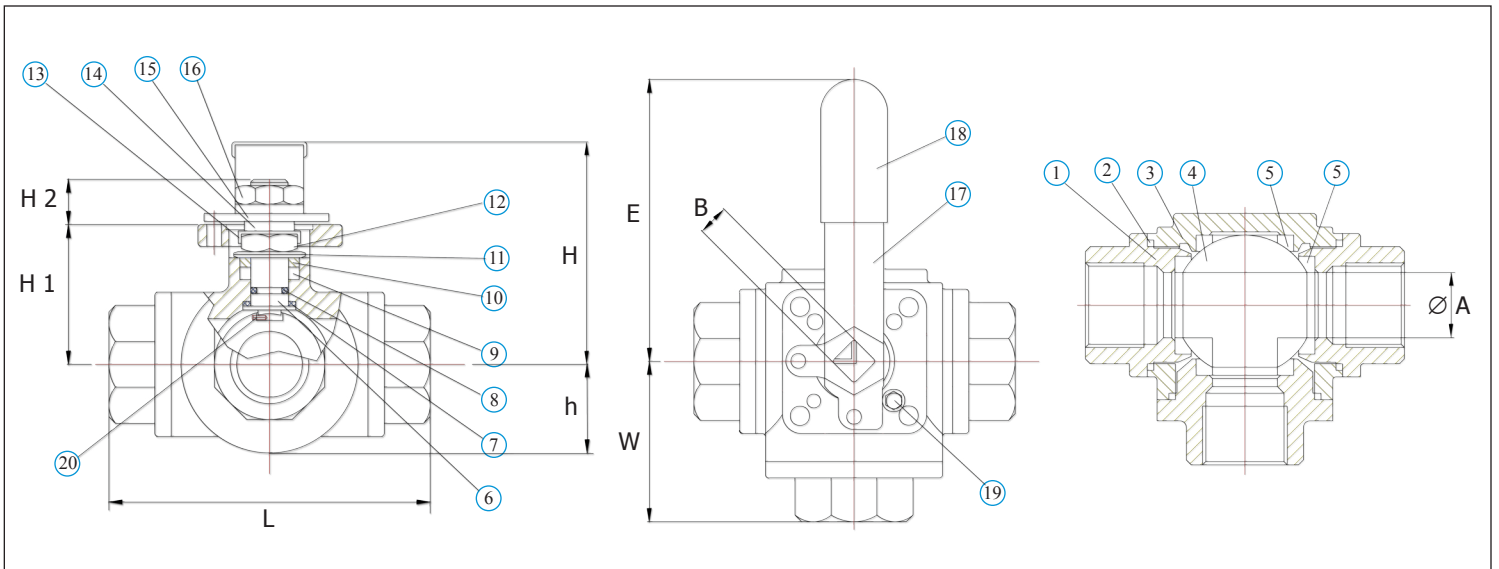

DIMENSIONS (in)

NO.	PART NAME	MATERIAL	N PCS.
1	End Cap	A351 Gr. CF8M	3
2	Gasket	P.T.F.E.	3
3	Body	A351 Gr. CF8M	1
4	Ball	SS 316	1
5	Seat	P.T.F.E./R.P.T.F.E.	4
6	Stem	SS 316	1
7	Stem Seal	R.P.T.F.E.	1
8	O-Ring	Viton	1
9	Stem Packing	P.T.F.E.	1
10	Gland	SS 304	1
11	Belleville Washer	SS 301	2
12	Stem Nut	SS 304	1
13	Nut Stop	SS 304	1
14	Space Washer	SS 304	1
15	Lock Saddle	SS 304	1
16	Handle Nut	SS 304	1
17	Handle	SS 304	1
18	Handle Sleeve	Vinyl	1
19	Stop Pin	SS 304	1
20	Insert Pin	SS 316	1

Full Port	Standard Port	Ø A	B	E	H	H 1	H 2	h	L	W	Wt. (lbs)	Break Torque	ISO5211
1/4"	—	0.43	.35	5.12	2.44	1.45	.40	0.78	2.83	1.41	1.45	105 in/lbs	F03/F04
3/8"	1/2"	0.47	.35	5.12	2.44	1.45	.40	0.78	2.83	1.41	1.41	105 in/lbs	F03/F04
1/2"	3/4"	0.59	.35	5.12	2.51	1.65	.45	0.91	3.26	1.63	1.87	138 in/lbs	F03/F04
3/4"	1"	0.78	.43	6.49	3.22	1.65	.59	1.10	3.89	1.94	3.21	184 in/lbs	F04/F05
1"	1 1/4"	0.98	.43	6.49	3.50	2.18	.55	1.33	4.40	2.20	4.80	323 in/lbs	F04/F05
1 1/4"	1 1/2"	1.25	.55	8.07	3.85	2.48	.64	1.53	4.92	2.46	7.23	461 in/lbs	F05/F07
1 1/2"	2"	1.50	.55	8.07	4.25	2.88	.62	1.88	5.86	2.93	11.55	633 in/lbs	F05/F07
2"	—	2.00	.66	12.79	5.51	3.63	.88	2.36	6.85	3.42	20.89	1,037 in/lbs	F07/F10