

DISC HAND WHEELS

Duroplastic | Without Handle | Steel & Stainless Hubs | Inch & Metric

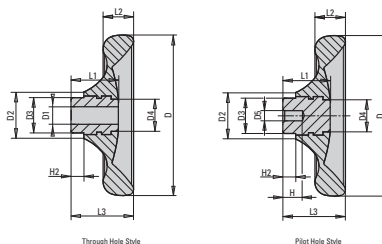

Made from black duroplastic, these solid disc hand wheels offer strength, durability and attractive appearance. The surface finish is deburred and has a high polish finish. The hand wheels with steel hubs have a nickel plated finish. The stainless hub styles have a natural finish. The pilot hole style provides a centered hole allowing the user to create different mountings configurations.

Through Hole Style

INCH										
Part # Steel Hub	Part # Stainless Hub	D	D1	D2	D3	D4	H2	L1	L2	L3
06288-1100XCM	06288-3100XCM	3.94	.250	1.14	.87	.79	.31	1.16	.75	1.54
06288-1125XCO	06288-3125XCO	4.92	.375	1.34	1.02	.83	.31	1.34	.94	1.81
06288-1140XCP	06288-3140XCP	5.51	.500	1.54	1.18	.98	.31	1.52	1.06	2.05
06288-1160XCQ	06288-3160XCQ	6.30	.625	1.69	1.30	1.18	.31	1.63	1.19	2.24
06288-1160XCR	06288-3160XCR	6.30	.750	1.69	1.30	1.18	.31	1.63	1.19	2.24

METRIC										
Part # Steel Hub	Part # Stainless Hub	D mm	D1 mm	D2 mm	D3 mm	D4 mm	H2 mm	L1 mm	L2 mm	L3 mm
06288-1100X10	06288-3100X10	100	10	29	22	20	8	29.5	19	39
06288-1125X12	06288-3125X12	125	12	34	26	21	8	34	24	46
06288-1140X14	06288-3140X14	140	14	39	30	25	8	38.5	27	52
06288-1160X16	06288-3160X16	160	16	43	33	30	8	41.3	30.1	57

Pilot Hole Style

METRIC											
Part # Steel Hub	Part # Stainless Hub	D mm	D2 mm	D3 mm	D4 mm	D5 mm	H mm	H2 mm	L1 mm	L2 mm	L3 mm
06288-0100X06	06288-2100X06	100	29	22	20	6	12	8	29.5	19	39
06288-0125X08	06288-2125X08	125	34	26	21	8	15	8	34	24	46
06288-0140X08	06288-2140X08	140	39	30	25	8	16	8	38.5	27	52
06288-0160X10	06288-2160X10	160	43	33	30	10	10	8	41.3	30.1	57

MACHINE HANDLES

Duroplastic | Revolving | Steel & Stainless Stud | Inch & Metric

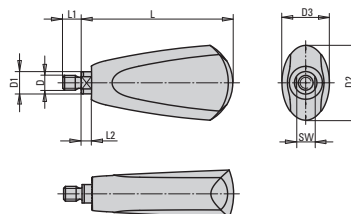

Made from black duroplastic, these revolving machine handles offer strength, durability and attractive appearance. The surface finish is deburred and has a high polish finish. The steel style has a nickel plated alloy steel stud. The stainless style has a stainless stud with a natural finish.

INCH										
Part # Steel	Part # Stainless	D	D1	D2	D3	L	L1	L2	SW	
06316-1A2009	06316-11A2009	1/4-20	.31	.98	.71	2.15	.35	.18	.28	
06316-2A3010	06316-12A3010	5/16-18	.47	1.61	1.02	3.24	.39	.22	.39	

METRIC										
Part # Steel	Part # Stainless	D mm	D1 mm	D2 mm	D3 mm	L mm	L1 mm	L2 mm	SW mm	
06316-106009	06316-1106009	M6	8	25	18	54.7	9	4.5	7	
06316-208010	06316-1208010	M8	12	41	26	82.2	10	5.5	10	