

ADJUSTABLE CLAMP HANDLES

Zinc Die Cast | Female Threads | Steel Inserts | Inch and Metric

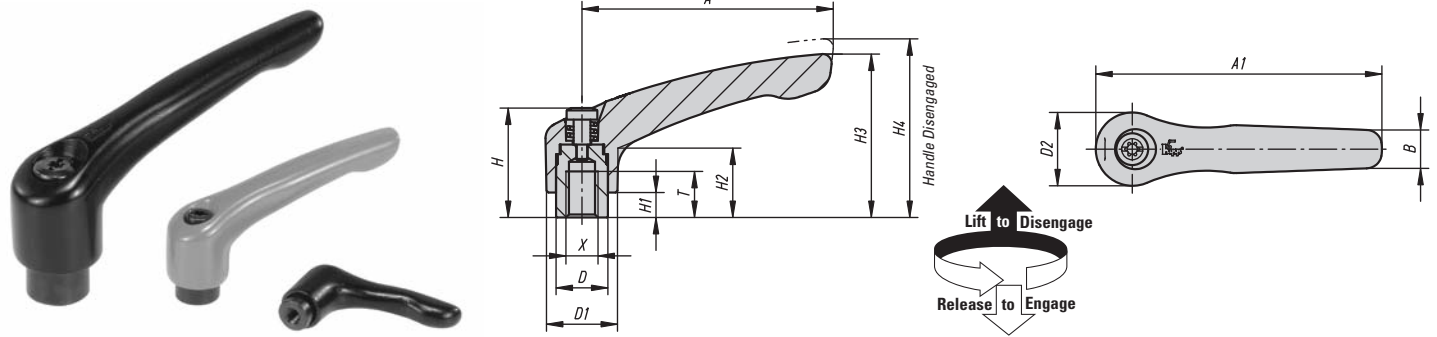

Pulling up on the handle disengages it from the spline and allows it to rotate freely for adjustment. Releasing the handle engages it for tightening or adjusting. The handles are made from zinc die cast and powder coated to a black satin finish or orange color finish. The internal steel parts are black oxidized.

INCH

Part # Black	Part # Orange	X Thread	T	D	D1	D2	H	H1	H2	H3	H4	A	A1	B	No. Of Teeth
06450-0AE1	06450-0AE2	8-32	.35	.39	.51	.55	.57	.16	.57	1.18	1.30	1.18	1.46	.28	16
06450-0A01	06450-0A02	10-24	.35	.39	.51	.55	.57	.16	.57	1.18	1.30	1.18	1.46	.28	16
06450-0A11	06450-0A12	10-32	.35	.39	.51	.55	.57	.16	.57	1.18	1.30	1.18	1.46	.28	16
06450-0A21	06450-0A22	1/4-20	.35	.39	.51	.55	.57	.16	.57	1.18	1.30	1.18	1.46	.28	16
06450-1AE1	06450-1AE2	8-32	.35	.39	.51	.55	.96	.16	.57	1.22	1.34	1.57	1.85	.28	16
06450-1A01	06450-1A02	10-24	.35	.39	.51	.55	.96	.16	.57	1.22	1.34	1.57	1.85	.28	16
06450-1A11	06450-1A12	10-32	.35	.39	.51	.55	.96	.16	.57	1.22	1.34	1.57	1.85	.28	16
06450-1A21	06450-1A22	1/4-20	.35	.39	.51	.55	.96	.16	.57	1.22	1.34	1.57	1.85	.28	16
06450-2A21	06450-2A22	1/4-20	.47	.53	.73	.75	1.12	.26	.69	1.67	1.79	2.56	2.93	.37	20
06450-2A31	06450-2A32	5/16-18	.47	.53	.73	.75	1.12	.26	.69	1.67	1.79	2.56	2.93	.37	20
06450-3A31	06450-3A32	5/16-18	.55	.63	.83	.87	1.46	.39	.94	2.15	2.30	3.15	3.58	.43	22
06450-3A41	06450-3A42	3/8-16	.55	.63	.83	.87	1.46	.39	.94	2.15	2.30	3.15	3.58	.43	22
06450-4A41	06450-4A42	3/8-16	.67	.75	1.06	1.08	1.69	.39	1.06	2.48	2.66	3.74	4.29	.51	24
06450-4A51	06450-4A52	1/2-13	.67	.75	1.06	1.08	1.69	.39	1.06	2.48	2.66	3.74	4.29	.51	24
06450-5A51	06450-5A52	1/2-13	.91	.91	1.22	1.26	1.93	.47	1.24	2.87	3.05	4.33	4.96	.59	26
06450-5A61	06450-5A62	5/8-11	.91	.91	1.22	1.26	1.93	.47	1.24	2.87	3.05	4.33	4.96	.59	26

METRIC

Part # Black	Part # Orange	X Thread	T mm	D mm	D1 mm	D2 mm	H mm	H1 mm	H2 mm	H3 mm	H4 mm	A mm	A1 mm	B mm	No. Of Teeth
06450-0031	06450-0032	M3	9	10	13	14	24.5	4	14.5	30	33	30	37	7	16
06450-0041	06450-0042	M4	9	10	13	14	24.5	4	14.5	30	33	30	37	7	16
06450-0051	06450-0052	M5	9	10	13	14	24.5	4	14.5	30	33	30	37	7	16
06450-1041	06450-1042	M4	9	10	13	14	24.5	4	14.5	31	34	40	47	7	16
06450-1051	06450-1052	M5	9	10	13	14	24.5	4	14.5	31	34	40	47	7	16
06450-1061	06450-1062	M6	9	10	13	14	24.5	4	14.5	31	34	40	47	7	16
06450-2061	06450-2062	M6	12	13.5	18.5	19	28.5	6.5	17.5	42.5	45.5	65	74.5	9.5	20
06450-2081	06450-2082	M8	12	13.5	18.5	19	28.5	6.5	17.5	42.5	45.5	65	74.5	9.5	20
06450-3081	06450-3082	M8	14	16	21	22	37	10	24	54.5	58.5	80	91	11	22
06450-3101	06450-3102	M10	14	16	21	22	37	10	24	54.5	58.5	80	91	11	22
06450-4101	06450-4102	M10	17	19	27	27.5	43	10	27	63	67.5	95	109	13	24
06450-4121	06450-4122	M12	17	19	27	27.5	43	10	27	63	67.5	95	109	13	24
06450-5121	06450-5122	M12	23	23	31	32	49	12	31.5	73	77.5	110	126	15	26
06450-5161	06450-5162	M16	23	23	31	32	49	12	31.5	73	77.5	110	126	15	26

ADJUSTABLE CLAMP HANDLES

Zinc Die Cast | Female Threads | Stainless Steel Inserts | Inch and Metric

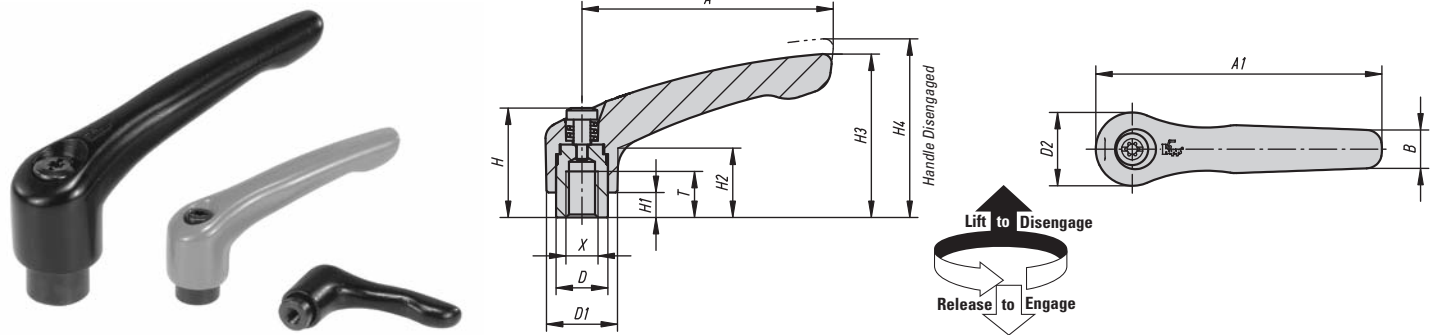

Pulling up on the handle disengages it from the spline and allows it to rotate freely for adjustment. Releasing the handle engages it for tightening or adjusting. The handles are made from zinc die cast and powder coated to a black satin finish or orange color finish. The internal parts are stainless steel.

INCH

Part # Black	Part # Orange	X Thread	T	D	D1	D2	H	H1	H2	H3	H4	A	A1	B	No. Of Teeth
06451-0A01	06451-0A02	10-24	.35	.39	.51	.55	.57	.16	.57	1.18	1.30	1.18	1.46	.28	16
06451-0A11	06451-0A12	10-32	.35	.39	.51	.55	.57	.16	.57	1.18	1.30	1.18	1.46	.28	16
06451-0A21	06451-0A22	1/4-20	.35	.39	.51	.55	.57	.16	.57	1.18	1.30	1.18	1.46	.28	16
06451-1A01	06451-1A02	10-24	.35	.39	.51	.55	.96	.16	.57	1.22	1.34	1.57	1.85	.28	16
06451-1A11	06451-1A12	10-32	.35	.39	.51	.55	.96	.16	.57	1.22	1.34	1.57	1.85	.28	16
06451-1A21	06451-1A22	1/4-20	.35	.39	.51	.55	.96	.16	.57	1.22	1.34	1.57	1.85	.28	16
06451-2A21	06451-2A22	1/4-20	.47	.53	.73	.75	1.12	.26	.69	1.67	1.79	2.56	2.93	.37	20
06451-2A31	06451-2A32	5/16-18	.47	.53	.73	.75	1.12	.26	.69	1.67	1.79	2.56	2.93	.37	20
06451-3A31	06451-3A32	5/16-18	.55	.63	.83	.87	1.46	.39	.94	2.15	2.30	3.15	3.58	.43	22
06451-3A41	06451-3A42	3/8-16	.55	.63	.83	.87	1.46	.39	.94	2.15	2.30	3.15	3.58	.43	22
06451-4A41	06451-4A42	3/8-16	.67	.75	1.06	1.08	1.69	.39	1.06	2.48	2.66	3.74	4.29	.51	24
06451-4A51	06451-4A52	1/2-13	.67	.75	1.06	1.08	1.69	.39	1.06	2.48	2.66	3.74	4.29	.51	24
06451-5A51	06451-5A52	1/2-13	.91	.91	1.22	1.26	1.93	.47	1.24	2.87	3.05	4.33	4.96	.59	26
06451-5A61	06451-5A62	5/8-11	.91	.91	1.22	1.26	1.93	.47	1.24	2.87	3.05	4.33	4.96	.59	26

METRIC

Part # Black	Part # Orange	X Thread	T mm	D mm	D1 mm	D2 mm	H mm	H1 mm	H2 mm	H3 mm	H4 mm	A mm	A1 mm	B mm	No. Of Teeth
06451-0031	06451-0032	M3	9	10	13	14	24.5	4	14.5	30	33	30	37	7	16
06451-0041	06451-0042	M4	9	10	13	14	24.5	4	14.5	30	33	30	37	7	16
06451-0051	06451-0052	M5	9	10	13	14	24.5	4	14.5	30	33	30	37	7	16
06451-1051	06451-1052	M5	9	10	13	14	24.5	4	14.5	31	34	40	47	7	16
06451-1061	06451-1062	M6	9	10	13	14	24.5	4	14.5	31	34	40	47	7	16
06451-2061	06451-2062	M6	12	13.5	18.5	19	28.5	6.5	17.5	42.5	45.5	65	74.5	9.5	20
06451-2081	06451-2082	M8	12	13.5	18.5	19	28.5	6.5	17.5	42.5	45.5	65	74.5	9.5	20
06451-3081	06451-3082	M8	14	16	21	22	37	10	24	54.5	58.5	80	91	11	22
06451-3101	06451-3102	M10	14	16	21	22	37	10	24	54.5	58.5	80	91	11	22
06451-4101	06451-4102	M10	17	19	27	27.5	43	10	27	63	67.5	95	109	13	24
06451-4121	06451-4122	M12	17	19	27	27.5	43	10	27	63	67.5	95	109	13	24
06451-5121	06451-5122	M12	23	23	31	32	49	12	31.5	73	77.5	110	126	15	26
06451-5161	06451-5162	M16	23	23	31	32	49	12	31.5	73	77.5	110	126	15	26

ADJUSTABLE CLAMP HANDLES

Zinc Die Cast | Male Threads | Steel Studs | Inch

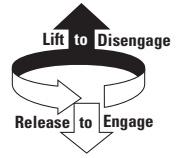
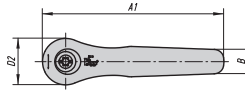
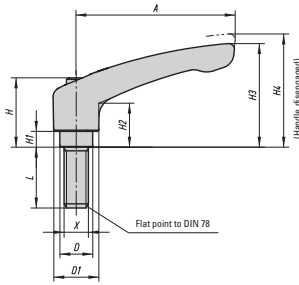

Pulling up on the handle disengages it from the spline and allows it to rotate freely for adjustment. Releasing the handle engages it for tightening or adjusting. The handle is made from zinc die cast and powder coated in either black satin or orange color finish. Internal parts and studs are made from steel with black oxide finish.

INCH

Part # Black	Part # Orange	X Thread	L	D	D1	D2	H	H1	H2	H3	H4	A	A1	B	No. Of Teeth
06460-0A01X10	06460-0A02X10	10-24	.39	.39	.51	.55	.96	.16	.57	1.18	1.30	1.18	1.46	.28	16
06460-0A01X15	06460-0A02X15	10-24	.59	.39	.51	.55	.96	.16	.57	1.18	1.30	1.18	1.46	.28	16
06460-0A01X20	06460-0A02X20	10-24	.79	.39	.51	.55	.96	.16	.57	1.18	1.30	1.18	1.46	.28	16
06460-0A01X25	06460-0A02X25	10-24	.98	.39	.51	.55	.96	.16	.57	1.18	1.30	1.18	1.46	.28	16
06460-0A01X30	06460-0A02X30	10-24	1.18	.39	.51	.55	.96	.16	.57	1.18	1.30	1.18	1.46	.28	16
06460-0A01X35	06460-0A02X35	10-24	1.38	.39	.51	.55	.96	.16	.57	1.18	1.30	1.18	1.46	.28	16
06460-0A01X40	06460-0A02X40	10-24	1.57	.39	.51	.55	.96	.16	.57	1.18	1.30	1.18	1.46	.28	16
06460-0A01X45	06460-0A02X45	10-24	1.77	.39	.51	.55	.96	.16	.57	1.18	1.30	1.18	1.46	.28	16
06460-0A01X50	06460-0A02X50	10-24	1.97	.39	.51	.55	.96	.16	.57	1.18	1.30	1.18	1.46	.28	16
06460-0A11X10	06460-0A12X10	10-32	.39	.39	.51	.55	.96	.16	.57	1.18	1.30	1.18	1.46	.28	16
06460-0A11X15	06460-0A12X15	10-32	.59	.39	.51	.55	.96	.16	.57	1.18	1.30	1.18	1.46	.28	16
06460-0A11X20	06460-0A12X20	10-32	.79	.39	.51	.55	.96	.16	.57	1.18	1.30	1.18	1.46	.28	16
06460-0A11X25	06460-0A12X25	10-32	.98	.39	.51	.55	.96	.16	.57	1.18	1.30	1.18	1.46	.28	16
06460-0A11X30	06460-0A12X30	10-32	1.18	.39	.51	.55	.96	.16	.57	1.18	1.30	1.18	1.46	.28	16
06460-0A11X35	06460-0A12X35	10-32	1.38	.39	.51	.55	.96	.16	.57	1.18	1.30	1.18	1.46	.28	16
06460-0A11X40	06460-0A12X40	10-32	1.57	.39	.51	.55	.96	.16	.57	1.18	1.30	1.18	1.46	.28	16
06460-0A11X45	06460-0A12X45	10-32	1.77	.39	.51	.55	.96	.16	.57	1.18	1.30	1.18	1.46	.28	16
06460-0A11X50	06460-0A12X50	10-32	1.97	.39	.51	.55	.96	.16	.57	1.18	1.30	1.18	1.46	.28	16
06460-0A21X10	06460-0A22X10	1/4-20	.39	.39	.51	.55	.96	.16	.57	1.18	1.30	1.18	1.46	.28	16
06460-0A21X15	06460-0A22X15	1/4-20	.59	.39	.51	.55	.96	.16	.57	1.18	1.30	1.18	1.46	.28	16
06460-0A21X20	06460-0A22X20	1/4-20	.79	.39	.51	.55	.96	.16	.57	1.18	1.30	1.18	1.46	.28	16
06460-0A21X25	06460-0A22X25	1/4-20	.98	.39	.51	.55	.96	.16	.57	1.18	1.30	1.18	1.46	.28	16
06460-0A21X30	06460-0A22X30	1/4-20	1.18	.39	.51	.55	.96	.16	.57	1.18	1.30	1.18	1.46	.28	16
06460-0A21X35	06460-0A22X35	1/4-20	1.38	.39	.51	.55	.96	.16	.57	1.18	1.30	1.18	1.46	.28	16
06460-0A21X40	06460-0A22X40	1/4-20	1.57	.39	.51	.55	.96	.16	.57	1.18	1.30	1.18	1.46	.28	16
06460-0A21X45	06460-0A22X45	1/4-20	1.77	.39	.51	.55	.96	.16	.57	1.18	1.30	1.18	1.46	.28	16
06460-0A21X50	06460-0A22X50	1/4-20	1.97	.39	.51	.55	.96	.16	.57	1.18	1.30	1.18	1.46	.28	16
06460-1A01X10	06460-1A02X10	10-24	.39	.39	.51	.55	.96	.16	.57	1.22	1.34	1.57	1.85	.28	16
06460-1A01X15	06460-1A02X15	10-24	.59	.39	.51	.55	.96	.16	.57	1.22	1.34	1.57	1.85	.28	16
06460-1A01X20	06460-1A02X20	10-24	.79	.39	.51	.55	.96	.16	.57	1.22	1.34	1.57	1.85	.28	16
06460-1A01X25	06460-1A02X25	10-24	.98	.39	.51	.55	.96	.16	.57	1.22	1.34	1.57	1.85	.28	16
06460-1A01X30	06460-1A02X30	10-24	1.18	.39	.51	.55	.96	.16	.57	1.22	1.34	1.57	1.85	.28	16
06460-1A01X35	06460-1A02X35	10-24	1.38	.39	.51	.55	.96	.16	.57	1.22	1.34	1.57	1.85	.28	16
06460-1A01X40	06460-1A02X40	10-24	1.57	.39	.51	.55	.96	.16	.57	1.22	1.34	1.57	1.85	.28	16
06460-1A01X45	06460-1A02X45	10-24	1.77	.39	.51	.55	.96	.16	.57	1.22	1.34	1.57	1.85	.28	16
06460-1A01X50	06460-1A02X50	10-24	1.97	.39	.51	.55	.96	.16	.57	1.22	1.34	1.57	1.85	.28	16
06460-1A11X10	06460-1A12X10	10-32	.39	.39	.51	.55	.96	.16	.57	1.22	1.34	1.57	1.85	.28	16
06460-1A11X15	06460-1A12X15	10-32	.59	.39	.51	.55	.96	.16	.57	1.22	1.34	1.57	1.85	.28	16
06460-1A11X20	06460-1A12X20	10-32	.79	.39	.51	.55	.96	.16	.57	1.22	1.34	1.57	1.85	.28	16
06460-1A11X25	06460-1A12X25	10-32	.98	.39	.51	.55	.96	.16	.57	1.22	1.34	1.57	1.85	.28	16
06460-1A11X30	06460-1A12X30	10-32	1.18	.39	.51	.55	.96	.16	.57	1.22	1.34	1.57	1.85	.28	16
06460-1A11X35	06460-1A12X35	10-32	1.38	.39	.51	.55	.96	.16	.57	1.22	1.34	1.57	1.85	.28	16
06460-1A11X40	06460-1A12X40	10-32	1.57	.39	.51	.55	.96	.16	.57	1.22	1.34	1.57	1.85	.28	16
06460-1A11X45	06460-1A12X45	10-32	1.77	.39	.51	.55	.96	.16	.57	1.22	1.34	1.57	1.85	.28	16
06460-1A11X50	06460-1A12X50	10-32	1.97	.39	.51	.55	.96	.16	.57	1.22	1.34	1.57	1.85	.28	16

ADJUSTABLE CLAMP HANDLES

Zinc Die Cast | Male Threads | Steel Studs | Inch (continued)

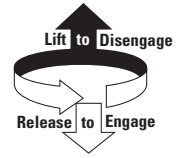
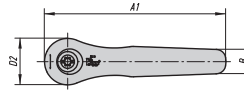
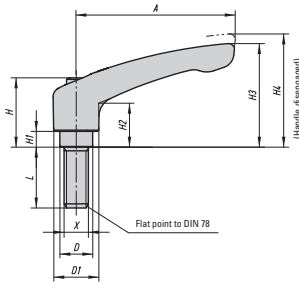

INCH (CONTINUED)

Part # Black	Part # Orange	X Thread	L	D	D1	D2	H	H1	H2	H3	H4	A	A1	B	No. Of Teeth
06460-1A21X10	06460-1A22X10	1/4-20	.39	.39	.51	.55	.96	.16	.57	1.22	1.34	1.57	1.85	.28	16
06460-1A21X15	06460-1A22X15	1/4-20	.59	.39	.51	.55	.96	.16	.57	1.22	1.34	1.57	1.85	.28	16
06460-1A21X20	06460-1A22X20	1/4-20	.79	.39	.51	.55	.96	.16	.57	1.22	1.34	1.57	1.85	.28	16
06460-1A21X25	06460-1A22X25	1/4-20	.98	.39	.51	.55	.96	.16	.57	1.22	1.34	1.57	1.85	.28	16
06460-1A21X30	06460-1A22X30	1/4-20	1.18	.39	.51	.55	.96	.16	.57	1.22	1.34	1.57	1.85	.28	16
06460-1A21X35	06460-1A22X35	1/4-20	1.38	.39	.51	.55	.96	.16	.57	1.22	1.34	1.57	1.85	.28	16
06460-1A21X40	06460-1A22X40	1/4-20	1.57	.39	.51	.55	.96	.16	.57	1.22	1.34	1.57	1.85	.28	16
06460-1A21X45	06460-1A22X45	1/4-20	1.77	.39	.51	.55	.96	.16	.57	1.22	1.34	1.57	1.85	.28	16
06460-1A21X50	06460-1A22X50	1/4-20	1.97	.39	.51	.55	.96	.16	.57	1.22	1.34	1.57	1.85	.28	16
06460-2A21X15	06460-2A22X15	1/4-20	.59	.53	.73	.75	1.12	.26	.69	1.67	1.79	2.56	2.93	.37	20
06460-2A21X20	06460-2A22X20	1/4-20	.79	.53	.73	.75	1.12	.26	.69	1.67	1.79	2.56	2.93	.37	20
06460-2A21X25	06460-2A22X25	1/4-20	.98	.53	.73	.75	1.12	.26	.69	1.67	1.79	2.56	2.93	.37	20
06460-2A21X30	06460-2A22X30	1/4-20	1.18	.53	.73	.75	1.12	.26	.69	1.67	1.79	2.56	2.93	.37	20
06460-2A21X35	06460-2A22X35	1/4-20	1.38	.53	.73	.75	1.12	.26	.69	1.67	1.79	2.56	2.93	.37	20
06460-2A21X40	06460-2A22X40	1/4-20	1.57	.53	.73	.75	1.12	.26	.69	1.67	1.79	2.56	2.93	.37	20
06460-2A21X45	06460-2A22X45	1/4-20	1.77	.53	.73	.75	1.12	.26	.69	1.67	1.79	2.56	2.93	.37	20
06460-2A21X50	06460-2A22X50	1/4-20	1.97	.53	.73	.75	1.12	.26	.69	1.67	1.79	2.56	2.93	.37	20
06460-2A21X55	06460-2A22X55	1/4-20	2.17	.53	.73	.75	1.12	.26	.69	1.67	1.79	2.56	2.93	.37	20
06460-2A21X60	06460-2A22X60	1/4-20	2.36	.53	.73	.75	1.12	.26	.69	1.67	1.79	2.56	2.93	.37	20
06460-2A31X15	06460-2A32X15	5/16-18	.59	.53	.73	.75	1.12	.26	.69	1.67	1.79	2.56	2.93	.37	20
06460-2A31X20	06460-2A32X20	5/16-18	.79	.53	.73	.75	1.12	.26	.69	1.67	1.79	2.56	2.93	.37	20
06460-2A31X25	06460-2A32X25	5/16-18	.98	.53	.73	.75	1.12	.26	.69	1.67	1.79	2.56	2.93	.37	20
06460-2A31X30	06460-2A32X30	5/16-18	1.18	.53	.73	.75	1.12	.26	.69	1.67	1.79	2.56	2.93	.37	20
06460-2A31X35	06460-2A32X35	5/16-18	1.38	.53	.73	.75	1.12	.26	.69	1.67	1.79	2.56	2.93	.37	20
06460-2A31X40	06460-2A32X40	5/16-18	1.57	.53	.73	.75	1.12	.26	.69	1.67	1.79	2.56	2.93	.37	20
06460-2A31X45	06460-2A32X45	5/16-18	1.77	.53	.73	.75	1.12	.26	.69	1.67	1.79	2.56	2.93	.37	20
06460-2A31X50	06460-2A32X50	5/16-18	1.97	.53	.73	.75	1.12	.26	.69	1.67	1.79	2.56	2.93	.37	20
06460-2A31X55	06460-2A32X55	5/16-18	2.17	.53	.73	.75	1.12	.26	.69	1.67	1.79	2.56	2.93	.37	20
06460-2A31X60	06460-2A32X60	5/16-18	2.36	.53	.73	.75	1.12	.26	.69	1.67	1.79	2.56	2.93	.37	20
06460-2A41X15	06460-2A42X15	3/8-16	.59	.53	.73	.75	1.12	.26	.69	1.67	1.79	2.56	2.93	.37	20
06460-2A41X20	06460-2A42X20	3/8-16	.79	.53	.73	.75	1.12	.26	.69	1.67	1.79	2.56	2.93	.37	20
06460-2A41X25	06460-2A42X25	3/8-16	.98	.53	.73	.75	1.12	.26	.69	1.67	1.79	2.56	2.93	.37	20
06460-2A41X30	06460-2A42X30	3/8-16	1.18	.53	.73	.75	1.12	.26	.69	1.67	1.79	2.56	2.93	.37	20
06460-2A41X35	06460-2A42X35	3/8-16	1.38	.53	.73	.75	1.12	.26	.69	1.67	1.79	2.56	2.93	.37	20
06460-2A41X40	06460-2A42X40	3/8-16	1.57	.53	.73	.75	1.12	.26	.69	1.67	1.79	2.56	2.93	.37	20
06460-2A41X45	06460-2A42X45	3/8-16	1.77	.53	.73	.75	1.12	.26	.69	1.67	1.79	2.56	2.93	.37	20
06460-2A41X50	06460-2A42X50	3/8-16	1.97	.53	.73	.75	1.12	.26	.69	1.67	1.79	2.56	2.93	.37	20
06460-2A41X55	06460-2A42X55	3/8-16	2.17	.53	.73	.75	1.12	.26	.69	1.67	1.79	2.56	2.93	.37	20
06460-2A41X60	06460-2A42X60	3/8-16	2.36	.53	.73	.75	1.12	.26	.69	1.67	1.79	2.56	2.93	.37	20
06460-3A31X15	06460-3A32X15	5/16-18	.59	.63	.83	.87	1.46	.39	.94	2.15	2.30	3.15	3.58	.43	22
06460-3A31X20	06460-3A32X20	5/16-18	.79	.63	.83	.87	1.46	.39	.94	2.15	2.30	3.15	3.58	.43	22
06460-3A31X25	06460-3A32X25	5/16-18	.98	.63	.83	.87	1.46	.39	.94	2.15	2.30	3.15	3.58	.43	22
06460-3A31X30	06460-3A32X30	5/16-18	1.18	.63	.83	.87	1.46	.39	.94	2.15	2.30	3.15	3.58	.43	22
06460-3A31X35	06460-3A32X35	5/16-18	1.38	.63	.83	.87	1.46	.39	.94	2.15	2.30	3.15	3.58	.43	22
06460-3A31X40	06460-3A32X40	5/16-18	1.57	.63	.83	.87	1.46	.39	.94	2.15	2.30	3.15	3.58	.43	22
06460-3A31X45	06460-3A32X45	5/16-18	1.77	.63	.83	.87	1.46	.39	.94	2.15	2.30	3.15	3.58	.43	22
06460-3A31X50	06460-3A32X50	5/16-18	1.97	.63	.83	.87	1.46	.39	.94	2.15	2.30	3.15	3.58	.43	22
06460-3A31X55	06460-3A32X55	5/16-18	2.17	.63	.83	.87	1.46	.39	.94	2.15	2.30	3.15	3.58	.43	22
06460-3A31X60	06460-3A32X60	5/16-18	2.36	.63	.83	.87	1.46	.39	.94	2.15	2.30	3.15	3.58	.43	22



ADJUSTABLE CLAMP HANDLES

Zinc Die Cast | Male Threads | Steel Studs | Inch (continued)

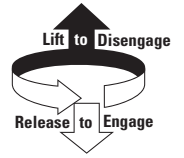
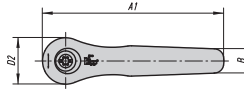
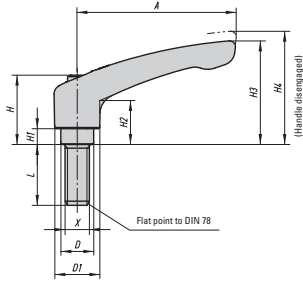

INCH (CONTINUED)

Part #	Part #	X	L	D	D1	D2	H	H1	H2	H3	H4	A	A1	B	No. Of Teeth
Black	Orange	Thread													
06460-3A41X15	06460-3A42X15	3/8-16	.59	.63	.83	.87	1.46	.39	.94	2.15	2.30	3.15	3.58	.43	22
06460-3A41X20	06460-3A42X20	3/8-16	.79	.63	.83	.87	1.46	.39	.94	2.15	2.30	3.15	3.58	.43	22
06460-3A41X25	06460-3A42X25	3/8-16	.98	.63	.83	.87	1.46	.39	.94	2.15	2.30	3.15	3.58	.43	22
06460-3A41X30	06460-3A42X30	3/8-16	1.18	.63	.83	.87	1.46	.39	.94	2.15	2.30	3.15	3.58	.43	22
06460-3A41X35	06460-3A42X35	3/8-16	1.38	.63	.83	.87	1.46	.39	.94	2.15	2.30	3.15	3.58	.43	22
06460-3A41X40	06460-3A42X40	3/8-16	1.57	.63	.83	.87	1.46	.39	.94	2.15	2.30	3.15	3.58	.43	22
06460-3A41X45	06460-3A42X45	3/8-16	1.77	.63	.83	.87	1.46	.39	.94	2.15	2.30	3.15	3.58	.43	22
06460-3A41X50	06460-3A42X50	3/8-16	1.97	.63	.83	.87	1.46	.39	.94	2.15	2.30	3.15	3.58	.43	22
06460-3A41X55	06460-3A42X55	3/8-16	2.17	.63	.83	.87	1.46	.39	.94	2.15	2.30	3.15	3.58	.43	22
06460-3A41X60	06460-3A42X60	3/8-16	2.36	.63	.83	.87	1.46	.39	.94	2.15	2.30	3.15	3.58	.43	22
06460-4A41X20	06460-4A42X20	3/8-16	.79	.75	1.06	1.08	1.69	.39	1.06	2.48	2.66	3.74	4.29	.51	24
06460-4A41X25	06460-4A42X25	3/8-16	.98	.75	1.06	1.08	1.69	.39	1.06	2.48	2.66	3.74	4.29	.51	24
06460-4A41X30	06460-4A42X30	3/8-16	1.18	.75	1.06	1.08	1.69	.39	1.06	2.48	2.66	3.74	4.29	.51	24
06460-4A41X35	06460-4A42X35	3/8-16	1.38	.75	1.06	1.08	1.69	.39	1.06	2.48	2.66	3.74	4.29	.51	24
06460-4A41X40	06460-4A42X40	3/8-16	1.57	.75	1.06	1.08	1.69	.39	1.06	2.48	2.66	3.74	4.29	.51	24
06460-4A41X45	06460-4A42X45	3/8-16	1.77	.75	1.06	1.08	1.69	.39	1.06	2.48	2.66	3.74	4.29	.51	24
06460-4A41X50	06460-4A42X50	3/8-16	1.97	.75	1.06	1.08	1.69	.39	1.06	2.48	2.66	3.74	4.29	.51	24
06460-4A41X55	06460-4A42X55	3/8-16	2.17	.75	1.06	1.08	1.69	.39	1.06	2.48	2.66	3.74	4.29	.51	24
06460-4A41X60	06460-4A42X60	3/8-16	2.36	.75	1.06	1.08	1.69	.39	1.06	2.48	2.66	3.74	4.29	.51	24
06460-4A41X70	06460-4A42X70	3/8-16	2.76	.75	1.06	1.08	1.69	.39	1.06	2.48	2.66	3.74	4.29	.51	24
06460-4A41X80	06460-4A42X80	3/8-16	3.15	.75	1.06	1.08	1.69	.39	1.06	2.48	2.66	3.74	4.29	.51	24
06460-4A41X90	06460-4A42X90	3/8-16	3.54	.75	1.06	1.08	1.69	.39	1.06	2.48	2.66	3.74	4.29	.51	24
06460-4A51X20	06460-4A52X20	1/2-13	.79	.75	1.06	1.08	1.69	.39	1.06	2.48	2.66	3.74	4.29	.51	24
06460-4A51X25	06460-4A52X25	1/2-13	.98	.75	1.06	1.08	1.69	.39	1.06	2.48	2.66	3.74	4.29	.51	24
06460-4A51X30	06460-4A52X30	1/2-13	1.18	.75	1.06	1.08	1.69	.39	1.06	2.48	2.66	3.74	4.29	.51	24
06460-4A51X35	06460-4A52X35	1/2-13	1.38	.75	1.06	1.08	1.69	.39	1.06	2.48	2.66	3.74	4.29	.51	24
06460-4A51X40	06460-4A52X40	1/2-13	1.57	.75	1.06	1.08	1.69	.39	1.06	2.48	2.66	3.74	4.29	.51	24
06460-4A51X45	06460-4A52X45	1/2-13	1.77	.75	1.06	1.08	1.69	.39	1.06	2.48	2.66	3.74	4.29	.51	24
06460-4A51X50	06460-4A52X50	1/2-13	1.97	.75	1.06	1.08	1.69	.39	1.06	2.48	2.66	3.74	4.29	.51	24
06460-4A51X55	06460-4A52X55	1/2-13	2.17	.75	1.06	1.08	1.69	.39	1.06	2.48	2.66	3.74	4.29	.51	24
06460-4A51X60	06460-4A52X60	1/2-13	2.36	.75	1.06	1.08	1.69	.39	1.06	2.48	2.66	3.74	4.29	.51	24
06460-4A51X70	06460-4A52X70	1/2-13	2.76	.75	1.06	1.08	1.69	.39	1.06	2.48	2.66	3.74	4.29	.51	24
06460-4A51X80	06460-4A52X80	1/2-13	3.15	.75	1.06	1.08	1.69	.39	1.06	2.48	2.66	3.74	4.29	.51	24
06460-4A51X90	06460-4A52X90	1/2-13	3.54	.75	1.06	1.08	1.69	.39	1.06	2.48	2.66	3.74	4.29	.51	24
06460-5A51X25	06460-5A52X25	1/2-13	.98	.91	1.22	1.26	1.93	.47	1.24	2.87	3.05	4.33	4.96	.59	26
06460-5A51X30	06460-5A52X30	1/2-13	1.18	.91	1.22	1.26	1.93	.47	1.24	2.87	3.05	4.33	4.96	.59	26
06460-5A51X35	06460-5A52X35	1/2-13	1.38	.91	1.22	1.26	1.93	.47	1.24	2.87	3.05	4.33	4.96	.59	26
06460-5A51X40	06460-5A52X40	1/2-13	1.57	.91	1.22	1.26	1.93	.47	1.24	2.87	3.05	4.33	4.96	.59	26
06460-5A51X45	06460-5A52X45	1/2-13	1.77	.91	1.22	1.26	1.93	.47	1.24	2.87	3.05	4.33	4.96	.59	26
06460-5A51X50	06460-5A52X50	1/2-13	1.97	.91	1.22	1.26	1.93	.47	1.24	2.87	3.05	4.33	4.96	.59	26
06460-5A51X55	06460-5A52X55	1/2-13	2.17	.91	1.22	1.26	1.93	.47	1.24	2.87	3.05	4.33	4.96	.59	26
06460-5A51X60	06460-5A52X60	1/2-13	2.36	.91	1.22	1.26	1.93	.47	1.24	2.87	3.05	4.33	4.96	.59	26
06460-5A51X70	06460-5A52X70	1/2-13	2.76	.91	1.22	1.26	1.93	.47	1.24	2.87	3.05	4.33	4.96	.59	26
06460-5A51X80	06460-5A52X80	1/2-13	3.15	.91	1.22	1.26	1.93	.47	1.24	2.87	3.05	4.33	4.96	.59	26
06460-5A51X90	06460-5A52X90	1/2-13	3.54	.91	1.22	1.26	1.93	.47	1.24	2.87	3.05	4.33	4.96	.59	26
06460-5A61X25	06460-5A62X25	5/8-11	.98	.91	1.22	1.26	1.93	.47	1.24	2.87	3.05	4.33	4.96	.59	26
06460-5A61X30	06460-5A62X30	5/8-11	1.18	.91	1.22	1.26	1.93	.47	1.24	2.87	3.05	4.33	4.96	.59	26
06460-5A61X35	06460-5A62X35	5/8-11	1.38	.91	1.22	1.26	1.93	.47	1.24	2.87	3.05	4.33	4.96	.59	26
06460-5A61X40	06460-5A62X40	5/8-11	1.57	.91	1.22	1.26	1.93	.47	1.24	2.87	3.05	4.33	4.96	.59	26
06460-5A61X45	06460-5A62X45	5/8-11	1.77	.91	1.22	1.26	1.93	.47	1.24	2.87	3.05	4.33	4.96	.59	26
06460-5A61X50	06460-5A62X50	5/8-11	1.97	.91	1.22	1.26	1.93	.47	1.24	2.87	3.05	4.33	4.96	.59	26
06460-5A61X55	06460-5A62X55	5/8-11	2.17	.91	1.22	1.26	1.93	.47	1.24	2.87	3.05	4.33	4.96	.59	26
06460-5A61X60	06460-5A62X60	5/8-11	2.36	.91	1.22	1.26	1.93	.47	1.24	2.87	3.05	4.33	4.96	.59	26
06460-5A61X70	06460-5A62X70	5/8-11	2.76	.91	1.22	1.26	1.93	.47	1.24	2.87	3.05	4.33	4.96	.59	26
06460-5A61X80	06460-5A62X80	5/8-11	3.15	.91	1.22	1.26	1.93	.47	1.24	2.87	3.05	4.33	4.96	.59	26
06460-5A61X90	06460-5A62X90	5/8-11	3.54	.91	1.22	1.26	1.93	.47	1.24	2.87	3.05	4.33	4.96	.59	26

ADJUSTABLE CLAMP HANDLES

Zinc Die Cast | Male Threads | Steel Studs | Metric

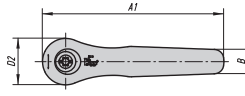
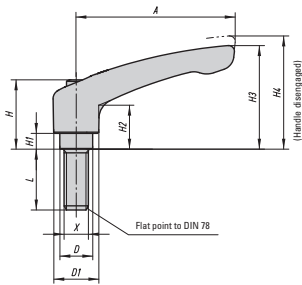

Pulling up on the handle disengages it from the spline and allows it to rotate freely for adjustment. Releasing the handle engages it for tightening or adjusting. The handle is made from zinc die cast and powder coated in either black satin or orange color finish. Internal parts and studs are made from steel with black oxide finish.

METRIC

Part # Black	Part # Orange	X Thread	L mm	D mm	D1 mm	D2 mm	H mm	H1 mm	H2 mm	H3 mm	H4 mm	A mm	A1 mm	B mm	No. Of Teeth
06460-0041X10	06460-0042X10	M4	10	10	13	14	24.5	4	14.5	30	33	30	37	7	16
06460-0041X15	06460-0042X15	M4	15	10	13	14	24.5	4	14.5	30	33	30	37	7	16
06460-0041X20	06460-0042X20	M4	20	10	13	14	24.5	4	14.5	30	33	30	37	7	16
06460-0041X25	06460-0042X25	M4	25	10	13	14	24.5	4	14.5	30	33	30	37	7	16
06460-0041X30	06460-0042X30	M4	30	10	13	14	24.5	4	14.5	30	33	30	37	7	16
06460-0041X35	06460-0042X35	M4	35	10	13	14	24.5	4	14.5	30	33	30	37	7	16
06460-0041X40	06460-0042X40	M4	40	10	13	14	24.5	4	14.5	30	33	30	37	7	16
06460-0041X45	06460-0042X45	M4	45	10	13	14	24.5	4	14.5	30	33	30	37	7	16
06460-0041X50	06460-0042X50	M4	50	10	13	14	24.5	4	14.5	30	33	30	37	7	16
06460-0051X10	06460-0052X10	M5	10	10	13	14	24.5	4	14.5	30	33	30	37	7	16
06460-0051X15	06460-0052X15	M5	15	10	13	14	24.5	4	14.5	30	33	30	37	7	16
06460-0051X20	06460-0052X20	M5	20	10	13	14	24.5	4	14.5	30	33	30	37	7	16
06460-0051X25	06460-0052X25	M5	25	10	13	14	24.5	4	14.5	30	33	30	37	7	16
06460-0051X30	06460-0052X30	M5	30	10	13	14	24.5	4	14.5	30	33	30	37	7	16
06460-0051X35	06460-0052X35	M5	35	10	13	14	24.5	4	14.5	30	33	30	37	7	16
06460-0051X40	06460-0052X40	M5	40	10	13	14	24.5	4	14.5	30	33	30	37	7	16
06460-0051X45	06460-0052X45	M5	45	10	13	14	24.5	4	14.5	30	33	30	37	7	16
06460-0051X50	06460-0052X50	M5	50	10	13	14	24.5	4	14.5	30	33	30	37	7	16
06460-1051X10	06460-1052X10	M5	10	10	13	14	24.5	4	14.5	31	34	40	47	7	16
06460-1051X15	06460-1052X15	M5	15	10	13	14	24.5	4	14.5	31	34	40	47	7	16
06460-1051X20	06460-1052X20	M5	20	10	13	14	24.5	4	14.5	31	34	40	47	7	16
06460-1051X25	06460-1052X25	M5	25	10	13	14	24.5	4	14.5	31	34	40	47	7	16
06460-1051X30	06460-1052X30	M5	30	10	13	14	24.5	4	14.5	31	34	40	47	7	16
06460-1051X35	06460-1052X35	M5	35	10	13	14	24.5	4	14.5	31	34	40	47	7	16
06460-1051X40	06460-1052X40	M5	40	10	13	14	24.5	4	14.5	31	34	40	47	7	16
06460-1051X45	06460-1052X45	M5	45	10	13	14	24.5	4	14.5	31	34	40	47	7	16
06460-1051X50	06460-1052X50	M5	50	10	13	14	24.5	4	14.5	31	34	40	47	7	16
06460-1061X10	06460-1062X10	M6	10	10	13	14	24.5	4	14.5	31	34	40	47	7	16
06460-1061X15	06460-1062X15	M6	15	10	13	14	24.5	4	14.5	31	34	40	47	7	16
06460-1061X20	06460-1062X20	M6	20	10	13	14	24.5	4	14.5	31	34	40	47	7	16
06460-1061X25	06460-1062X25	M6	25	10	13	14	24.5	4	14.5	31	34	40	47	7	16
06460-1061X30	06460-1062X30	M6	30	10	13	14	24.5	4	14.5	31	34	40	47	7	16
06460-1061X35	06460-1062X35	M6	35	10	13	14	24.5	4	14.5	31	34	40	47	7	16
06460-1061X40	06460-1062X40	M6	40	10	13	14	24.5	4	14.5	31	34	40	47	7	16
06460-1061X45	06460-1062X45	M6	45	10	13	14	24.5	4	14.5	31	34	40	47	7	16
06460-1061X50	06460-1062X50	M6	50	10	13	14	24.5	4	14.5	31	34	40	47	7	16
06460-2061X15	06460-2062X15	M6	15	13.5	18.5	19	28.5	6.5	17.5	42.5	45.5	65	74.5	9.5	20
06460-2061X20	06460-2062X20	M6	20	13.5	18.5	19	28.5	6.5	17.5	42.5	45.5	65	74.5	9.5	20
06460-2061X25	06460-2062X25	M6	25	13.5	18.5	19	28.5	6.5	17.5	42.5	45.5	65	74.5	9.5	20
06460-2061X30	06460-2062X30	M6	30	13.5	18.5	19	28.5	6.5	17.5	42.5	45.5	65	74.5	9.5	20
06460-2061X35	06460-2062X35	M6	35	13.5	18.5	19	28.5	6.5	17.5	42.5	45.5	65	74.5	9.5	20
06460-2061X40	06460-2062X40	M6	40	13.5	18.5	19	28.5	6.5	17.5	42.5	45.5	65	74.5	9.5	20
06460-2061X45	06460-2062X45	M6	45	13.5	18.5	19	28.5	6.5	17.5	42.5	45.5	65	74.5	9.5	20
06460-2061X50	06460-2062X50	M6	50	13.5	18.5	19	28.5	6.5	17.5	42.5	45.5	65	74.5	9.5	20
06460-2061X55	06460-2062X55	M6	55	13.5	18.5	19	28.5	6.5	17.5	42.5	45.5	65	74.5	9.5	20
06460-2061X60	06460-2062X60	M6	60	13.5	18.5	19	28.5	6.5	17.5	42.5	45.5	65	74.5	9.5	20

ADJUSTABLE CLAMP HANDLES

Zinc Die Cast | Male Threads | Steel Studs | Metric (continued)

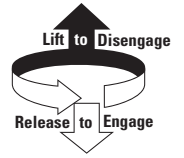
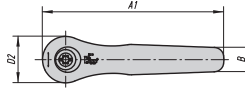
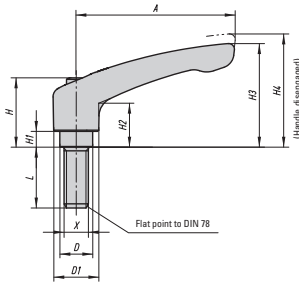

METRIC (CONTINUED)

Part # Black	Part # Orange	X Thread	L mm	D mm	D1 mm	D2 mm	H mm	H1 mm	H2 mm	H3 mm	H4 mm	A mm	A1 mm	B mm	No. Of Teeth
06460-2081X15	06460-2082X15	M8	15	13.5	18.5	19	28.5	6.5	17.5	42.5	45.5	65	74.5	9.5	20
06460-2081X20	06460-2082X20	M8	20	13.5	18.5	19	28.5	6.5	17.5	42.5	45.5	65	74.5	9.5	20
06460-2081X25	06460-2082X25	M8	25	13.5	18.5	19	28.5	6.5	17.5	42.5	45.5	65	74.5	9.5	20
06460-2081X30	06460-2082X30	M8	30	13.5	18.5	19	28.5	6.5	17.5	42.5	45.5	65	74.5	9.5	20
06460-2081X35	06460-2082X35	M8	35	13.5	18.5	19	28.5	6.5	17.5	42.5	45.5	65	74.5	9.5	20
06460-2081X40	06460-2082X40	M8	40	13.5	18.5	19	28.5	6.5	17.5	42.5	45.5	65	74.5	9.5	20
06460-2081X45	06460-2082X45	M8	45	13.5	18.5	19	28.5	6.5	17.5	42.5	45.5	65	74.5	9.5	20
06460-2081X50	06460-2082X50	M8	50	13.5	18.5	19	28.5	6.5	17.5	42.5	45.5	65	74.5	9.5	20
06460-2081X55	06460-2082X55	M8	55	13.5	18.5	19	28.5	6.5	17.5	42.5	45.5	65	74.5	9.5	20
06460-2081X60	06460-2082X60	M8	60	13.5	18.5	19	28.5	6.5	17.5	42.5	45.5	65	74.5	9.5	20
06460-2101X15	06460-2102X15	M10	15	13.5	18.5	19	28.5	6.5	17.5	42.5	45.5	65	74.5	9.5	20
06460-2101X20	06460-2102X20	M10	20	13.5	18.5	19	28.5	6.5	17.5	42.5	45.5	65	74.5	9.5	20
06460-2101X25	06460-2102X25	M10	25	13.5	18.5	19	28.5	6.5	17.5	42.5	45.5	65	74.5	9.5	20
06460-2101X30	06460-2102X30	M10	30	13.5	18.5	19	28.5	6.5	17.5	42.5	45.5	65	74.5	9.5	20
06460-2101X35	06460-2102X35	M10	35	13.5	18.5	19	28.5	6.5	17.5	42.5	45.5	65	74.5	9.5	20
06460-2101X40	06460-2102X40	M10	40	13.5	18.5	19	28.5	6.5	17.5	42.5	45.5	65	74.5	9.5	20
06460-2101X45	06460-2102X45	M10	45	13.5	18.5	19	28.5	6.5	17.5	42.5	45.5	65	74.5	9.5	20
06460-2101X50	06460-2102X50	M10	50	13.5	18.5	19	28.5	6.5	17.5	42.5	45.5	65	74.5	9.5	20
06460-2101X55	06460-2102X55	M10	55	13.5	18.5	19	28.5	6.5	17.5	42.5	45.5	65	74.5	9.5	20
06460-2101X60	06460-2102X60	M10	60	13.5	18.5	19	28.5	6.5	17.5	42.5	45.5	65	74.5	9.5	20
06460-3081X15	06460-3082X15	M8	15	16	21	22	37	10	24	54.5	58.5	80	91	11	22
06460-3081X20	06460-3082X20	M8	20	16	21	22	37	10	24	54.5	58.5	80	91	11	22
06460-3081X25	06460-3082X25	M8	25	16	21	22	37	10	24	54.5	58.5	80	91	11	22
06460-3081X30	06460-3082X30	M8	30	16	21	22	37	10	24	54.5	58.5	80	91	11	22
06460-3081X35	06460-3082X35	M8	35	16	21	22	37	10	24	54.5	58.5	80	91	11	22
06460-3081X40	06460-3082X40	M8	40	16	21	22	37	10	24	54.5	58.5	80	91	11	22
06460-3081X45	06460-3082X45	M8	45	16	21	22	37	10	24	54.5	58.5	80	91	11	22
06460-3081X50	06460-3082X50	M8	50	16	21	22	37	10	24	54.5	58.5	80	91	11	22
06460-3081X55	06460-3082X55	M8	55	16	21	22	37	10	24	54.5	58.5	80	91	11	22
06460-3081X60	06460-3082X60	M8	60	16	21	22	37	10	24	54.5	58.5	80	91	11	22
06460-3101X15	06460-3102X15	M10	15	16	21	22	37	10	24	54.5	58.5	80	91	11	22
06460-3101X20	06460-3102X20	M10	20	16	21	22	37	10	24	54.5	58.5	80	91	11	22
06460-3101X25	06460-3102X25	M10	25	16	21	22	37	10	24	54.5	58.5	80	91	11	22
06460-3101X30	06460-3102X30	M10	30	16	21	22	37	10	24	54.5	58.5	80	91	11	22
06460-3101X35	06460-3102X35	M10	35	16	21	22	37	10	24	54.5	58.5	80	91	11	22
06460-3101X40	06460-3102X40	M10	40	16	21	22	37	10	24	54.5	58.5	80	91	11	22
06460-3101X45	06460-3102X45	M10	45	16	21	22	37	10	24	54.5	58.5	80	91	11	22
06460-3101X50	06460-3102X50	M10	50	16	21	22	37	10	24	54.5	58.5	80	91	11	22
06460-3101X55	06460-3102X55	M10	55	16	21	22	37	10	24	54.5	58.5	80	91	11	22
06460-3101X60	06460-3102X60	M10	60	16	21	22	37	10	24	54.5	58.5	80	91	11	22
06460-4101X20	06460-4102X20	M10	20	19	27	27.5	43	10	27	63	67.5	95	109	13	24
06460-4101X25	06460-4102X25	M10	25	19	27	27.5	43	10	27	63	67.5	95	109	13	24
06460-4101X30	06460-4102X30	M10	30	19	27	27.5	43	10	27	63	67.5	95	109	13	24
06460-4101X35	06460-4102X35	M10	35	19	27	27.5	43	10	27	63	67.5	95	109	13	24
06460-4101X40	06460-4102X40	M10	40	19	27	27.5	43	10	27	63	67.5	95	109	13	24
06460-4101X45	06460-4102X45	M10	45	19	27	27.5	43	10	27	63	67.5	95	109	13	24
06460-4101X50	06460-4102X50	M10	50	19	27	27.5	43	10	27	63	67.5	95	109	13	24
06460-4101X55	06460-4102X55	M10	55	19	27	27.5	43	10	27	63	67.5	95	109	13	24
06460-4101X60	06460-4102X60	M10	60	19	27	27.5	43	10	27	63	67.5	95	109	13	24
06460-4101X70	06460-4102X70	M10	70	19	27	27.5	43	10	27	63	67.5	95	109	13	24
06460-4101X80	06460-4102X80	M10	80	19	27	27.5	43	10	27	63	67.5	95	109	13	24
06460-4101X90	06460-4102X90	M10	90	19	27	27.5	43	10	27	63	67.5	95	109	13	24

ADJUSTABLE CLAMP HANDLES

Zinc Die Cast | Male Threads | Steel Studs | Metric (continued)

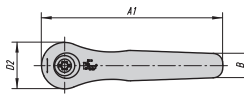
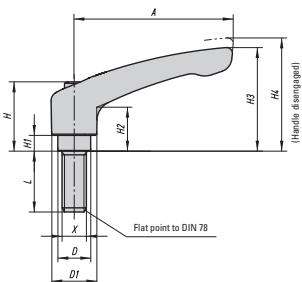

METRIC (CONTINUED)

Part # Black	Part # Orange	X Thread	L mm	D mm	D1 mm	D2 mm	H mm	H1 mm	H2 mm	H3 mm	H4 mm	A mm	A1 mm	B mm	No. Of Teeth
06460-4121X20	60460-4122X20	M12	20	19	27	27.5	43	10	27	63	67.5	95	109	13	24
06460-4121X25	60460-4122X25	M12	25	19	27	27.5	43	10	27	63	67.5	95	109	13	24
06460-4121X30	60460-4122X30	M12	30	19	27	27.5	43	10	27	63	67.5	95	109	13	24
06460-4121X35	60460-4122X35	M12	35	19	27	27.5	43	10	27	63	67.5	95	109	13	24
06460-4121X40	60460-4122X40	M12	40	19	27	27.5	43	10	27	63	67.5	95	109	13	24
06460-4121X45	60460-4122X45	M12	45	19	27	27.5	43	10	27	63	67.5	95	109	13	24
06460-4121X50	60460-4122X50	M12	50	19	27	27.5	43	10	27	63	67.5	95	109	13	24
06460-4121X55	60460-4122X55	M12	55	19	27	27.5	43	10	27	63	67.5	95	109	13	24
06460-4121X60	60460-4122X60	M12	60	19	27	27.5	43	10	27	63	67.5	95	109	13	24
06460-4121X70	60460-4122X70	M12	70	19	27	27.5	43	10	27	63	67.5	95	109	13	24
06460-4121X80	60460-4122X80	M12	80	19	27	27.5	43	10	27	63	67.5	95	109	13	24
06460-4121X90	60460-4122X90	M12	90	19	27	27.5	43	10	27	63	67.5	95	109	13	24
06460-5121X25	06460-5122X25	M12	25	23	31	32	49	12	31.5	73	77.5	110	126	15	26
06460-5121X30	06460-5122X30	M12	30	23	31	32	49	12	31.5	73	77.5	110	126	15	26
06460-5121X35	06460-5122X35	M12	35	23	31	32	49	12	31.5	73	77.5	110	126	15	26
06460-5121X40	06460-5122X40	M12	40	23	31	32	49	12	31.5	73	77.5	110	126	15	26
06460-5121X45	06460-5122X45	M12	45	23	31	32	49	12	31.5	73	77.5	110	126	15	26
06460-5121X50	06460-5122X50	M12	50	23	31	32	49	12	31.5	73	77.5	110	126	15	26
06460-5121X55	06460-5122X55	M12	55	23	31	32	49	12	31.5	73	77.5	110	126	15	26
06460-5121X60	06460-5122X60	M12	60	23	31	32	49	12	31.5	73	77.5	110	126	15	26
06460-5121X70	06460-5122X70	M12	70	23	31	32	49	12	31.5	73	77.5	110	126	15	26
06460-5121X80	06460-5122X80	M12	80	23	31	32	49	12	31.5	73	77.5	110	126	15	26
06460-5121X90	06460-5122X90	M12	90	23	31	32	49	12	31.5	73	77.5	110	126	15	26
06460-5161X25	06460-5162X25	M16	25	23	31	32	49	12	31.5	73	77.5	110	126	15	26
06460-5161X30	06460-5162X30	M16	30	23	31	32	49	12	31.5	73	77.5	110	126	15	26
06460-5161X35	06460-5162X35	M16	35	23	31	32	49	12	31.5	73	77.5	110	126	15	26
06460-5161X40	06460-5162X40	M16	40	23	31	32	49	12	31.5	73	77.5	110	126	15	26
06460-5161X45	06460-5162X45	M16	45	23	31	32	49	12	31.5	73	77.5	110	126	15	26
06460-5161X50	06460-5162X50	M16	50	23	31	32	49	12	31.5	73	77.5	110	126	15	26
06460-5161X55	06460-5162X55	M16	55	23	31	32	49	12	31.5	73	77.5	110	126	15	26
06460-5161X60	06460-5162X60	M16	60	23	31	32	49	12	31.5	73	77.5	110	126	15	26
06460-5161X70	06460-5162X70	M16	70	23	31	32	49	12	31.5	73	77.5	110	126	15	26
06460-5161X80	06460-5162X80	M16	80	23	31	32	49	12	31.5	73	77.5	110	126	15	26
06460-5161X90	06460-5162X90	M16	90	23	31	32	49	12	31.5	73	77.5	110	126	15	26

ADJUSTABLE CLAMP HANDLES

Zinc Die Cast | Male Threads | Stainless Steel Studs | Inch

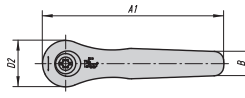
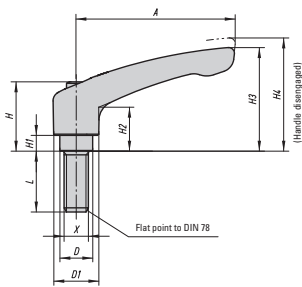

Pulling up on the handle disengages it from the spline and allows it to rotate freely for adjustment. Releasing the handle engages it for tightening or adjusting. The handle is made from zinc die cast and powder coated in either black satin or orange color finish. Internal parts and studs are made from stainless steel.

INCH

Part # Black	Part # Orange	X Thread	L	D	D1	D2	H	H1	H2	H3	H4	A	A1	B	No. Of Teeth
06461-0A01X10	06461-0A02X10	10-24	.39	.39	.51	.55	.96	.16	.57	1.18	1.30	1.18	1.46	.28	16
06461-0A01X15	06461-0A02X15	10-24	.59	.39	.51	.55	.96	.16	.57	1.18	1.30	1.18	1.46	.28	16
06461-0A01X20	06461-0A02X20	10-24	.79	.39	.51	.55	.96	.16	.57	1.18	1.30	1.18	1.46	.28	16
06461-0A01X25	06461-0A02X25	10-24	.98	.39	.51	.55	.96	.16	.57	1.18	1.30	1.18	1.46	.28	16
06461-0A11X15	06461-0A12X15	10-32	.59	.39	.51	.55	.96	.16	.57	1.18	1.30	1.18	1.46	.28	16
06461-0A11X20	06461-0A12X20	10-32	.79	.39	.51	.55	.96	.16	.57	1.18	1.30	1.18	1.46	.28	16
06461-0A11X25	06461-0A12X25	10-32	.98	.39	.51	.55	.96	.16	.57	1.18	1.30	1.18	1.46	.28	16
06461-0A21X10	06461-0A22X10	1/4-20	.39	.39	.51	.55	.96	.16	.57	1.18	1.30	1.18	1.46	.28	16
06461-0A21X15	06461-0A22X15	1/4-20	.59	.39	.51	.55	.96	.16	.57	1.18	1.30	1.18	1.46	.28	16
06461-0A21X20	06461-0A22X20	1/4-20	.79	.39	.51	.55	.96	.16	.57	1.18	1.30	1.18	1.46	.28	16
06461-0A21X25	06461-0A22X25	1/4-20	.98	.39	.51	.55	.96	.16	.57	1.18	1.30	1.18	1.46	.28	16
06461-0A21X30	06461-0A22X30	1/4-20	1.18	.39	.51	.55	.96	.16	.57	1.18	1.30	1.18	1.46	.28	16
06461-0A21X40	06461-0A22X40	1/4-20	1.57	.39	.51	.55	.96	.16	.57	1.18	1.30	1.18	1.46	.28	16
06461-0A21X50	06461-0A22X50	1/4-20	1.97	.39	.51	.55	.96	.16	.57	1.18	1.30	1.18	1.46	.28	16
06461-1A01X15	06461-1A02X15	10-24	.59	.39	.51	.55	.96	.16	.57	1.22	1.34	1.57	1.85	.28	16
06461-1A01X20	06461-1A02X20	10-24	.79	.39	.51	.55	.96	.16	.57	1.22	1.34	1.57	1.85	.28	16
06461-1A01X25	06461-1A02X25	10-24	.98	.39	.51	.55	.96	.16	.57	1.22	1.34	1.57	1.85	.28	16
06461-1A11X15	06461-1A12X15	10-32	.59	.39	.51	.55	.96	.16	.57	1.22	1.34	1.57	1.85	.28	16
06461-1A11X20	06461-1A12X20	10-32	.79	.39	.51	.55	.96	.16	.57	1.22	1.34	1.57	1.85	.28	16
06461-1A11X25	06461-1A12X25	10-32	.98	.39	.51	.55	.96	.16	.57	1.22	1.34	1.57	1.85	.28	16
06461-1A21X10	06461-1A22X10	1/4-20	.39	.39	.51	.55	.96	.16	.57	1.22	1.34	1.57	1.85	.28	16
06461-1A21X15	06461-1A22X15	1/4-20	.59	.39	.51	.55	.96	.16	.57	1.22	1.34	1.57	1.85	.28	16
06461-1A21X20	06461-1A22X20	1/4-20	.79	.39	.51	.55	.96	.16	.57	1.22	1.34	1.57	1.85	.28	16
06461-1A21X25	06461-1A22X25	1/4-20	.98	.39	.51	.55	.96	.16	.57	1.22	1.34	1.57	1.85	.28	16
06461-1A21X30	06461-1A22X30	1/4-20	1.18	.39	.51	.55	.96	.16	.57	1.22	1.34	1.57	1.85	.28	16
06461-1A21X40	06461-1A22X40	1/4-20	1.57	.39	.51	.55	.96	.16	.57	1.22	1.34	1.57	1.85	.28	16
06461-1A21X50	06461-1A22X50	1/4-20	1.97	.39	.51	.55	.96	.16	.57	1.22	1.34	1.57	1.85	.28	16
06461-2A21X15	06461-2A22X15	1/4-20	.59	.53	.73	.75	1.12	.26	.69	1.67	1.79	2.56	2.93	.37	20
06461-2A21X20	06461-2A22X20	1/4-20	.79	.53	.73	.75	1.12	.26	.69	1.67	1.79	2.56	2.93	.37	20
06461-2A21X25	06461-2A22X25	1/4-20	.98	.53	.73	.75	1.12	.26	.69	1.67	1.79	2.56	2.93	.37	20
06461-2A21X30	06461-2A22X30	1/4-20	1.18	.53	.73	.75	1.12	.26	.69	1.67	1.79	2.56	2.93	.37	20
06461-2A21X40	06461-2A22X40	1/4-20	1.57	.53	.73	.75	1.12	.26	.69	1.67	1.79	2.56	2.93	.37	20
06461-2A21X50	06461-2A22X50	1/4-20	1.97	.53	.73	.75	1.12	.26	.69	1.67	1.79	2.56	2.93	.37	20
06461-2A21X60	06461-2A22X60	1/4-20	2.36	.53	.73	.75	1.12	.26	.69	1.67	1.79	2.56	2.93	.37	20
06461-2A31X15	06461-2A32X15	5/16-18	.59	.53	.73	.75	1.12	.26	.69	1.67	1.79	2.56	2.93	.37	20
06461-2A31X20	06461-2A32X20	5/16-18	.79	.53	.73	.75	1.12	.26	.69	1.67	1.79	2.56	2.93	.37	20
06461-2A31X25	06461-2A32X25	5/16-18	.98	.53	.73	.75	1.12	.26	.69	1.67	1.79	2.56	2.93	.37	20
06461-2A31X30	06461-2A32X30	5/16-18	1.18	.53	.73	.75	1.12	.26	.69	1.67	1.79	2.56	2.93	.37	20
06461-2A31X40	06461-2A32X40	5/16-18	1.57	.53	.73	.75	1.12	.26	.69	1.67	1.79	2.56	2.93	.37	20
06461-2A31X50	06461-2A32X50	5/16-18	1.97	.53	.73	.75	1.12	.26	.69	1.67	1.79	2.56	2.93	.37	20
06461-2A31X60	06461-2A32X60	5/16-18	2.36	.53	.73	.75	1.12	.26	.69	1.67	1.79	2.56	2.93	.37	20

ADJUSTABLE CLAMP HANDLES

Zinc Die Cast | Male Threads | Stainless Steel Studs | Inch (continued)

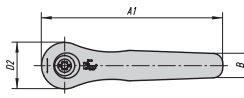
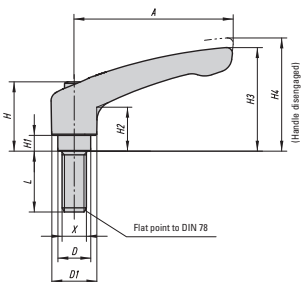

INCH (CONTINUED)

Part # Black	Part # Orange	X Thread	L	D	D1	D2	H	H1	H2	H3	H4	A	A1	B	No. Of Teeth
06461-2A41X20	06461-2A42X20	3/8-16	.79	.53	.73	.75	1.12	.26	.69	1.67	1.79	2.56	2.93	.37	20
06461-2A41X25	06461-2A42X25	3/8-16	.98	.53	.73	.75	1.12	.26	.69	1.67	1.79	2.56	2.93	.37	20
06461-2A41X30	06461-2A42X30	3/8-16	1.18	.53	.73	.75	1.12	.26	.69	1.67	1.79	2.56	2.93	.37	20
06461-2A41X40	06461-2A42X40	3/8-16	1.57	.53	.73	.75	1.12	.26	.69	1.67	1.79	2.56	2.93	.37	20
06461-2A41X50	06461-2A42X50	3/8-16	1.97	.53	.73	.75	1.12	.26	.69	1.67	1.79	2.56	2.93	.37	20
06461-2A41X60	06461-2A42X60	3/8-16	2.36	.53	.73	.75	1.12	.26	.69	1.67	1.79	2.56	2.93	.37	20
06461-3A31X20	06461-3A32X20	5/16-18	.79	.63	.83	.87	1.46	.39	.94	2.15	2.30	3.15	3.58	.43	22
06461-3A31X25	06461-3A32X25	5/16-18	.98	.63	.83	.87	1.46	.39	.94	2.15	2.30	3.15	3.58	.43	22
06461-3A31X30	06461-3A32X30	5/16-18	1.18	.63	.83	.87	1.46	.39	.94	2.15	2.30	3.15	3.58	.43	22
06461-3A31X40	06461-3A32X40	5/16-18	1.57	.63	.83	.87	1.46	.39	.94	2.15	2.30	3.15	3.58	.43	22
06461-3A31X50	06461-3A32X50	5/16-18	1.97	.63	.83	.87	1.46	.39	.94	2.15	2.30	3.15	3.58	.43	22
06461-3A31X60	06461-3A32X60	5/16-18	2.36	.63	.83	.87	1.46	.39	.94	2.15	2.30	3.15	3.58	.43	22
06461-3A41X20	06461-3A42X20	3/8-16	.79	.63	.83	.87	1.46	.39	.94	2.15	2.30	3.15	3.58	.43	22
06461-3A41X25	06461-3A42X25	3/8-16	.98	.63	.83	.87	1.46	.39	.94	2.15	2.30	3.15	3.58	.43	22
06461-3A41X30	06461-3A42X30	3/8-16	1.18	.63	.83	.87	1.46	.39	.94	2.15	2.30	3.15	3.58	.43	22
06461-3A41X40	06461-3A42X40	3/8-16	1.57	.63	.83	.87	1.46	.39	.94	2.15	2.30	3.15	3.58	.43	22
06461-3A41X50	06461-3A42X50	3/8-16	1.97	.63	.83	.87	1.46	.39	.94	2.15	2.30	3.15	3.58	.43	22
06461-3A41X60	06461-3A42X60	3/8-16	2.36	.63	.83	.87	1.46	.39	.94	2.15	2.30	3.15	3.58	.43	22
06461-4A51X25	06461-4A52X25	1/2-13	.98	.75	1.06	1.08	1.69	.39	1.06	2.48	2.66	3.74	4.29	.51	24
06461-4A51X30	06461-4A52X30	1/2-13	1.18	.75	1.06	1.08	1.69	.39	1.06	2.48	2.66	3.74	4.29	.51	24
06461-4A51X40	06461-4A52X40	1/2-13	1.57	.75	1.06	1.08	1.69	.39	1.06	2.48	2.66	3.74	4.29	.51	24
06461-4A51X50	06461-4A52X50	1/2-13	1.97	.75	1.06	1.08	1.69	.39	1.06	2.48	2.66	3.74	4.29	.51	24
06461-4A51X60	06461-4A52X60	1/2-13	2.36	.75	1.06	1.08	1.69	.39	1.06	2.48	2.66	3.74	4.29	.51	24
06461-5A61X30	06461-5A62X30	5/8-11	1.18	.91	1.22	1.26	1.93	.47	1.24	2.87	3.05	4.33	4.96	.59	26
06461-5A61X40	06461-5A62X40	5/8-11	1.57	.91	1.22	1.26	1.93	.47	1.24	2.87	3.05	4.33	4.96	.59	26
06461-5A61X50	06461-5A62X50	5/8-11	1.97	.91	1.22	1.26	1.93	.47	1.24	2.87	3.05	4.33	4.96	.59	26
06461-5A61X60	06461-5A62X60	5/8-11	2.36	.91	1.22	1.26	1.93	.47	1.24	2.87	3.05	4.33	4.96	.59	26

ADJUSTABLE CLAMP HANDLES

Zinc Die Cast | Male Threads | Stainless Steel Studs | Metric

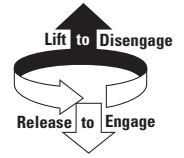
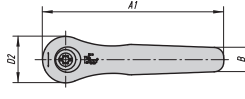
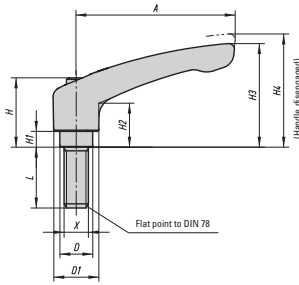

Pulling up on the handle disengages it from the spline and allows it to rotate freely for adjustment. Releasing the handle engages it for tightening or adjusting. The handle is made from zinc die cast and powder coated in either black satin or orange color finish. Internal parts and studs are made from stainless steel.

METRIC

Part # Black	Part # Orange	X Thread	L mm	D mm	D1 mm	D2 mm	H mm	H1 mm	H2 mm	H3 mm	H4 mm	A mm	A1 mm	B mm	No. Of Teeth
06461-0041X10	06461-0042X10	M4	10	10	13	14	24.5	4	14.5	30	33	30	37	7	16
06461-0041X15	06461-0042X15	M4	15	10	13	14	24.5	4	14.5	30	33	30	37	7	16
06461-0041X20	06461-0042X20	M4	20	10	13	14	24.5	4	14.5	30	33	30	37	7	16
06461-0041X25	06461-0042X25	M4	25	10	13	14	24.5	4	14.5	30	33	30	37	7	16
06461-0051X10	06461-0052X10	M5	10	10	13	14	24.5	4	14.5	30	33	30	37	7	16
06461-0051X15	06461-0052X15	M5	15	10	13	14	24.5	4	14.5	30	33	30	37	7	16
06461-0051X20	06461-0052X20	M5	20	10	13	14	24.5	4	14.5	30	33	30	37	7	16
06461-0051X25	06461-0052X25	M5	25	10	13	14	24.5	4	14.5	30	33	30	37	7	16
06461-1051X15	06461-1052X15	M5	15	10	13	14	24.5	4	14.5	31	34	40	47	7	16
06461-1051X20	06461-1052X20	M5	20	10	13	14	24.5	4	14.5	31	34	40	47	7	16
06461-1051X25	06461-1052X25	M5	25	10	13	14	24.5	4	14.5	31	34	40	47	7	16
06461-1061X10	06461-1062X10	M6	10	10	13	14	24.5	4	14.5	31	34	40	47	7	16
06461-1061X15	06461-1062X15	M6	15	10	13	14	24.5	4	14.5	31	34	40	47	7	16
06461-1061X20	06461-1062X20	M6	20	10	13	14	24.5	4	14.5	31	34	40	47	7	16
06461-1061X25	06461-1062X25	M6	25	10	13	14	24.5	4	14.5	31	34	40	47	7	16
06461-1061X30	06461-1062X30	M6	30	10	13	14	24.5	4	14.5	31	34	40	47	7	16
06461-1061X40	06461-1062X40	M6	40	10	13	14	24.5	4	14.5	31	34	40	47	7	16
06461-1061X50	06461-1062X50	M6	50	10	13	14	24.5	4	14.5	31	34	40	47	7	16
06461-2061X15	06461-2062X15	M6	15	13.5	18.5	19	28.5	6.5	17.5	42.5	45.5	65	74.5	9.5	20
06461-2061X20	06461-2062X20	M6	20	13.5	18.5	19	28.5	6.5	17.5	42.5	45.5	65	74.5	9.5	20
06461-2061X25	06461-2062X25	M6	25	13.5	18.5	19	28.5	6.5	17.5	42.5	45.5	65	74.5	9.5	20
06461-2061X30	06461-2062X30	M6	30	13.5	18.5	19	28.5	6.5	17.5	42.5	45.5	65	74.5	9.5	20
06461-2061X40	06461-2062X40	M6	40	13.5	18.5	19	28.5	6.5	17.5	42.5	45.5	65	74.5	9.5	20
06461-2061X50	06461-2062X50	M6	50	13.5	18.5	19	28.5	6.5	17.5	42.5	45.5	65	74.5	9.5	20
06461-2061X60	06461-2062X60	M6	60	13.5	18.5	19	28.5	6.5	17.5	42.5	45.5	65	74.5	9.5	20
06461-2081X15	06461-2082X15	M8	15	13.5	18.5	19	28.5	6.5	17.5	42.5	45.5	65	74.5	9.5	20
06461-2081X20	06461-2082X20	M8	20	13.5	18.5	19	28.5	6.5	17.5	42.5	45.5	65	74.5	9.5	20
06461-2081X25	06461-2082X25	M8	25	13.5	18.5	19	28.5	6.5	17.5	42.5	45.5	65	74.5	9.5	20
06461-2081X30	06461-2082X30	M8	30	13.5	18.5	19	28.5	6.5	17.5	42.5	45.5	65	74.5	9.5	20
06461-2081X40	06461-2082X40	M8	40	13.5	18.5	19	28.5	6.5	17.5	42.5	45.5	65	74.5	9.5	20
06461-2081X50	06461-2082X50	M8	50	13.5	18.5	19	28.5	6.5	17.5	42.5	45.5	65	74.5	9.5	20
06461-2081X60	06461-2082X60	M8	60	13.5	18.5	19	28.5	6.5	17.5	42.5	45.5	65	74.5	9.5	20
06461-2101X20	06461-2102X20	M10	20	13.5	18.5	19	28.5	6.5	17.5	42.5	45.5	65	74.5	9.5	20
06461-2101X25	06461-2102X25	M10	25	13.5	18.5	19	28.5	6.5	17.5	42.5	45.5	65	74.5	9.5	20
06461-2101X30	06461-2102X30	M10	30	13.5	18.5	19	28.5	6.5	17.5	42.5	45.5	65	74.5	9.5	20
06461-2101X40	06461-2102X40	M10	40	13.5	18.5	19	28.5	6.5	17.5	42.5	45.5	65	74.5	9.5	20
06461-2101X50	06461-2102X50	M10	50	13.5	18.5	19	28.5	6.5	17.5	42.5	45.5	65	74.5	9.5	20
06461-2101X60	06461-2102X60	M10	60	13.5	18.5	19	28.5	6.5	17.5	42.5	45.5	65	74.5	9.5	20
06461-3081X20	06461-3082X20	M8	20	16	21	22	37	10	24	54.5	58.5	80	91	11	22
06461-3081X25	06461-3082X25	M8	25	16	21	22	37	10	24	54.5	58.5	80	91	11	22
06461-3081X30	06461-3082X30	M8	30	16	21	22	37	10	24	54.5	58.5	80	91	11	22
06461-3081X40	06461-3082X40	M8	40	16	21	22	37	10	24	54.5	58.5	80	91	11	22
06461-3081X50	06461-3082X50	M8	50	16	21	22	37	10	24	54.5	58.5	80	91	11	22
06461-3081X60	06461-3082X60	M8	60	16	21	22	37	10	24	54.5	58.5	80	91	11	22

ADJUSTABLE CLAMP HANDLES

Zinc Die Cast | Male Threads | Stainless Steel Studs | Metric (continued)

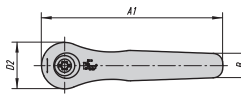
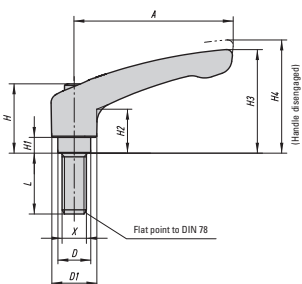

METRIC (CONTINUED)

Part # Black	Part # Orange	X Thread	L mm	D mm	D1 mm	D2 mm	H mm	H1 mm	H2 mm	H3 mm	H4 mm	A mm	A1 mm	B mm	No. Of Teeth
06461-3101X20	06461-3102X20	M10	20	16	21	22	37	10	24	54.5	58.5	80	91	11	22
06461-3101X25	06461-3102X25	M10	25	16	21	22	37	10	24	54.5	58.5	80	91	11	22
06461-3101X30	06461-3102X30	M10	30	16	21	22	37	10	24	54.5	58.5	80	91	11	22
06461-3101X40	06461-3102X40	M10	40	16	21	22	37	10	24	54.5	58.5	80	91	11	22
06461-3101X50	06461-3102X50	M10	50	16	21	22	37	10	24	54.5	58.5	80	91	11	22
06461-3101X60	06461-3102X60	M10	60	16	21	22	37	10	24	54.5	58.5	80	91	11	22
06461-4121X25	06461-4122X25	M12	25	19	27	27.5	43	10	27	63	67.5	95	109	13	24
06461-4121X30	06461-4122X30	M12	30	19	27	27.5	43	10	27	63	67.5	95	109	13	24
06461-4121X40	06461-4122X40	M12	40	19	27	27.5	43	10	27	63	67.5	95	109	13	24
06461-4121X50	06461-4122X50	M12	50	19	27	27.5	43	10	27	63	67.5	95	109	13	24
06461-4121X60	06461-4122X60	M12	60	19	27	27.5	43	10	27	63	67.5	95	109	13	24
06461-5161X30	06461-5162X30	M16	30	23	31	32	49	12	31.5	73	77.5	110	126	15	26
06461-5161X40	06461-5162X40	M16	40	23	31	32	49	12	31.5	73	77.5	110	126	15	26
06461-5161X50	06461-5162X50	M16	50	23	31	32	49	12	31.5	73	77.5	110	126	15	26
06461-5161X60	06461-5162X60	M16	60	23	31	32	49	12	31.5	73	77.5	110	126	15	26